

Jabra Talk 25



User manual

1. WELCOME	3
2. HEADSET OVERVIEW	4
3. HOW TO WEAR	5
3.1 CHANGE EARGELS	
3.2 ATTACHING THE EARHOOK	
4. HOW TO CHARGE THE BATTERY ..	7
5. HOW TO CONNECT	8
6. HOW TO USE	9
6.1 MULTIPLE CALL HANDLING	
7. JABRA ASSIST APP	12
8. SUPPORT	13
8.1 HOW TO CARE FOR YOUR HEADSET	

1. WELCOME

Thank you for using the Jabra Talk 25. We hope you will enjoy it!

JABRA TALK 25 FEATURES

- Clear HD calls (phone dependent) - omnidirectional microphone and a dynamic speaker
- Stream from your phone - music, podcasts and GPS directions
- Long lasting - up to 8 hours of calls, and up to 10 days of standby time

2. HEADSET OVERVIEW

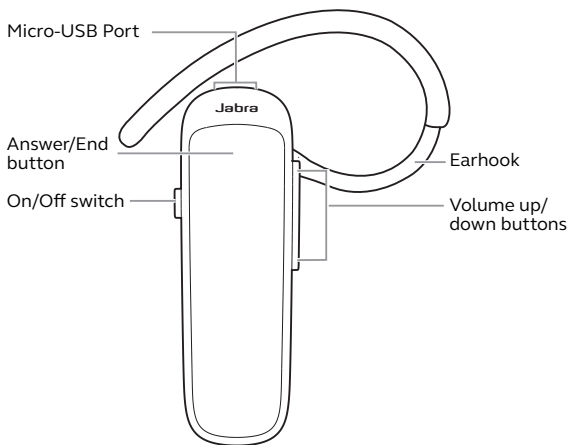

USB cable



Small earhook



Large earhook



Eargel



Looped Eargels

3. HOW TO WEAR

The headset can be worn on the left or right ear.



3.1 CHANGE EARGELS

Choose between 2 ergo-designed eargels for optimal fit and comfort.

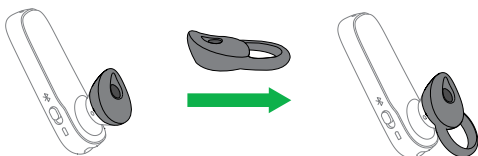

3.2 ATTACHING THE EARHOOK

The earhook can be attached to the headset for a more secure fit, and can be worn with or without the eargel.

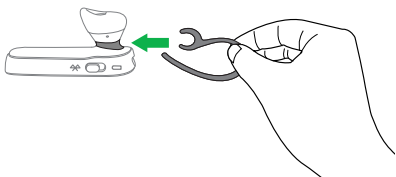

4. HOW TO CHARGE THE BATTERY

Plug the headset into any available USB port on your PC using the supplied USB cable.

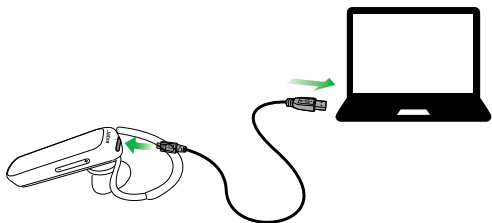

NOTE: For safety reasons, it is recommended not to use the headset while it is charging.

It takes approx. 2 hours to fully charge the headset.

5. HOW TO CONNECT

1. Turn the headset on (set the **On/off** switch to the On position).
2. Press and hold (3 secs) the **Answer/end** button until the Bluetooth indicator flashes blue, and pairing mode is announced in the headset.
3. Follow the voice-guided pairing instructions to pair to your Bluetooth device.

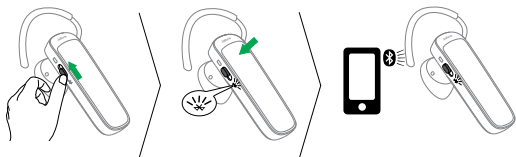

6. HOW TO USE

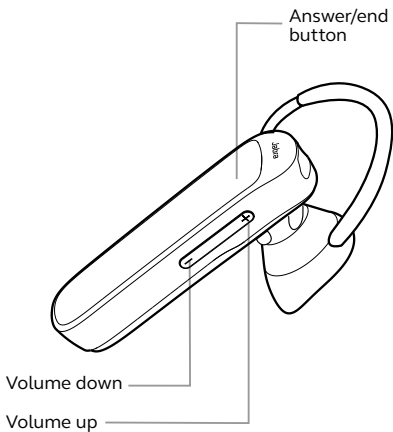
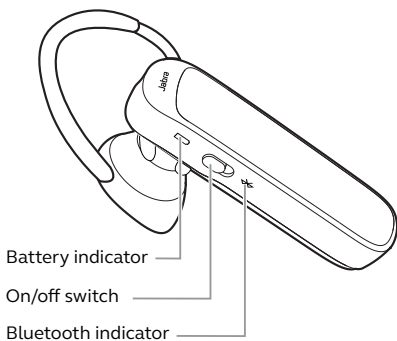

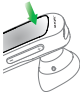
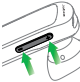
FUNCTION	ACTION
Answer call	Tap the Answer/end button
End call	Tap the Answer/end button
 Activate voice dialing (phone dependent)	Press and hold (2 secs) the Answer/end button when not on a call
Reject call	Double-tap the Answer/end button
Redial last number	Double-tap the Answer/end button when not on a call
 Adjust speaker volume	Tap the Volume up or Volume down button
Mute/un-mute microphone	Tap both the Volume up and Volume down to mute/un-mute.

6.1 MULTIPLE CALL HANDLING

The headset can accept and handle multiple calls simultaneously.

FUNCTION	ACTION
End current call and answer incoming call	Tap the Answer/end button
Switch between held call and active call	Press and hold (2 secs) the Answer/end button
Put current call on hold and answer incoming call	Press and hold (2 secs) the Answer/end button
Reject incoming call	Double-tap the Answer/end button



7. JABRA ASSIST APP



Jabra Assist app



Find my headset



Message readout



Help at your
fingertips



8. SUPPORT

8.1 HOW TO CARE FOR YOUR HEADSET

- Always store the headset with the power off and safely protected
- Avoid storage at extreme temperatures (above 35°C/95°F or below -20°C/-4°F). This can shorten battery life and may affect headset operation.
- Do not expose the headset to rain or other liquids

© 2018 GN Audio. All rights reserved. Jabra® is a registered trademark of GN Audio. The Bluetooth® word mark and logos are owned by the Bluetooth SIG, Inc. and any use of such marks by GN Audio is under license.

Made in China
MODEL: OTE15

 **Bluetooth®**

Declaration of Conformity can be found on
www.jabra.com/doc