

Go to [www.vtechphones.com](http://www.vtechphones.com) to register your product for enhanced warranty support and the latest VTech product news.

VM3252  
VM3252-2

Video Monitor



## Congratulations

on purchasing your new VTech product. Before using this product, please read **Important safety instructions**.

This manual has all the feature operations and troubleshooting necessary to install and operate your new VTech product. Please review this manual thoroughly to ensure proper installation and operation of this innovative and feature rich VTech product.

For support, shopping, and everything new at VTech, visit our website at [www.vtechphones.com](http://www.vtechphones.com).

## What's in the box

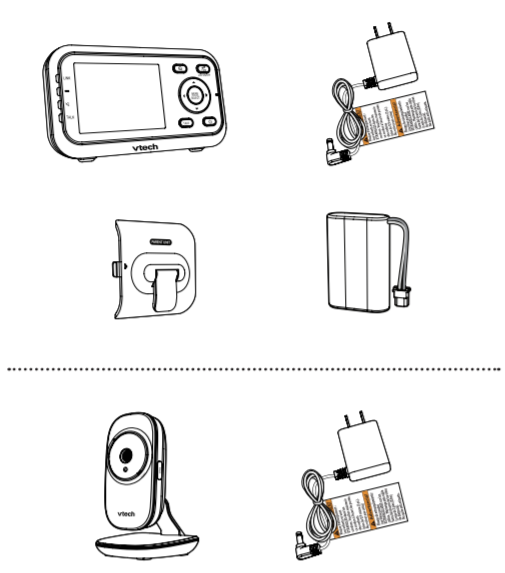

1 set for VM3252  
2 sets for VM3252-2



**vtech**<sup>®</sup>  
User's manual

## Install the battery

The parent unit runs on rechargeable battery or AC power. To continuously monitor your baby, make sure you use both battery and AC power at the same time. With the battery alone, the parent unit can cordlessly run for a short time only.

- NOTES**
- Use only the battery supplied with this product.
  - If the parent unit will not be used for a long time, disconnect and remove the battery to prevent possible leakage.

Install the battery as shown below.

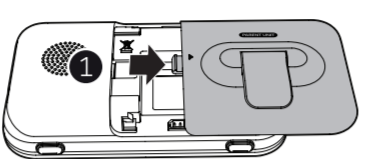

- NOTE**
- Press down on the battery compartment cover to pull it out.

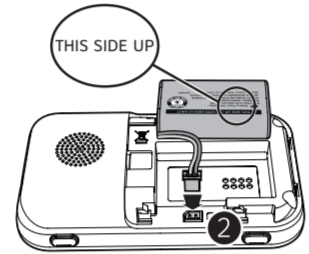

- NOTE**
- Make sure the label **THIS SIDE UP** is facing up while inserting the battery.

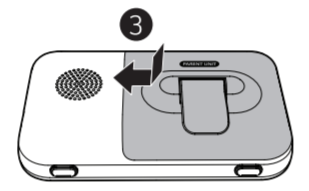

## Replace the battery

To replace the battery, pull out the battery compartment cover, and then lift up the battery. Follow the steps above to install the new battery.

## Connect and charge the battery

- NOTES**
- Use only the power adapters supplied with this product.
  - Make sure the electrical outlets are not controlled by wall switches.
  - The power adapters are intended to be correctly oriented in a vertical or floor mount position. The prongs are not designed to hold the plug in place if they are plugged into a ceiling, under-the-table or cabinet outlet.
  - Make sure the parent unit, the baby unit and the power adapter cords are out of reach of children.

## Connect the baby monitor

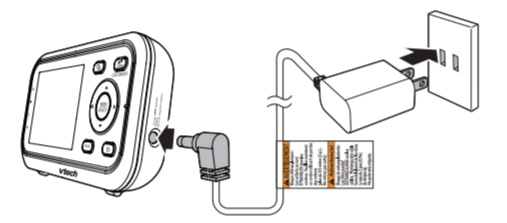
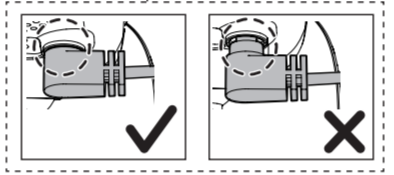
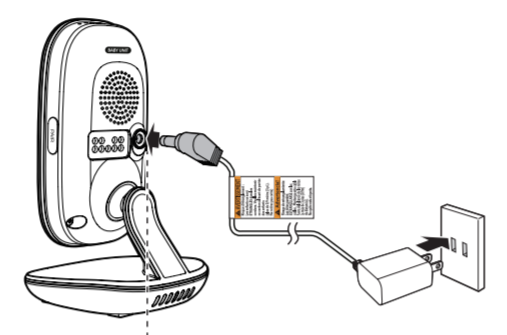

## Charge the parent unit battery

When you have connected the parent unit and installed its battery for the first time or after power outage, the parent unit powers on automatically. The battery icon indicates the battery status (see the following table).

- NOTES**
- The parent unit battery is fully charged after 11 hours of continuous charging.
  - It takes longer to charge the battery when the parent unit is turned on. To shorten the charging time, turn the parent unit off while charging.
  - The standby time varies depending on the volume level you set, your actual use and the age of the battery.

Battery indicators	Battery status	Action
The battery icon is off and  displays.	No battery is installed but operates using AC power, or the battery has been installed incorrectly.	Install the parent unit battery. Charge without interruption (at least 30 minutes).
The screen displays <b>Battery low at Parent Unit</b> and . The  light flashes.	The battery has very little charge and may be used for only a short time.	Charge without interruption (about 30 minutes).
The battery icon becomes solid .	The battery is fully charged.	To keep the battery charged, connect it to AC power when not in use.

## Before use

- NOTE**
- This baby monitor is intended as an aid. It is not a substitute for proper adult supervision, and should not be used as such.

## Test your baby monitor

You may test the baby monitor before initial use, and at regular times thereafter.

### CAUTION

- For hearing protection, make sure the parent unit is more than 3 feet (1 meter) away from both baby units. If you hear any high-pitched noise, move the parent unit further until the noise stops. You can also press **VOL-** on the parent unit to lower or mute the noise.

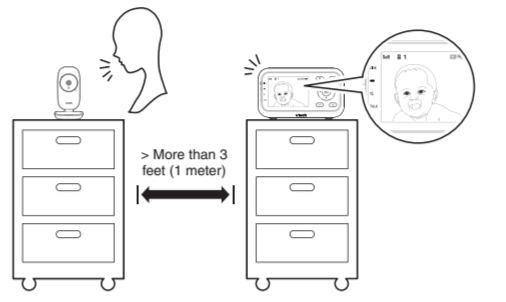

- Make sure your baby units and parent unit are on.
- The parent unit displays images from the baby unit.
  - Speak towards the microphone of the baby unit. You will hear the sound at the parent unit.
- If you have two baby units, press **CAM** at the right side of your parent unit. The screen switches to other baby unit. Then, repeat step 2.

- NOTE**
- When the parent unit displays **No link to Camera**, and the **LINK** LED light flashes, move the parent unit closer to the baby units (observe the minimum distance of 3 feet/ 1 meter). You can also check if the baby monitor is connected to a live power socket and switched on.

- TIP**
- Increase the speaker volume of the parent unit if you cannot hear the sounds transmitted from the baby units.

## Positioning the baby monitor

- CAUTION**
- Keep the baby unit out of the reach of your baby. Never place or mount the baby unit inside the baby's crib or playpen.

- NOTE**
- To avoid interference from other electronic devices, place your baby monitor far away from devices such as wireless routers, microwaves, cell phones and computers.

- Place the baby units more than 3 feet (1 meter) away from your baby.

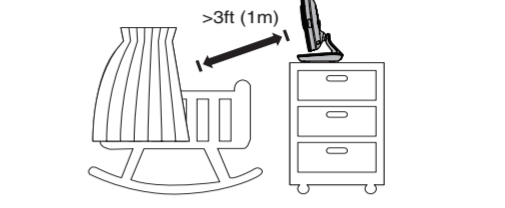

- Adjust the angle of the baby unit camera to aim at your baby.

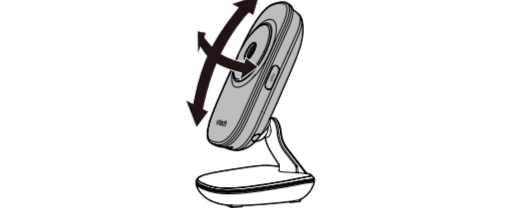

- Place the parent unit more than 3 feet (1 meter) away from the baby units.

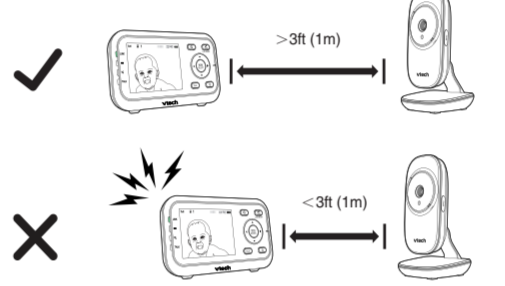

- CAUTION**
- The default volume of your parent unit is level 3, and the maximum volume is level 5. If you experience high-pitched screeching noise from your baby monitor while positioning:
    - Make sure your baby units and parent unit are more than 3 feet (1 meter) apart, OR
    - Turn down the volume of your parent unit.

## Operating range

The operating range of the baby monitor is up to 1,000 feet (300 meters) outdoors or 160 feet (50 meters) indoors. The actual operating range may vary depending on the environmental conditions and other interferences such as walls, doors and other obstructions.

## Overview

### Baby unit overview

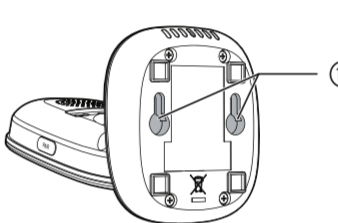
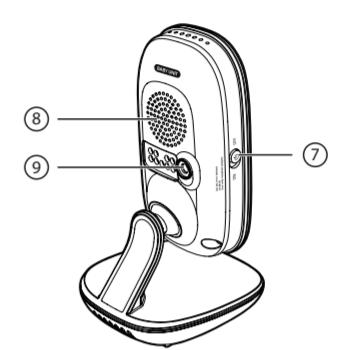
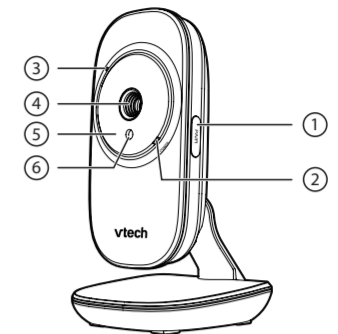

1	<b>PAIR</b> <ul style="list-style-type: none"> <li>Your baby units and parent unit provided are already paired.</li> </ul>
2	<b>POWER LED light</b> <ul style="list-style-type: none"> <li>On when the baby unit is turned on.</li> <li>Flashes when the baby unit is not being viewed; or when the link to the parent unit is lost.</li> </ul>
3	<b>Microphone</b>
4	<b>Camera</b>
5	<b>Infrared LEDs</b>
6	<b>Light sensor</b>
7	<b>ON/OFF switch</b> <ul style="list-style-type: none"> <li>Slide to turn on or off the baby unit.</li> </ul>
8	<b>Speaker</b>
9	<b>Power jack</b>
10	<b>Wall mount holes</b>

## Parent unit overview

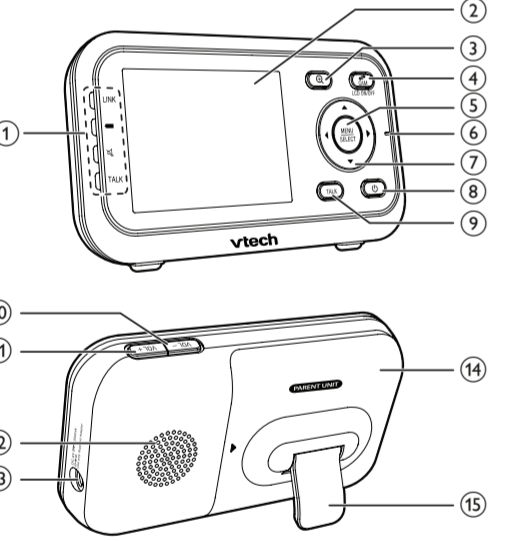

1	<b>LED lights</b> <ul style="list-style-type: none"> <li>Indicate the different statuses of the parent unit. For details, refer to <b>Parent unit lights</b>.</li> </ul>
2	<b>LCD display</b>
3	<b>Zoom</b> <ul style="list-style-type: none"> <li>Press to zoom in or out while viewing image.</li> </ul>
4	<b>CAM</b> <ul style="list-style-type: none"> <li>Press to change the screen to view images from different baby units.</li> <li>For VM3252-2 only</li> </ul> <b>LCD ON/OFF</b> <ul style="list-style-type: none"> <li>Press and hold to turn on or off the LCD screen.</li> </ul>
5	<b>MENU/SELECT</b> <ul style="list-style-type: none"> <li>Press to enter/exit the menu.</li> <li>While in a sub-menu, press to choose an item, or save a setting.</li> </ul>

6	<b>Microphone</b>
7	<ul style="list-style-type: none"> <li>While in a menu, press to scroll up, or to enter an item's sub-menu.</li> <li>While zooming, <b>press and hold</b> to move the zoomed image upward.</li> <li>While in a menu, press to scroll down.</li> <li>While zooming, <b>press and hold</b> to move the zoomed image downward.</li> <li>While in a menu, press to choose the next item on the right, or return to the main menu while in submenu.</li> <li>While zooming, <b>press and hold</b> to move the zoomed image leftward.</li> <li>While in a menu, press to choose the next item on the left, or enter into the submenu, if any.</li> <li>While zooming, <b>press and hold</b> to move the zoomed image rightward.</li> </ul>
8	<b>On/off</b> <ul style="list-style-type: none"> <li>Press and hold to power on.</li> <li>Press and hold again to power off.</li> </ul>
9	<b>TALK</b> <ul style="list-style-type: none"> <li>Press and hold to talk to the selected baby unit.</li> </ul>
10	<b>VOL-</b> <ul style="list-style-type: none"> <li>Turn down the volume when the speaker is on.</li> </ul>
11	<b>VOL+</b> <ul style="list-style-type: none"> <li>Turn up the volume when the speaker is on.</li> </ul>
12	<b>Speaker</b>
13	<b>Power jack</b>
14	<b>Battery compartment cover</b>
15	<b>Stand</b>

## Parent unit lights

<b>LINK</b>	On when the parent unit is linked to the baby unit. Flashes quickly when the link to the baby unit is nearly lost.
	On when the parent unit is connected to AC power, or the battery is charging. Flashes when the parent unit battery is low and needs charging. Off when the parent unit is disconnected from AC power.
	On when the speaker volume of the parent unit is turned off.
<b>TALK</b>	On when the parent unit is talking to the baby unit.

## Parent unit status icons

	<b>Connection status</b> <ul style="list-style-type: none"> <li> or  displays when strong signal strength is detected between the baby unit and the parent unit.</li> <li> or  displays when moderate or low signal strength is detected between the baby unit and the parent unit.</li> </ul>
	<b>Patrol mode</b> <ul style="list-style-type: none"> <li>Displays when the parent unit is in <b>PATROL</b> mode.</li> <li>For VM3252-2 only</li> </ul>
	<b>Current view status</b> <ul style="list-style-type: none"> <li>Displays the baby unit number of the baby unit that is being viewed.</li> </ul>
	<b>Zoom</b> <ul style="list-style-type: none"> <li>Displays when the current image on the parent unit has zoomed in.</li> </ul>
	<b>Night vision</b> <ul style="list-style-type: none"> <li>Displays when the baby unit being viewed has activated the night vision feature.</li> </ul>
	<b>Lullaby</b> <ul style="list-style-type: none"> <li>Displays when a lullaby is playing.</li> </ul>

	<b>Talkback</b> <ul style="list-style-type: none"> <li>Displays when talking back to the baby units from parent unit.</li> </ul>
	<b>6-level sound indicator</b> <ul style="list-style-type: none"> <li>Displays the sound level according to the scales of loudness when there is sound transmitted from the baby unit.</li> <li> (1 to 2 bars) indicates low sound level detected by the baby unit.</li> <li> (3 to 4 bars) indicates moderate sound level detected by the baby unit.</li> <li> (5 to 6 bars) indicates high sound level detected by the baby unit (e.g. baby crying loudly).</li> </ul>
	<b>Mute alert</b> <ul style="list-style-type: none"> <li>Displays when the parent unit speaker volume is set to off.</li> </ul>
	<b>Real-time temperature</b> <ul style="list-style-type: none"> <li>Displays the real-time temperature detected by the baby unit in Fahrenheit (°F) or Celsius (°C) (e.g. 57°F or 14°C).</li> </ul>
	<b>Battery status</b> <ul style="list-style-type: none"> <li> animates when the battery is charging.</li> <li> displays solid when the battery is fully charged.</li> <li> displays when the battery is low and needs charging.</li> </ul>
	<b>AC power without battery</b> <ul style="list-style-type: none"> <li>Displays when the parent unit is connected to AC power without the battery.</li> </ul>
	<b>Speaker volume</b> <ul style="list-style-type: none"> <li>Displays the parent unit speaker volume level while adjusting.</li> </ul>

## Parent unit main menu icons

	<b>Brightness</b> <ul style="list-style-type: none"> <li>You can change the brightness of the parent unit screen.</li> </ul>
	<b>LCD screen off timer</b> <ul style="list-style-type: none"> <li>You can set a specific time to screen off your parent unit.</li> </ul>
	<b>Temperature</b> <ul style="list-style-type: none"> <li>You can choose to set the maximum/minimum temperature and turn on the temperature alert tone so that the parent unit beeps whenever the room temperature detected by the baby unit falls outside of the desired temperature range.</li> <li>You can also choose to display the temperature in Fahrenheit (°F) or Celsius (°C) on your parent unit.</li> </ul>
	<b>Lullaby</b> <ul style="list-style-type: none"> <li>You can select, play, or stop a lullaby.</li> </ul>
	<b>VOX sensitivity</b> <ul style="list-style-type: none"> <li>With this feature, you can choose to hear sounds from the baby unit all the time, or to hear sounds that exceed a certain level. You can use the parent unit to adjust the microphone sensitivity of your baby unit. The higher the sensitivity level, the more sensitive the baby unit is in detecting sounds for transmitting to the parent unit.</li> </ul>
	<b>Sound-activated screen</b> <ul style="list-style-type: none"> <li>When the baby unit being viewed detects no sound, the parent unit screen stays off to save power. Once a sound is detected, the parent unit screen turns on automatically. It will then turn off again after 50 seconds of no sound detection.</li> </ul>
	<b>Patrol mode</b> <ul style="list-style-type: none"> <li>You can monitor your baby in <b>PATROL</b> mode.</li> <li>For VM3252-2 only</li> </ul>

## Parent unit warning icons and messages

	The link between the baby unit and the parent unit is lost.
	The battery is empty and needs to be recharged.
	Operation is in progress.
	The temperature detected by the baby unit is higher/lower than the desired temperature range.
	The temperature detected by the baby unit is higher/lower than the desired temperature range.
	The parent unit is searching for baby units.

## Using the baby monitor

### Power on or off the baby unit

- Slide the **ON/OFF** switch down to turn on the baby unit. The **POWER** LED light turns on.
- Slide the **ON/OFF** switch up to turn off the baby unit. The **POWER** LED light turns off.

### Power on or off the parent unit

- Press and hold **ON/OFF** to turn on the parent unit. The screen turns on.
- Press and hold **ON/OFF** again to turn off the parent unit. The screen turns off.

### Turn on or off the parent unit screen

- You can turn on or off the parent unit screen without powering off the parent unit. You can still hear sound from the baby unit.
- Press and hold **LCD ON/OFF** on the parent unit to turn off the screen.
  - Press any key on the parent unit to turn on the screen again.

### Screen off timer

You can set the screen off time for the parent unit when there is no key press for a specific time interval.

When the screen is turned off, you can still hear sound from the baby unit.

- Press **MENU** when the parent unit is idle.
- Press **Left** or **Right** to choose , then press **Up**.
- Press **Down** or **Up** to choose the desired time to time off screen (, , , or , then press **SELECT** to confirm your selection.

### Adjust LCD brightness

You can change the brightness of the parent unit screen from **Level 1** to **Level 5**. The LCD brightness is preset to **Level 3**.

- Press **MENU** when the parent unit is idle.
- Press **Left** or **Right** to choose , then press **Up**.
- Press **Down** or **Up** to choose the desired level of brightness, then press **SELECT** to confirm your selection.

## Adjust the sound sensitivity of the baby unit

You can choose to hear sounds from the baby unit all the time, or to hear sounds that exceed a certain level. You can use the parent unit to adjust the microphone sensitivity of your baby unit. The higher the sensitivity level, the more sensitive the baby unit is in detecting sounds for transmitting to the parent unit. The **VOX** sound sensitivity is preset to the highest level.

Sensitivity Level	Description
Highest	<p><b>Highest VOX sensitivity level</b></p> <p>The parent unit speaker is constantly on, and you will hear all sounds (including background noises) from your baby's room.</p>
High	<p><b>High VOX sensitivity level</b></p> <p>The parent unit speaker turns on for soft babbling and louder sounds from your baby. It remains quiet when your baby sleeps soundly.</p>
Medium	<p><b>Medium VOX sensitivity level</b></p> <p>The parent unit speaker turns on for loud babbling and louder sounds from your baby. It remains quiet when your baby makes soft sounds.</p>
Low	<p><b>Low VOX sensitivity level</b></p> <p>The parent unit speaker turns on for crying and louder sounds from your baby. It remains quiet when your baby makes soft sounds.</p>
Lowest	<p><b>Lowest VOX sensitivity level</b></p> <p>The parent unit speaker turns on for loud crying or screeching sounds from your baby. It remains quiet when your baby makes soft sounds.</p>

- Press **MENU** when the parent unit is idle.
- Press **Left** or **Right** to choose , then press **Up**.
- Press **Down** or **Up** to choose the desired sensitivity level, then press **SELECT** to confirm your selection.

- TIP**
- You can adjust the baby unit placement to improve the sound detection.

## Turn on or off the sound activation

When sound activation is on, as long as no sound is detected within 50 seconds, the parent unit screen will turn off automatically to save power.

When your baby unit detects a sound, which exceeds the selected sensitivity level, the sound activation triggers the parent unit screen to turn on automatically. When no sound is detected within 50 seconds, the screen will be off again.

- Press **MENU** when the parent unit is idle.
- Press **Left** or **Right** to choose , then press **Up**.
- Press **Down** or **Up** to choose **ON** or **OFF**, then press **SELECT** to confirm your selection.

- NOTE**
- If the sound sensitivity is set to the highest level, or lullaby is playing, the parent unit screen may remain on continuously even though sound activation is on. This depends on whether the baby unit detects any sounds.

## Adjust speaker volume

**For parent unit:**

- Press **VOL-/VOL+** on the parent unit to adjust the speaker volume.

- NOTE**
- When the parent unit speaker volume is set to zero, appears on the screen and the light turns on.

**For baby unit:**

The baby unit speaker volume determines the lullaby and talkback volume transmitted from your parent unit.

- Press **MENU** when the parent unit is idle.
- Press **Left** or **Right** to choose , then press **Up**.
- Press **Down** or **Up** to choose , then press **SELECT**.

## Monitoring mode

\* For VM3252-2 only

Every time the parent unit is turned on, it displays a baby unit in **SINGLE-CAM** mode. If there are two baby units in your system, you can also monitor your baby in **PATROL** mode.

<b>SINGLE-CAM</b>	The screen displays image of a single baby unit in full screen.
<b>PATROL</b>	A single cam view that transits to a different baby unit every 10 seconds.

**To switch to another camera:**

- Press **CAM** to switch to another camera.



**To switch between SINGLE-CAM and PATROL mode:**

- Press **MENU** when the parent unit is idle.
- Press **Left** or **Right** to choose , then press **Up**.
- Press **Down** or **Up** to switch on or off **PATROL** mode, then press **SELECT** to confirm your selection.
  - In **PATROL** mode, the camera view transits to a different baby unit every 10 seconds.

