

Hisense

Quick Start Guide

5.1.2CH Soundbar with Wireless Subwoofer

Model: U5120G



What's in the Box

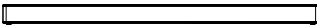

Main Unit

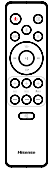

Remote Control /
AAA Batteries x 2



Wireless Subwoofer

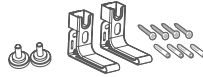

Wall Mounting Screws (x2) / Brackets (x2) /
Bracket Screw (x4) / Wall Anchors (x4)



AC power Cord *
x 2



HDMI Cable



User Manual /
Quick Start Guide



OPTICAL Cable

* Power cord quantity and plug type vary by regions.

1 Remote Control

- 1 Switch the unit between ON and STANDBY mode.
- 2 Select the play function.
- 3 **SURR** Adjust the surround ON/OFF.
- 4 Select the Bluetooth mode. Press and hold the (BT) button to activate the pairing function in Bluetooth mode or disconnect the existing paired Bluetooth device.
- 5 **EQ** Select a preset sound effect.
- 6 Skip to previous/next track in BT / USB mode.
- 7 **VOL+/-** Increase/decrease the volume level.
- 8 Play/pause/resume playback in BT / USB mode. Press and hold the button for 3s to enter setup menu. Confirm a selection.
- 9 **BASS+/-** Adjust bass level.
- 10 **TREBLE+/-** Adjust treble level.
- 11 **DIMMER+/-** Adjust display brightness.
- 12 Mute or resume the sound.

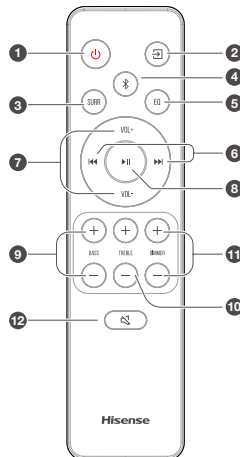

Replace the Remote Control Battery

- 1 Press and slide the back cover to open the battery compartment of the remote control.
- 2 Insert two AAA size batteries (included). Make sure the (+) and (-) ends of the batteries match the (+) and (-) ends indicated in the battery compartment.
- 3 Close the battery compartment cover.

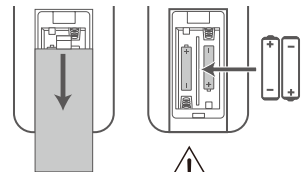

- Do not mix old and new batteries;
- Do not mix alkaline, standard (Carbon-Zinc) or rechargeable (Ni-Cd, Ni-MH, etc.) batteries.

2 Identifying the Parts

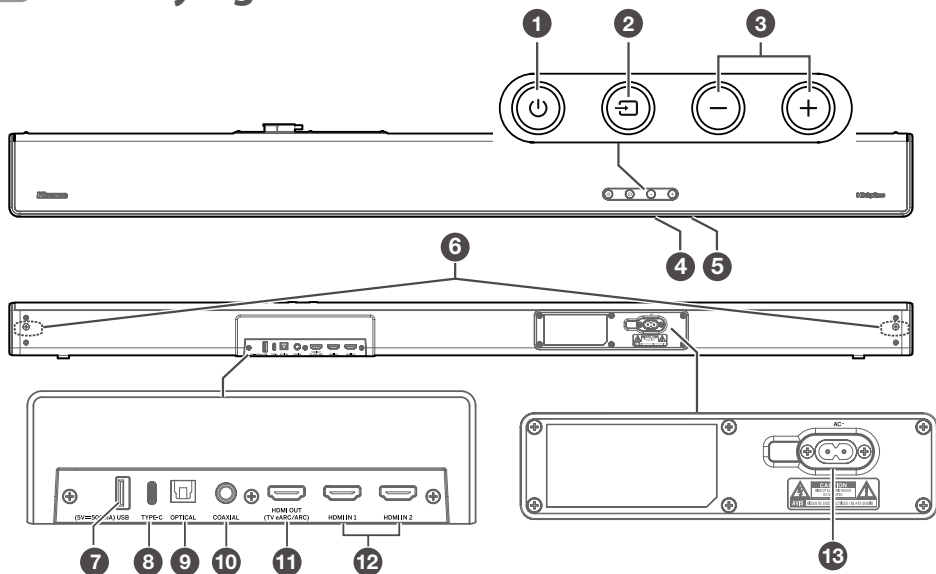

Main Unit

- ① **⏻ (ON/OFF) button**
Switch the unit between ON and Standby mode.
- ② **📺 (SOURCE) button**
Select the play function.
- ③ **VOL+/VOL- buttons**
Increase/decrease the volume level.
- ④ **Display Window**
Show the current status.
- ⑤ **Remote Control Sensor**
Receive signal from the remote control.
- ⑥ **Screws**
Remove the screws then install the wall mounting screws into the back of the unit.
- ⑦ **USB Socket**
Insert the USB device to play music.
- ⑧ **TYPE-C Socket**
For the Dongle of wireless rear surround speaker.
⚠ The surround kit needs to be purchased separately. This port can't be used to connect to other Type C devices.
- ⑨ **OPTICAL Socket**
Use to connect to the OPTICAL OUT socket on an external device.
- ⑩ **COAXIAL Socket**
Use to connect to the COAXIAL OUT socket on an external device.
- ⑪ **HDMI OUT (TV eARC/ARC) Socket**
The port for connecting a TV. The port supports the eARC/ARC HDMI feature, which allows the soundbar to play audio that originates on the connected TV.

- ⑫ **HDMI IN (1/2) Sockets**
Two HDMI ports for connecting HDMI source devices, such as a DVD player, Blu-ray Disc™ player, or gaming console. Note that only one HDMI input is usable at a time.
- ⑬ **AC~ Socket**
Connect to power supply.

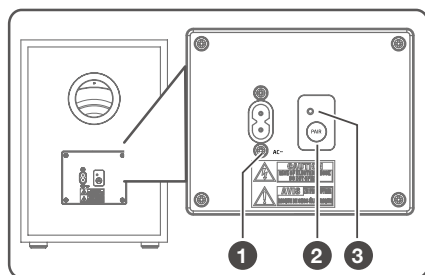

Wireless Subwoofer

- ① **AC~ Socket**
Connect to power supply.
- ② **PAIR button**
Press activate the pairing function between the main unit and the subwoofer.
- ③ **PAIR Indicator**
Light stops blinking once the Subwoofer is paired with the Soundbar.

3 Connections

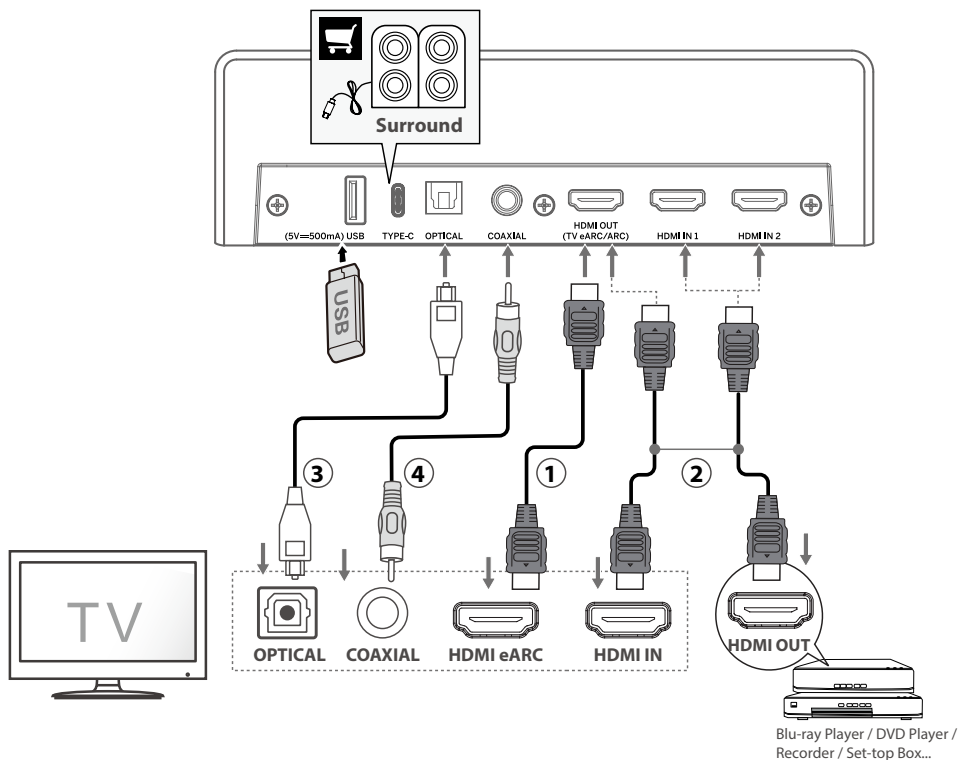

Pair up with the subwoofer

The subwoofer and the soundbar will be paired automatically when both are powered on. If no audio from the wireless subwoofer can be heard, manually pair up the subwoofer.

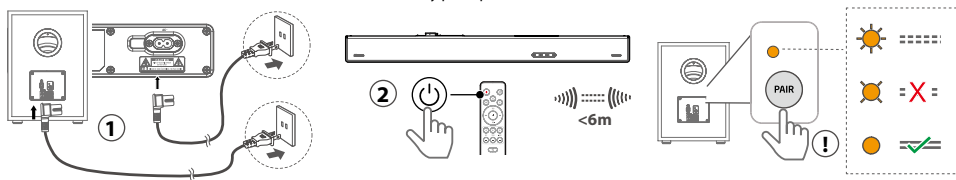

4 Bluetooth Operation (📶)

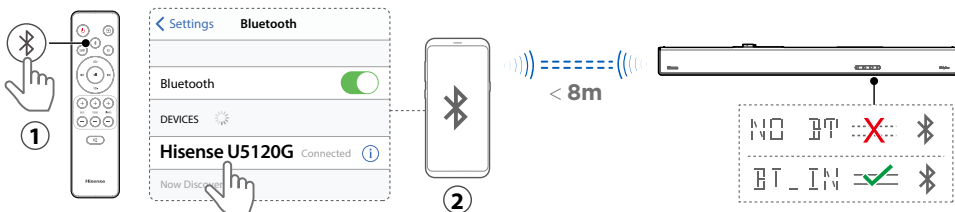

5 Setup Menu

1. During ON mode, press and hold the **▶▶** button for 3 seconds to open the menu.
2. Select the content with **◀◀/▶▶** buttons.
3. Change the initial values for each of the settings with **VOL +/-** buttons.
4. Press the **▶▶** button to confirm your selection and exit the settings.
 - If no button is pressed within 15 seconds, the system will automatically exit the menu.

Display (press ◀◀/▶▶)	Description (press VOL +/-)
1 MUSIC	Select Equalizer (EQ) Effect. (MUSIC, MOVIE, NEWS, SPORT, NIGHT, GAME, AI EQ)
2 SUR ON	Switch Surround Sound [ON / OFF]
3 BAS +S	Adjust the Bass Level
4 TRE +S	Adjust the Treble Level
5 DIM H	Adjust the Brightness (Exit menu to take effect)
6 AUTO WAKE ON	Switch Auto Wake [ON / OFF]
7 AUTO STANDBY ON	Switch Auto Standby [ON / OFF]

Display (press ◀◀/▶▶)	Description (press VOL +/-)
8 NO REAR	If there is no surround connection. Not adjustable.
SUR +S	If there is surround connected. Adjust the surround speakers Volume
9 LT 00	Set the Audio Delay (AV SYNC)
10 HI-RES REMASTER ON	Switch: HI-RES Remaster [ON / OFF]
11 DTS NEURAL ON	Switch: Dts Neural [ON / OFF]
12 DTS DRC HEAVY	Switch: Dts Drc Heavy / Dts Drc Mid / Dts Drc Min
13 DTS 00	Dts Dialog Control Value

6 Wall Mounting

