

QUICK SETUP GUIDE

# All-in-One Shelf System

NS-HAIOR18 / NS-HAIOR18-C

## PACKAGE CONTENTS

- All-in-One Shelf System
- Power cord
- FM antenna
- Remote control
- 2 AAA batteries
- Quick Setup Guide

## FEATURES

- 80W RMS total power for a superior listening experience
- 20W RMS left and right channels play audio in surround sound
- 40W RMS built-in subwoofer for rich bass
- Bluetooth connects to devices wirelessly
- FM tuner lets you listen to the radio
- CD player provides a variety of audio options
- USB port supports MP3 playback
- 3.5 mm audio input connects to analog devices
- Headphone jack enables private listening

## FEATURES

Front view

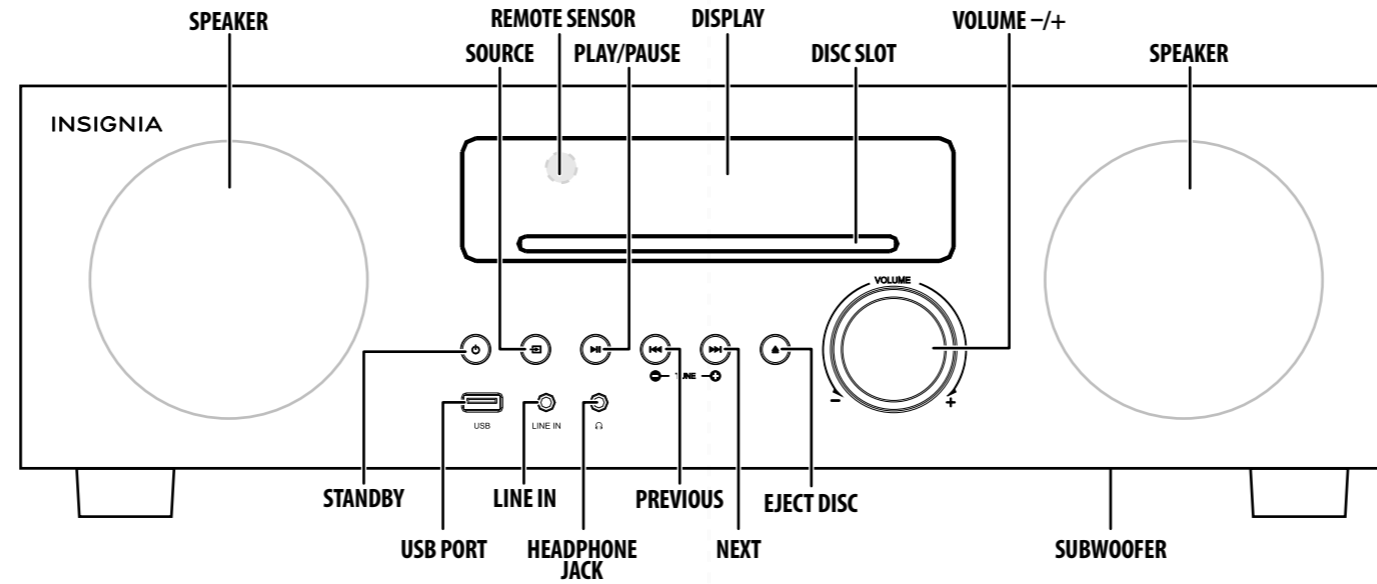

Back panel

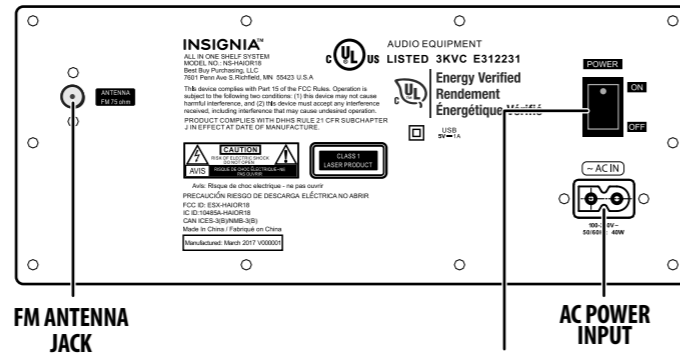

Remote control

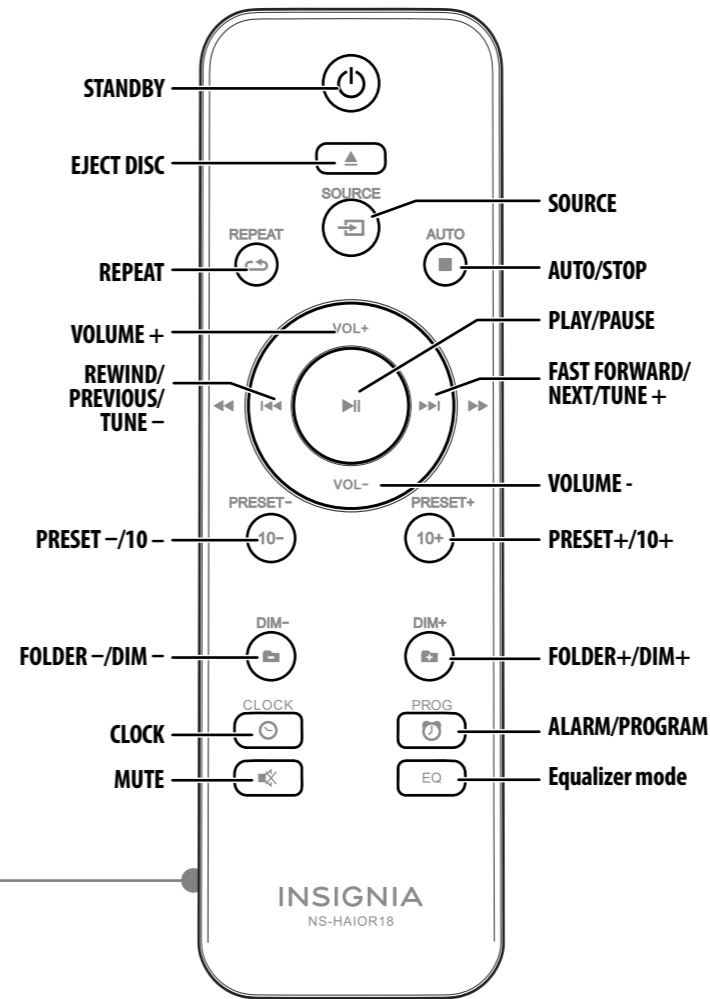

## INSTALLING THE REMOTE CONTROL BATTERIES

- 1 Remove the remote's battery cover.
- 2 Insert two AAA batteries into the compartment. Make sure that the + and - symbols on the battery match the symbols in the compartment.
- 3 Replace the cover.

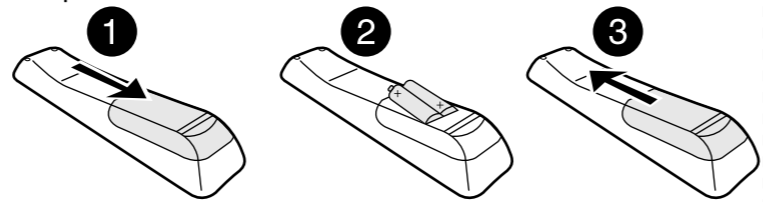

## SETTING UP YOUR SHELF SYSTEM

### CONNECTING THE FM ANTENNA

- 1 Connect the FM antenna to the **ANTENNA** jack on the back of your shelf system.
- 2 Adjust the antenna until you find the best reception.

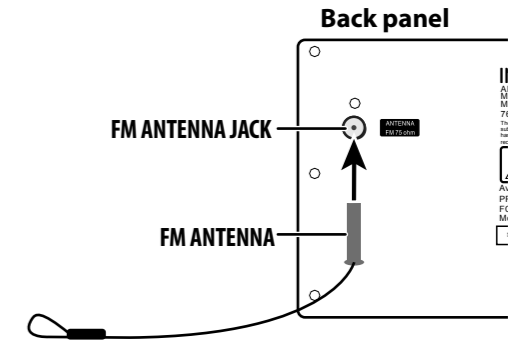

### TURNING ON YOUR SHELF SYSTEM

- 1 Connect the power cord to the AC jack on the back of your shelf system, then plug the other end into a power outlet.
- 2 Press the power switch on the back to turn your shelf system **ON**.

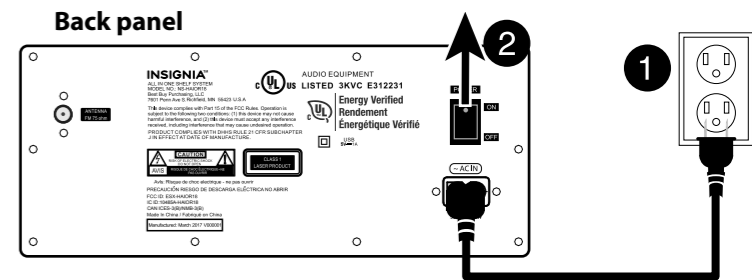

- 3 Press **⏻** (standby) on your shelf system or remote. The shelf system greets you with "HELLO."

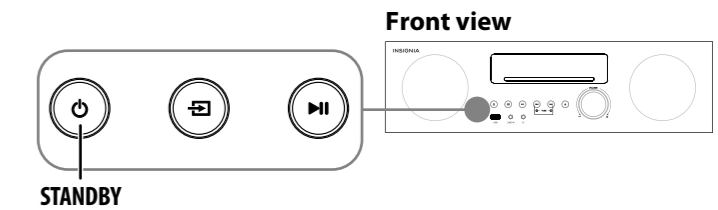

### SETTING THE CLOCK

- 1 In standby mode, press and hold **⌚** **CLOCK** on your remote.
 

**Note:** To enter standby mode, flip **ON** the power switch on the back of your shelf system, but do not press the **⏻** standby button on the front.
- 2 Press **⏮** (previous) or **⏭** (next) to select a 12-hour ("12H") or 24-hour ("24H") clock display, then press **⌚** **CLOCK** to save.
- 3 Press **⏮** (previous) or **⏭** (next) to set the hour, then press **⌚** **CLOCK** to save.
- 4 Press **⏮** (previous) or **⏭** (next) to set the minutes, then press **⌚** **CLOCK** to save.

## USING YOUR SHELF SYSTEM

### BLUETOOTH

#### Pairing your device

- 1 Make sure that your Bluetooth device (like a music player or phone) is turned on and within 33 feet (10 meters) of your shelf system.
- 2 On your Bluetooth device, navigate to your Bluetooth settings:
  - **For iOS devices:** Tap **Settings** > **General** > **Bluetooth**.
  - **For Android devices:** Tap **Settings** > **Wireless and networks**. Tap to activate Bluetooth, then tap Bluetooth settings.
  - **For PC or Mac computers:** See the instructions that came with your computer for more information.
- 3 Press **SOURCE** repeatedly until the shelf system displays "BT." Your shelf system enters Bluetooth pairing mode.

**Note:** If your shelf system isn't paired in 15 seconds, "NOBT" appears on the screen. Press **SOURCE** repeatedly to cycle back to "BT" to re-enter pairing mode. For best results, try to enable Bluetooth on your Bluetooth device (step 2) and select the source on your shelf system (step 3) at the same time.
- 4 On your Bluetooth device, select **NS-HAIOR18** in the list of devices. The shelf system beeps twice when paired.

**Note:** If prompted, enter "0000" as the passcode.

#### Playback

- Use your Bluetooth device to select audio.
- Make sure that your Bluetooth device's volume is set to at least 50%.
- Control playback with your Bluetooth device, remote, and the controls on the shelf speaker system (play/pause, mute, previous/next).

### USING THE FM RADIO

**Note:** Make sure that your antenna is attached.

- 1 Press **SOURCE** until the display says "FM."
- 2 To select a radio station:
  - To incrementally tune the radio frequency, press **◀** (previous) or **▶** (next).
  - To search for the next available station, press and hold **◀** (previous) or **▶** (next).
  - To skip to a preset station, press **PRESET-** or **PRESET+** repeatedly.

**Note:** See "Adding a preset station" for instructions about creating preset stations.

#### Adding a preset station

**Note:** You can program up to 20 stations.

- 1 Select the station, then press **PROG** on your remote.
- 2 Press **PRESET -** or **PRESET +** to select a program number.
- 3 Press **PROG** again to save the preset station.

#### OR

To program all stations, press **AUTO**. Your shelf system automatically assigns a program number to each available station.

### USING THE CD PLAYER

Your CD player works with CD, CD-R, and CD-RW formats.

- 1 Press **SOURCE** until the display says "CD."
- 2 Insert your CD label-side up into the disc slot. Playback begins automatically.
- 3 Use your remote or shelf system to control playback. See your online *User Guide* for more information.
- 4 When finished, press **▲** (eject) to eject your disc.

### CONNECTING WITH USB

**Note:** You can charge USB devices through the USB port (5V/1A output).

- 1 Connect a USB flash drive to your shelf system's USB port.

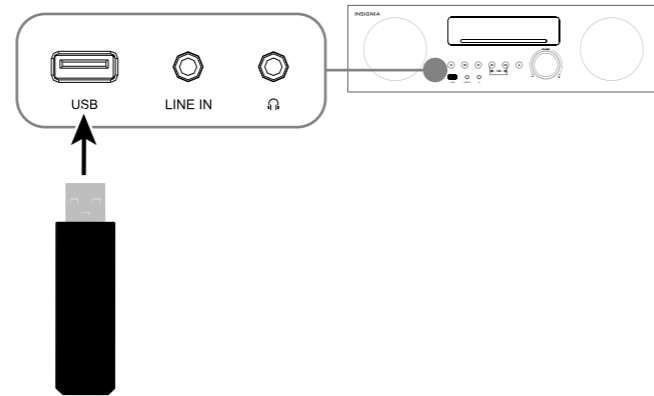

- 2 Press **SOURCE** repeatedly until the display says "USB."
- 3 Use the controls on your shelf speaker system or remote to control playback:
  - Press **◀** or **▶** to skip to the previous or next track.
  - Press **📁** or **📁** to navigate through your USB flash drive's folders.
  - Turn the volume knob or press **Vol+** or **Vol-** on your remote to adjust the volume.

### CONNECTING WITH AN AUDIO CABLE

- 1 Connect a 3.5 mm audio cable (not included) from your audio device to the shelf system's **LINE IN** jack.

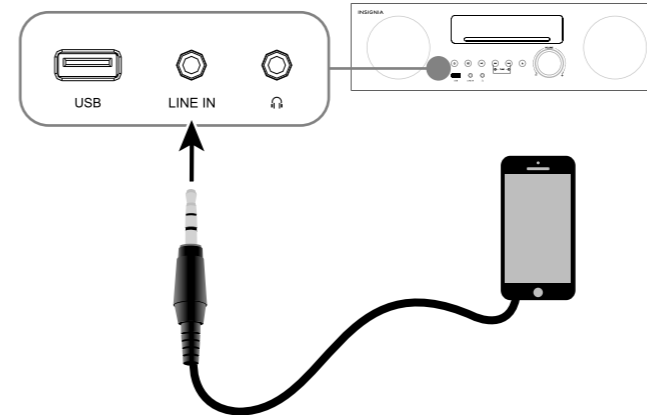

- 2 Press **SOURCE** repeatedly until the display says "LINE IN."
- 3 Use your audio device to control playback and the controls on your shelf system to adjust the volume.

**Note:** Make sure that your audio device's volume is set to at least 50%.

### CONNECTING HEADPHONES

- Connect your headphones to the **headphone jack**.

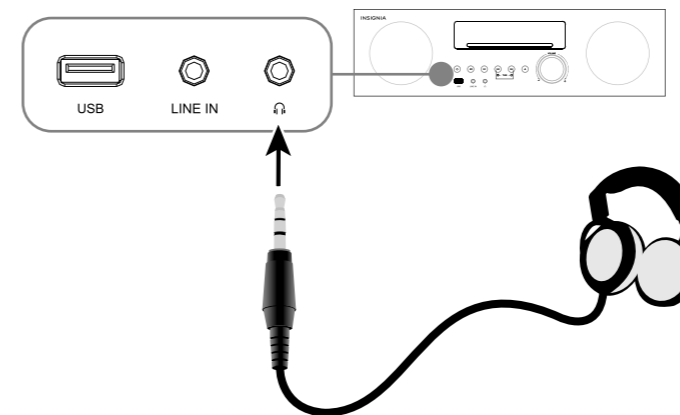

### SPECIFICATIONS

- **Dimensions (HxWxD):** 5.51 x 11.22 x 18.5 in. (140 x 285 x 470 mm)
- **Weight:** 12.8 lbs. (5.8 kg)
- **Power supply:** ~100-240V AC, 50/60Hz
- **Audio output power:** 20W x 2 + 40W
- **Frequency response:** 20Hz~20kHz (±3dB)
- **CD compatibility:** CDs, CD-Rs, CD-RWs in standard or 3" size
- **Supported file formats (USB):** MP3
- **FM frequency:** 87.5 - 107.9 MHz
- **Operating environment:** 14°~95°F (-10°~35°C), 5~90% humidity
- **Bluetooth:** 2.4 GHz, 33 ft. (10 m) working distance
- **Input jacks:** USB and LINE IN

## FCC STATEMENT

Changes or modifications not expressly approved by the party responsible for compliance could void the user's authority to operate the equipment.

#### RSS-Gen & RSS-210 statement:

This device complies with Industry Canada licence-exempt RSS standard(s).

Operation is subject to the following two conditions: (1) this device may not cause interference, and (2) this device must accept any interference, including interference that may cause undesired operation of the device.

Le présent appareil est conforme aux CNR d'Industrie Canada applicables aux appareils radio exempts de licence. L'exploitation est autorisée aux deux conditions suivantes : (1) l'appareil ne doit pas produire de brouillage, et (2) l'utilisateur de l'appareil doit accepter tout brouillage radioélectrique subi, même si le brouillage est susceptible d'en compromettre le fonctionnement.

#### RSS-102 Statement:

This equipment complies with Industry Canada radiation exposure limits set forth for an uncontrolled environment.

Cet équipement est conforme à l'exposition aux rayonnements Industry Canada limités établies pour un environnement non contrôlé.

## ONE-YEAR LIMITED WARRANTY

Visit [www.insigniaproducts.com](http://www.insigniaproducts.com) for details.

## CONTACT INSIGNIA:

For customer service, call 1-877-467-4289 (U.S. and Canada) or 01-800-926-3000 (Mexico) [www.insigniaproducts.com](http://www.insigniaproducts.com)

INSIGNIA is a trademark of Best Buy and its affiliated companies.

Distributed by Best Buy Purchasing, LLC

©2017 Best Buy. All rights reserved.

**Made in China**