

QUICK SETUP GUIDE

Landline Phone Headset

NS-MCHMRJ9P2



PACKAGE CONTENTS

- Landline Phone Headset
- Quick Setup Guide

FEATURES

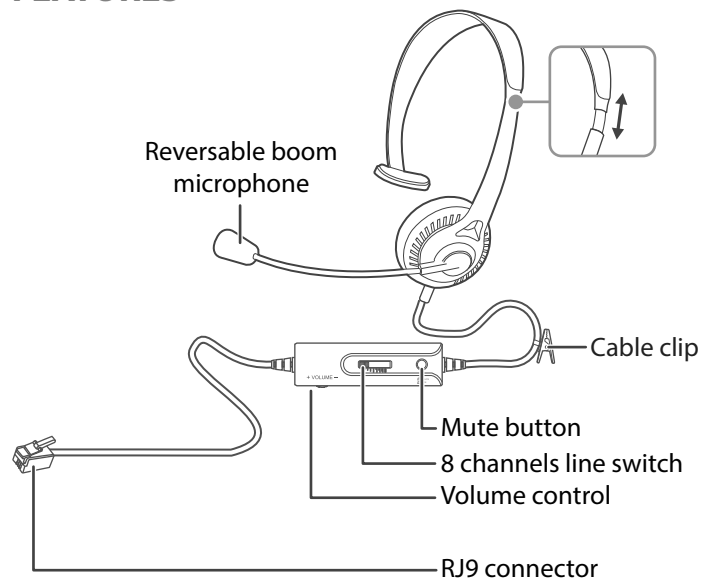

CONNECTING YOUR HEADSET

1 Turn down the volume on your headset.

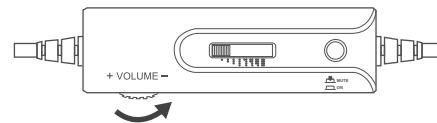

2 Plug the RJ9 connector into the RJ9 Headset Ready Jack on your phone.

Standard telephone

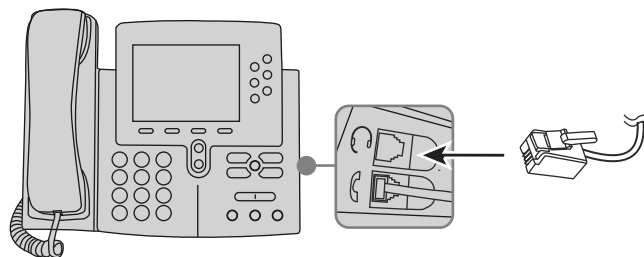

Dial pad

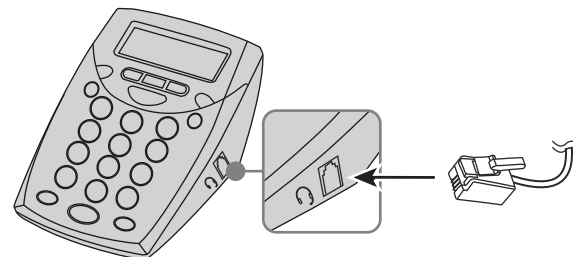

USING YOUR HEADSET

1 Place your headset on the top of your head (not around the back).

2 Adjust the reversible boom microphone so that it is about 1-inch (2.54 cm) from your mouth and off to one side.

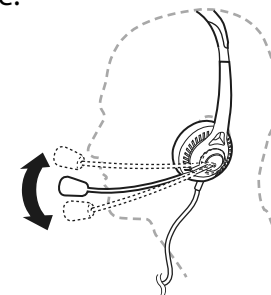

3 Slide the channel switch to another channel if the headset is not working. Try each channel to see which one works the best, including volume level for listening and speaking. Note the correct channel for future use.

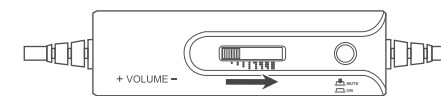

- 4 Begin talking and adjust the volume to a comfortable level.

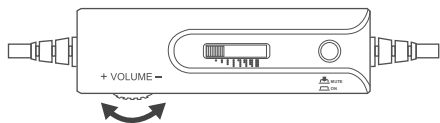

Warning: Extended exposure to high volumes when using your headset may result in permanent hearing loss.

- 5 To mute your conversation, press the Mute button.

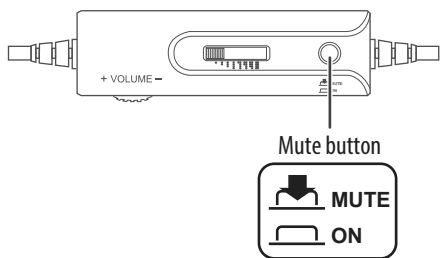

LEGAL NOTICES

FCC Statement

This device complies with part 15 of the FCC Rules. Operation is subject to the following two conditions: (1) This device may not cause harmful interference, and (2) this device must accept any interference received, including interference that may cause undesired operation.

Caution: Changes or modifications to this unit not expressly approved by the party responsible for compliance could void the user's authority to operate the equipment.

Note: This equipment has been tested and found to comply with the limits for a Class B digital device, pursuant to Part 15 of the FCC Rules. These limits are designed to provide reasonable protection against harmful interference in a residential installation. This equipment generates, uses and can radiate radio frequency energy and, if not installed and used in accordance with the instructions, may cause harmful interference to radio communications. However, there is no guarantee that interference will not occur in a particular installation. If this equipment does cause harmful interference to radio or television reception, which can be determined by turning the equipment off and on, the user is encouraged to try to correct the

interference by one or more of the following measures:

- Reorient or relocate the receiving antenna.
- Increase the separation between the equipment and receiver.
- Connect the equipment into an outlet on a circuit different from that to which the receiver is connected.
- Consult the dealer or an experienced radio/TV technician for help.

ICES-003

This Class B digital apparatus complies with Canadian ICES-003; Cet appareil numérique de la classe B est conforme à la norme NMB-003 du Canada.

ONE-YEAR LIMITED WARRANTY

Visit www.insigniaproducts.com for details.

CONTACT INSIGNIA:

For customer service, call 1-877-467-4289 (U.S. and Canada) or 01-800-926-3000 (Mexico)
www.insigniaproducts.com

INSIGNIA is a trademark of Best Buy and its affiliated companies
Distributed by Best Buy Purchasing, LLC
7601 Penn Ave South, Richfield, MN 55423 U.S.A.
©2018 Best Buy. All rights reserved.

Made in China