

INSIGNIA

QUICK SETUP GUIDE

Vertical USB Stand

NS-GXBOSXSTUSB19

PACKAGE CONTENTS

- Vertical console stand
- Xbox One X™ adapter
- Quick Setup Guide

FEATURES

- Adds controllers, mice, headsets, keyboards, and more to your Xbox One S™ or Xbox One X™
- Adds four extra USB 3.0 ports
- Keeps your console securely positioned and upright, increasing airflow around your console
- Easily plugs into and transfers power from the USB ports on the back of your Xbox One S™ or Xbox One X™
- Non-slip rubber feet prevent your console from moving
- Easy to install and uninstall

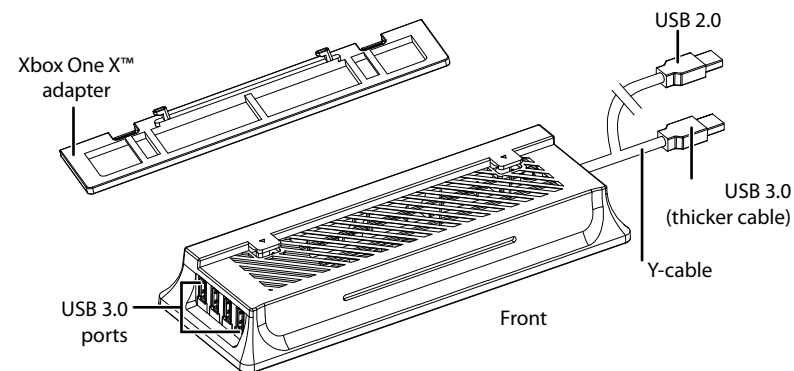

SETTING UP THE VERTICAL STAND

Connecting to the Xbox One S™

- 1 Remove all cables from the Xbox One S console.
- 2 Place the Xbox One S console on the stand slightly forward, then slide it toward the back edge of the stand.

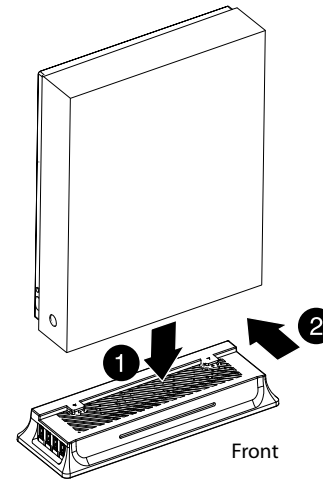

- 3 Connect all of the cables to the Xbox One S console.

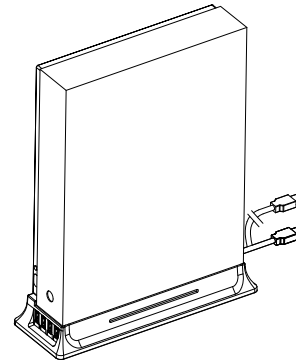

- 4 Connect the Y-cable to two USB ports on the back of the Xbox One S console.

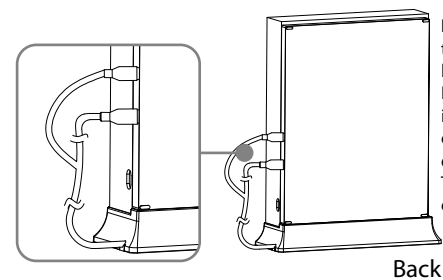

Note: For maximum power availability to all four USB ports on the stand, plug both USB connectors into your Xbox. If only one USB port is available, plug in the USB 3.0 connector (thicker cable) to allow both power and data delivery to your connected devices. The charge rate will be slower if only one USB cable is used.

- 5 Turn on the console.

Connecting to the Xbox One X™

- 1 Remove all cables from the Xbox One X console.
- 2 Place the adapter on the stand slightly forward, then slide it toward the back edge of the stand.

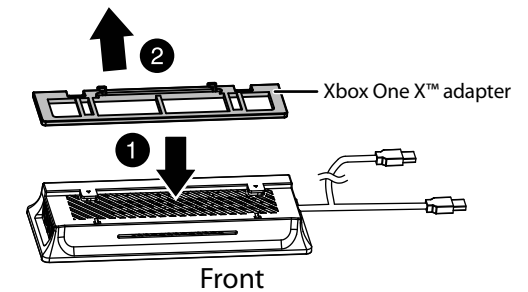

- 3 Place the Xbox One X console on the stand slightly to the left, then slide it to the right.

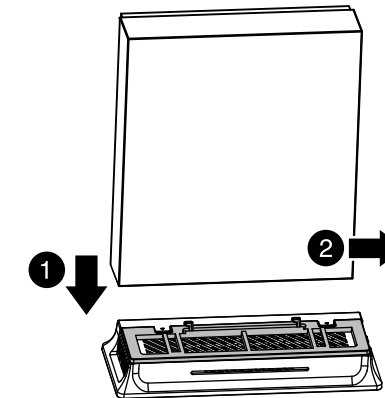

- 4 Connect all of the cables to the Xbox One X console.

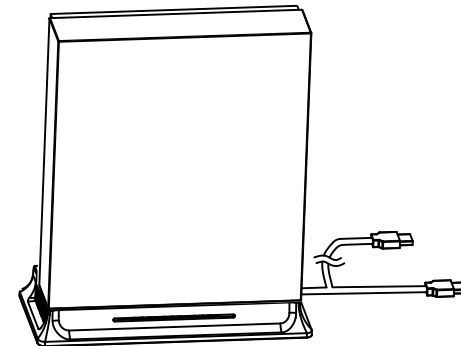

5 Connect the Y-cable to two USB ports on the back of the Xbox One X console.

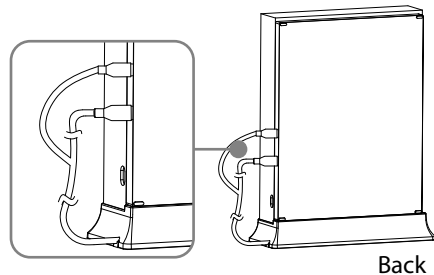

Note: For maximum power availability to all four USB ports on the stand, plug both USB connectors into your Xbox. If only one USB port is available, plug in the USB 3.0 connector (thicker cable) to allow both power and data delivery to your connected devices. The charge rate will be slower if only one USB cable is used.

Back

6 Turn on the console.

DISCONNECTING THE VERTICAL STAND

Disconnecting from the Xbox One S™

- 1 Remove all cables from the stand.
- 2 Grasp the Xbox One S with both hands (one on each side of the console), then slide it towards the left of the stand and pull it off.

Note: The Xbox One S must be pushed this way (towards the left of the stand per the arrow) to be removed.

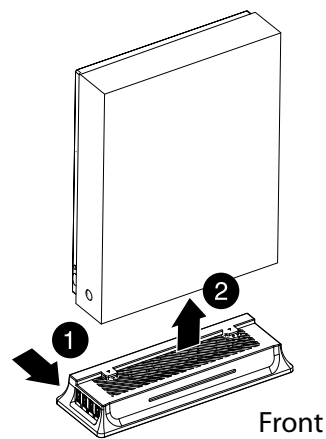

Front

Note: When moving your stand and console together, carry them with one hand on the stand and the other on your console.

Disconnecting from the Xbox One X™

- 1 Remove all cables from the stand.
 - 2 Grasp the Xbox One X with both hands (one on each side of the console), then slide it towards the left of the stand and pull it off.
- Note:** The Xbox One X must be pushed this way (towards the left of the stand per the arrow) to be removed.

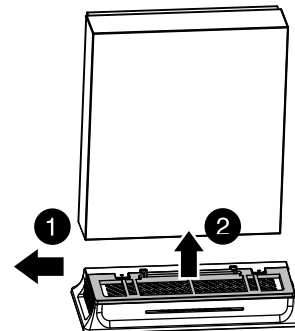

Front

Note: When moving your stand and console together, carry them with one hand on the stand and the other on your console.

SPECIFICATIONS

| | |
|--------------------------|---|
| Transmission port | USB 3.0 |
| Transmission rate | 5.0 Gbps (maximum) |
| Work temperature | 32°F~158°F (0°C~125°C) |
| Work humidity | 25% RH ~ 85% RH |
| Dimensions | 3.48 × 10.00 × 1.88 in (8.85 × 25.4 × 4.78 cm) |

SAFETY INFORMATION

- Do not put extreme pressure on this product.
- Do not dismantle this product.
- Keep this product away from heat sources, such as radiators and heaters.
- Keep this product dry and avoid any contact with damp or wet areas.

LEGAL NOTICES

FCC Caution

Changes or modifications not expressly approved by the party responsible for compliance could void the user's authority to operate the equipment.

FCC Statement

This equipment has been tested and found to comply with the limits for a Class B digital device, pursuant to part 15 of the FCC Rules.

These limits are designed to provide reasonable protection against harmful interference in a residential installation. This equipment generates, uses, and can radiate radio frequency energy and, if not installed and used in accordance with the instructions, may cause harmful interference to radio communications. However, there is no guarantee that interference will not occur in a particular installation.

If this equipment does cause harmful interference to radio or television reception, which can be determined by turning the equipment off and on, the user is encouraged to try to correct the interference by one or more of the following measures:

- Reorient or relocate the receiving antenna.
- Increase the separation between the equipment and receiver.
- Connect the equipment into an outlet on a circuit different from that to which the receiver is connected.
- Consult the dealer or an experienced radio/TV technician for help.

This device complies with part 15 of the FCC Rules. Operation is subject to the following two conditions: (1) This device may not cause harmful interference, and (2) this device must accept any interference received, including interference that may cause undesired operation.

ICES-003 Statement

CAN ICES-3 (B)/NMB-3 (B)

ONE-YEAR LIMITED WARRANTY

Visit www.insigniaproducts.com for details.

CONTACT INSIGNIA:

For customer service, call 1-877-467-4289 (U.S. and Canada) or 01-800-926-3000 (Mexico)

www.insigniaproducts.com

Xbox One S™ and Xbox One X™ are registered trademarks or trademarks of Microsoft Inc. All Rights reserved. All other trademarks are property of their respective owners. Photos and illustrations not binding. Contents, designs and specifications are subject to change without notice and may vary from one country to another. This product is not distributed under official license from or approved, sponsored or endorsed by Microsoft Inc. This product is not manufactured for Microsoft Inc.

Microsoft and Xbox One are registered trademarks of the Microsoft group of companies.

INSIGNIA is a trademark of Best Buy and its affiliated companies

Distributed by Best Buy Purchasing, LLC

7601 Penn Ave South, Richfield, MN 55423 U.S.A.

©2018 Best Buy. All rights reserved.

Made in China