

INSIGNIA™

USER GUIDE

26 lb. Portable Ice Maker

NS-IMP26BK7/NS-IMP26SS7



Before using your new product, please read these instructions to prevent any damage.

Contents

Introduction	2
Important Safety Instructions.....	3
Grounding requirement.....	5
Features	5
Package contents.....	5
Components.....	6
Control and display panel	7
Using your ice maker	7
Preparing your ice maker.....	7
Making ice.....	7
Maintaining your ice maker.....	8
Cleaning the interior of your ice maker	8
Tips on saving energy	9
Troubleshooting	9
Specifications	9
ONE-YEAR LIMITED WARRANTY	10

Introduction

Congratulations on your purchase of a high-quality Insignia product. Your NS-IMP26BK7 or NS-IMP26SS7 represents the state of the art in portable ice maker design and is designed for reliable and trouble-free performance.

Important Safety Instructions



This symbol indicates that dangerous voltage constituting a risk of electric shock is present within your ice maker.



This symbol indicates that there are important operating and maintenance instructions in the literature accompanying your ice maker.

WARNING

- 1 Read these instructions.
- 2 Keep these instructions.
- 3 Heed all warnings.
- 4 Follow all instructions.
- 5 Do not use this appliance near water.
- 6 Clean only with a damp cloth.
- 7 Do not block any ventilation openings. Install in accordance with the manufacturer's instructions.
- 8 Do not install near any heat sources such as radiators, heat registers, stoves, or other apparatus (including amplifiers) that produce heat.
- 9 Do not defeat the safety purpose of the polarized or grounding-type plug. A polarized plug has two blades with one wider than the other. A grounding type plug has two blades and a third grounding prong. The wide blade or the third prong are provided for your safety. If the provided plug does not fit into your outlet, consult an electrician for replacement of the obsolete outlet.
- 10 Protect the power cord from being walked on or pinched particularly at plugs, convenience receptacles, and the point where they exit from the appliance.
- 11 Do not attempt to modify or extend the power cord of this appliance.
- 12 Unplug this appliance during lightning storms or when it will not be used for long periods of time.
- 13 Unplug this appliance before cleaning it.

- 14 Make sure that the available AC power matches the voltage requirements of this appliance.
- 15 Do not handle the plug with wet hands. This could result in an electric shock.
- 16 Unplug the power cord by holding the plug, never by pulling the cord.
- 17 Do not turn the appliance on or off by plugging or unplugging the power cord.
- 18 Turn off the appliance before unplugging it.
- 19 Refer all servicing to qualified service personnel. Servicing is required when the appliance has been damaged in any way, such as the power-supply cord or plug is damaged, liquid has been spilled or objects have fallen into the appliance, the appliance has been exposed to rain or moisture, does not operate normally, or has been dropped.
- 20 To reduce the risk of fire or electric shock, do not expose this appliance to rain, moisture, dripping, or splashing, and no objects filled with liquids should be placed on top of it.
- 21 Do not use your ice maker outdoors. Place the ice maker away from direct sunlight and make sure that there is at least four inches of space between the back of your unit and wall. Keep a minimum distance of four inches on each side of your unit free.
- 22 Do not use liquids other than water to make ice-cubes.
- 23 Do not clean your ice maker with flammable fluids. The fumes can create a fire hazard or explosion.
- 24 Do not tip over.



WARNING

Electric Shock Hazard

Failure to follow these instructions can result in electric shock, fire, or death.

- 1 **WARNING**—Keep ventilation openings in the ice maker clear of obstruction.
- 2 **WARNING**—Do not damage the refrigerant tubing when handling, moving, or using the ice maker.
- 3 **WARNING—DANGER**—Never allow children to play with or operate the ice maker.
- 4 Unplug the ice maker before carrying out user maintenance on it.
- 5 If a component part is damaged, it must be replaced by the manufacturer, its service agent, or similar qualified persons in order to avoid a hazard.

- 6 Follow local regulations regarding disposal of the ice maker due to flammable refrigerant and gas. All refrigeration products contain refrigerants, which under the guidelines of federal law must be removed before disposal. It is the consumer's responsibility to comply with federal and local regulations when disposing of this product.
- 7 This ice maker is intended to be used in household and similar environments.
- 8 We do not recommend the use of an extension cord with this appliance. If you must use an extension cord, use one with a minimum of 14 AWG wiring and rated at no less than 1875 Watts.

Grounding requirement

This ice maker must be grounded. This ice maker is equipped with a cord having a grounding wire with a grounding plug. The plug must be inserted into an outlet that is properly installed and grounded.

Improper use of the grounding plug can result in a risk of electric shock. Consult a qualified electrician or service person if the grounding instructions are not completely understood, or if doubt exists as to whether the ice maker is properly grounded.

Features

- Produces up to 26 lbs. of ice a day
- Stores up to 1.1 lbs of ice at a time
- Water recycling system with a 2.11 quart reservoir
- Control panel with LED display
- Removable ice basket
- Low power consumption

Package contents

- Portable ice maker
- Ice scoop
- Ice basket
- *Quick Setup Guide*

Components

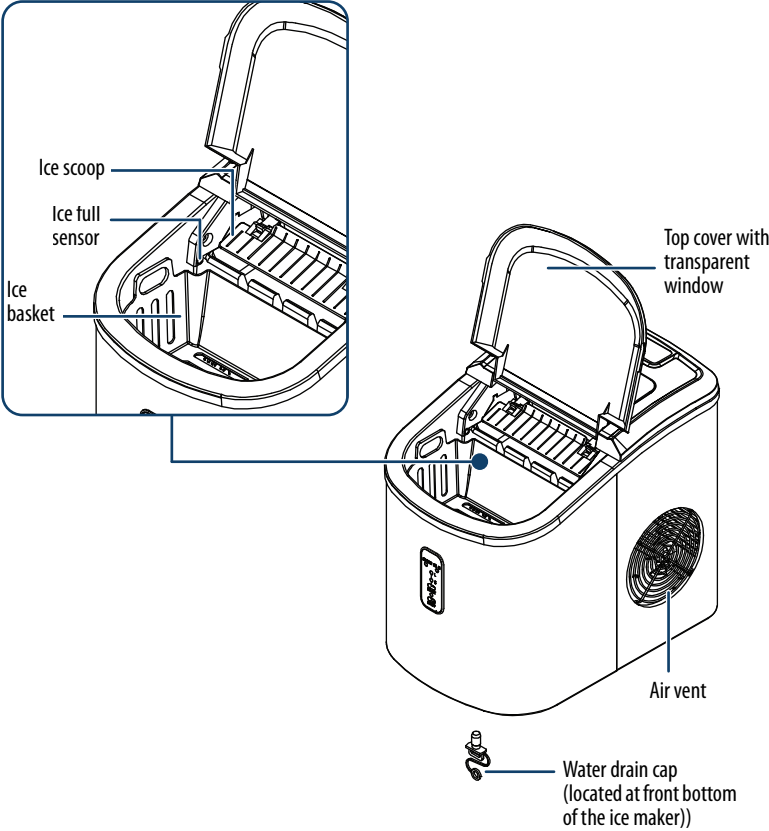

Control and display panel

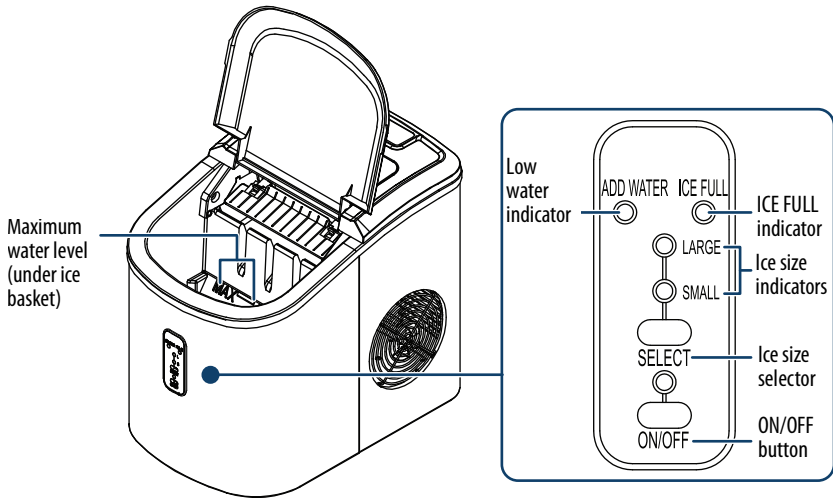

Using your ice maker

Preparing your ice maker

- 1 Remove the exterior and interior packaging.
- 2 Make sure that the ice basket and ice scoop are inside. If any parts are missing, please contact customer service.
- 3 Remove the tape holding the ice scoop and ice basket.
- 4 Clean the tank and ice basket with diluted detergent, warm water, and a soft cloth.
- 5 Put the ice maker on a flat and level surface, out of direct sunlight and other sources of heat (such as a stove, furnace, or radiator). Make sure that the ice maker is positioned so that the plug is accessible and there is at least four inches (10 cm) of gap on all sides of the ice maker.
- 6 Allow one hour for the refrigerant fluid to settle, then plug the ice maker in to a grounded wall outlet.

Making ice

Prior to using your ice maker each time, wipe out the interior with a clean, damp cloth.

- 1 Open the cover and remove the ice basket.
- 2 Pour tap water into the tank up to the maximum water level mark.
- 3 Press the **ON/OFF** button to turn on your ice maker. The indicator above the button turns on to show that the ice maker is running.

- 4 Press the **SELECT** button to choose the size of ice produced.
The ice making cycle takes from 6 to 13 minutes to complete, depending on the ice cube size selected and the room temperature. The ice maker stops when the ice basket is full (the ICE FULL indicator turns on).

Notes

- If the room temperature is below 60° F (15.6° C), select the **SMALL** ice cube size to prevent the ice cubes from sticking together.
- Press and hold the **SELECT** button for five seconds to run 10 continuous cycles, even when the ICE FULL indicator is on.

- 5 Discard the first few batches of ice the first time you use the ice maker, or the first time you use it after an extended period of time.

Caution

- Direct sunlight or reflected sunlight may cause the infrared sensor to malfunction. If the unit does not stop making ice cubes even when full, move the ice maker to a darker location.
- You must change the water in the tank at least every 24 hours to ensure a reasonable hygiene level and avoid bad smelling ice.

Maintaining your ice maker

Your ice maker is designed for year-round use with only minimal cleaning and maintenance.

When you first receive it, wipe the outside with a mild detergent and warm water, then wipe dry with a dry cloth. Do this periodically to keep your ice maker looking new.

Caution

To prevent damage to the finish, do not use:

- Gasoline, benzene, thinner, or other similar solvents.
- Abrasive cleaners.

Cleaning the interior of your ice maker

- 1 Unplug the ice maker.
- 2 Take out the ice basket.
- 3 Clean the interior with diluted detergent, warm water, and a soft cloth.
- 4 Use clean water to rinse the inside parts, then drain the water by unplugging the drain cap on the front bottom side.
- 5 Dry the interior with a clean soft cloth.
- 6 When the machine is not to be used for a long time, drain the water completely and dry the interior.

Tips on saving energy

- Locate your ice maker in the coolest area of the room, away from heat producing appliances or heating ducts and out of the direct sunlight.
- Make sure that the appliance is sufficiently ventilated, with adequate air circulation behind it.

Troubleshooting

Caution

Do not try to repair ice maker yourself. Doing so invalidates the warranty.

Problem	Possible cause	Possible solution
The ADD WATER indicator is on	The ice maker is out of water.	Turn the ice maker off, add water to the Maximum water level mark, then press the ON/OFF button to turn on the ice maker.
The ICE FULL indicator is on	The ice basket is full.	Remove the ice from the ice basket.
The ice cubes stick together	The ice making cycle is too long.	Stop the ice maker, wait for the ice to melt, then restart the ice maker after selecting SMALL sized ice cubes.
	The water temperature is too cold.	Replace the water with warmer water.
The ice maker runs through its normal cycle, but no ice is formed	The room temperature or water temperature is too high.	The room temperature should be 50°F-105°F (10°-40.6° C), water temperature should be 40° F - 90° F (4.44° C - 32.2° C).
The ice maker won't stop making ice	Direct or reflected sunlight can cause the sensor to malfunction.	Move the ice maker to a darker location.

Specifications

Enclosure	NS-IMP26BK7 - plastic NS-IMP26SS7 - stainless steel
Net Weight	17.8 lbs. (8.1 kg)
Power requirements	120 V ~ 60 Hz
Current	Ice making - 1.5 A Ice harvest - 2.0 A
Dimensions (W x D x H)	9.53 × 14.09 × 12.91 in. (24.2 × 35.8 × 32.8 cm)
Shape of the ice	Round

ONE-YEAR LIMITED WARRANTY

Definitions:

The Distributor* of Insignia branded products warrants to you, the original purchaser of this new Insignia-branded product ("Product"), that the Product shall be free of defects in the original manufacturer of the material or workmanship for a period of one (1) year from the date of your purchase of the Product ("Warranty Period").

For this warranty to apply, your Product must be purchased in the United States or Canada from a Best Buy branded retail store or online at www.bestbuy.com or www.bestbuy.ca, and is packaged with this warranty statement.

How long does the coverage last?

The Warranty Period lasts for 1 year (365 days) from the date you purchased the Product. Your purchase date is printed on the receipt you received with the Product.

What does this warranty cover?

During the Warranty Period, if the original manufacture of the material or workmanship of the Product is determined to be defective by an authorized Insignia repair center or store personnel, Insignia will (at its sole option): (1) repair the Product with new or rebuilt parts; or (2) replace the Product at no charge with new or rebuilt comparable products or parts. Products and parts replaced under this warranty become the property of Insignia and are not returned to you. If service of Products or parts are required after the Warranty Period expires, you must pay all labor and parts charges. This warranty lasts as long as you own your Insignia Product during the Warranty Period. Warranty coverage terminates if you sell or otherwise transfer the Product.

How to obtain warranty service?

If you purchased the Product at a Best Buy retail store location, please take your original receipt and the Product to any Best Buy store. Make sure that you place the Product in its original packaging or packaging that provides the same amount of protection as the original packaging. If you purchased the Product from a Best Buy online web site (www.bestbuy.com or www.bestbuy.ca), mail your original receipt and the Product to the address listed on the web site. Make sure that you put the Product in its original packaging or packaging that provides the same amount of protection as the original packaging.

To obtain warranty service, in the United States call 1-888-BESTBUY, Canada call 1-866-BESTBUY. Call agents may diagnose and correct the issue over the phone.

Where is the warranty valid?

This warranty is valid only in the United States and Canada at Best Buy branded retail stores or websites to the original purchaser of the product in the county where the original purchase was made.

What does the warranty not cover?

This warranty does not cover:

- Food loss/spoilage due to failure of refrigerator or freezer
- Customer instruction/education
- Installation
- Set up adjustments
- Cosmetic damage
- Damage due to weather, lightning, and other acts of God, such as power surges
- Accidental damage
- Misuse
- Abuse

- Negligence
- Commercial purposes/use, including but not limited to use in a place of business or in communal areas of a multiple dwelling condominium or apartment complex, or otherwise used in a place of other than a private home.
- Modification of any part of the Product, including the antenna
- Display panel damaged by static (non-moving) images applied for lengthy periods (burn-in).
- Damage due to incorrect operation or maintenance
- Connection to an incorrect voltage or power supply
- Attempted repair by any person not authorized by Insignia to service the Product
- Products sold “as is” or “with all faults”
- Consumables, including but not limited to batteries (i.e. AA, AAA, C etc.)
- Products where the factory applied serial number has been altered or removed
- Loss or Theft of this product or any part of the product
- Display panels containing up to three (3) pixel failures (dots that are dark or incorrectly illuminated) grouped in an area smaller than one tenth (1/10) of the display size or up to five (5) pixel failures throughout the display. (Pixel based displays may contain a limited number of pixels that may not function normally.)
- Failures or Damage caused by any contact including but not limited to liquids, gels or pastes.

REPAIR REPLACEMENT AS PROVIDED UNDER THIS WARRANTY IS YOUR EXCLUSIVE REMEDY FOR BREACH OF WARRANTY. INSIGNIA SHALL NOT BE LIABLE FOR ANY INCIDENTAL OR CONSEQUENTIAL DAMAGES FOR THE BREACH OF ANY EXPRESS OR IMPLIED WARRANTY ON THIS PRODUCT, INCLUDING, BUT NOT LIMITED TO, LOST DATA, LOSS OF USE OF YOUR PRODUCT, LOST BUSINESS OR LOST PROFITS. INSIGNIA PRODUCTS MAKES NO OTHER EXPRESS WARRANTIES WITH RESPECT TO THE PRODUCT, ALL EXPRESS AND IMPLIED WARRANTIES FOR THE PRODUCT, INCLUDING, BUT NOT LIMITED TO, ANY IMPLIED WARRANTIES OF AND CONDITIONS OF MERCHANTABILITY AND FITNESS FOR A PARTICULAR PURPOSE, ARE LIMITED IN DURATION TO THE WARRANTY PERIOD SET FORTH ABOVE AND NO WARRANTIES, WHETHER EXPRESS OR IMPLIED, WILL APPLY AFTER THE WARRANTY PERIOD. SOME STATES, PROVINCES AND JURISDICTIONS DO NOT ALLOW LIMITATIONS ON HOW LONG AN IMPLIED WARRANTY LASTS, SO THE ABOVE LIMITATION MAY NOT APPLY TO YOU. THIS WARRANTY GIVES YOU SPECIFIC LEGAL RIGHTS, AND YOU MAY ALSO HAVE OTHER RIGHTS, WHICH VARY FROM STATE TO STATE OR PROVINCE TO PROVINCE.

Contact Insignia:

For customer service please call 1-877-467-4289

www.insigniaproducts.com

INSIGNIA is a trademark of Best Buy and its affiliated companies.

Distributed by Best Buy Purchasing, LLC

7601 Penn Ave South, Richfield, MN 55423 U.S.A.

©2016 Best Buy. All rights reserved.

Made in China

INSIGNIA™

www.insigniaproducts.com

1-877-467-4289 (U.S. and Canada) or 01-800-926-3000 (Mexico)

INSIGNIA is a trademark of Best Buy and its affiliated companies.

Distributed by Best Buy Purchasing, LLC

7601 Penn Ave South, Richfield, MN 55423 U.S.A

©2016 Best Buy. All rights reserved.

Made in China

V1 ENGLISH
16-0541