

WHAT TO EXPECT

As your robot learns your home, you may need to make some small adjustments to optimize performance.

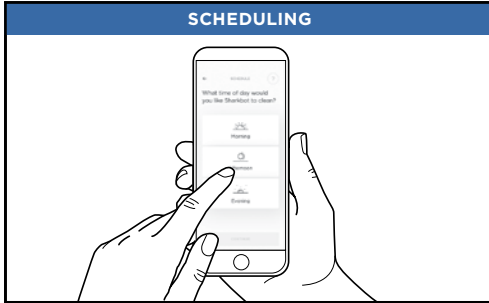

For a constant state of clean, set up a cleaning schedule in the app.

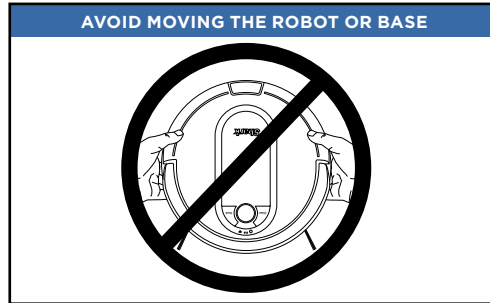

While your robot is cleaning, do not pick it up and move it, or move the charging base—this could impact the robot's ability to map your home.

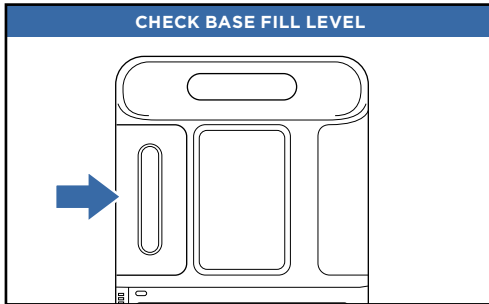

During the first few weeks, your robot will empty more often than usual. Check the fill level regularly. Home environments vary, and the bin may fill up quicker in some homes.

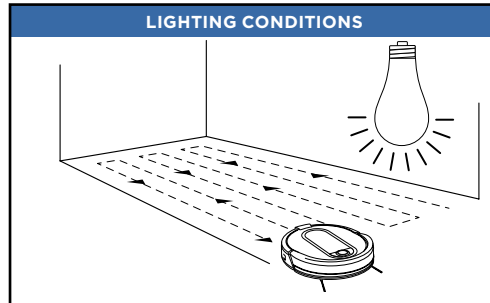

For best results, run your robot in well-lit conditions. If you run your robot at night, keep the lights on in the areas to be cleaned.

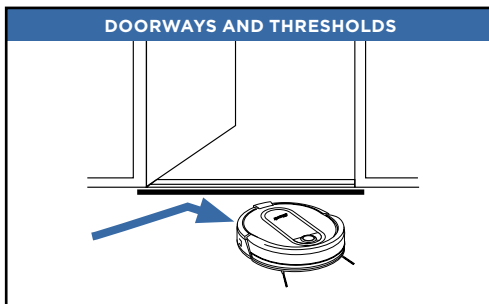

Your robot can easily climb over most thresholds, but if one is higher than 7/8ths of an inch, block it off with a BotBoundary® strip.

Please be sure to read the enclosed Shark® Owner's Guide prior to using your robot.

Shark IQ ROBOT

SELF-EMPTY XL

QUICK START GUIDE

To stay current on our latest updates and features,
DOWNLOAD THE SHARKCLEAN™ APP.

Search “SharkClean” in the app store.



Scan QR code with your phone's camera to quickly find and download the app

© 2020 SharkNinja Operating LLC. BOTBOUNDARY, SHARK, and SHARK IQ ROBOT are registered trademarks of SharkNinja Operating LLC. CONSTANT STATE OF CLEAN, SHARKCLEAN, and SHARK IQ ROBOT SELF-EMPTY are trademarks of SharkNinja Operating LLC. APPLE, the Apple logo, and iPhone are trademarks of Apple Inc., registered in the U.S. and other countries. APP STORE is a service mark of Apple Inc., registered in the U.S. and other countries. GOOGLE, GOOGLE ASSISTANT, GOOGLE PLAY, the Google Play logo, and Android are trademarks of GOOGLE LLC.



@sharkcleaning

SETUP

STEP 1 PREP THE ROBOT

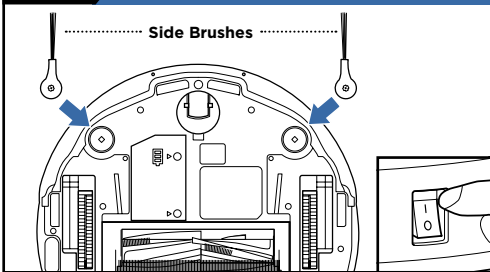

- Remove protective film from robot and base.
- **Attach side brushes located in the red packaging.**
- **The power button on the side of the robot must be in the (I) ON position.**

STEP 3 PLUG IN THE BASE

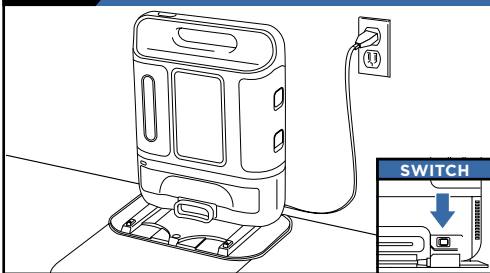

- Plug cord into electrical outlet.
 - Make sure the **power switch on the back of the dock is in the ON position.**
- The **Indicator Light** will illuminate green when base has power.

STEP 2 SET UP THE BASE

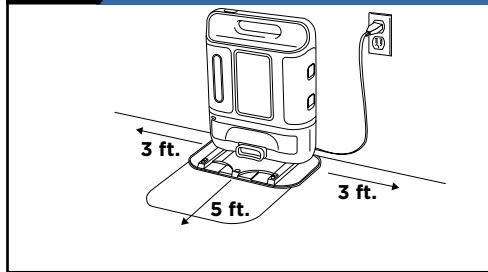

Find a **permanent** location for the base. Place it with its back against a wall, in an area with a good Wi-Fi signal. **Remove any objects** that are closer than 3 ft. from either side of the base, or closer than 5 ft. from the front. For best results, set up base on **hard floor**.

STEP 4 CHARGE THE ROBOT

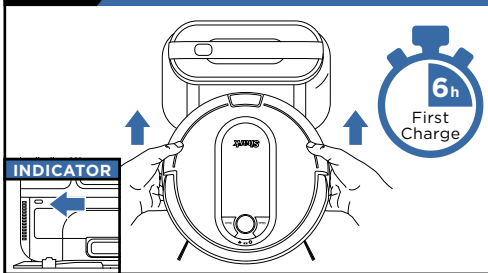

Place robot on base to charge for **6 hours**. Power button must be in the (I) ON position and the robot must be aligned correctly, with its **BACK** side against the base. When charging begins, the robot will BEEP and the DOCK light will turn BLUE.

NOTE: Every time the robot returns to the dock, it will make a loud noise as it empties debris. This is normal and no cause for concern.

OPTIMIZING YOUR HOME FOR CLEANING

STEP 5 PREP YOUR HOME

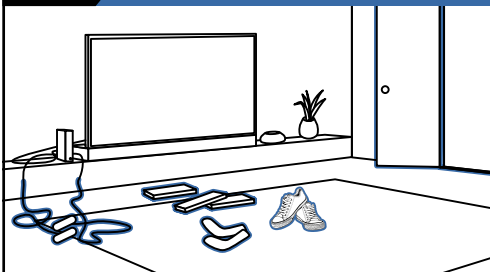

Clear cords and remove small objects like toys, clothing, or drapes from floors. Open interior doors in rooms you want your robot to clean.

CONNECTING THE SHARKCLEAN™ APP AND ROBOT

Search SharkClean in the app store and download to get started.

STEP 1 Create An Account

- Open the **SharkClean** app and set up your account.

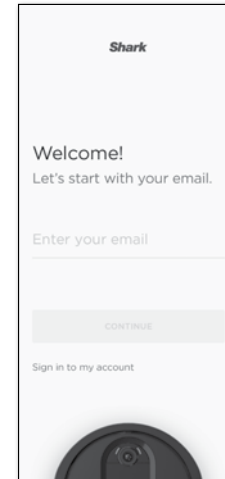

STEP 4 Connect To Home Wi-Fi

- Select your home Wi-Fi network and enter your password.
- NOTE:** Most networks are **2.4 GHz**. The app will not work on 5 GHz network.

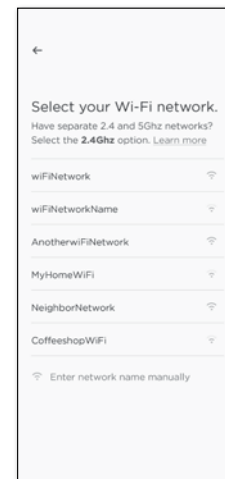

STEP 2 Activate Robot Wi-Fi

- Hold down **Dock and Clean** buttons **simultaneously** until your Shark prompts you with audio, and Wi-Fi light (📶) on robot blinks

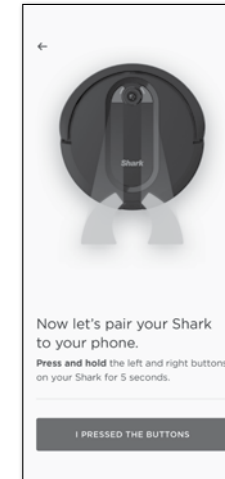

STEP 5 Success!

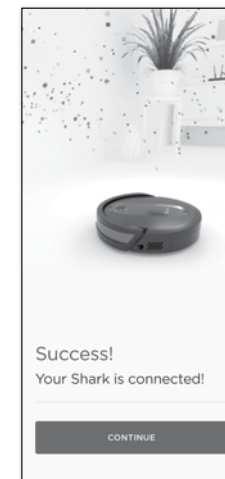

STEP 3 Select Robot (Apple iOS Only)

- Exit the app and open Wi-Fi settings.
- Select your robot (Ex. Shark_RVXXX) from the menu.
- Exit settings and return to the SharkClean app.

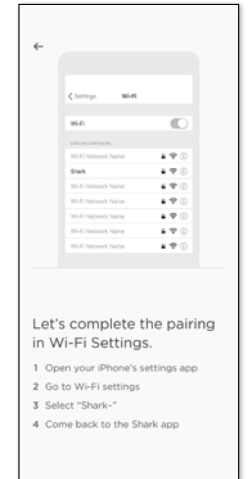

Questions?

CAN'T CONNECT?

- Restart your phone**
Reboot your robot
- Make sure the power switch on the back of the BASE is in the ON position.
 - Press the power button on the side of the ROBOT to the OFF position for 10 seconds, then press it again to turn power back ON.
- Reboot your router**
- Unplug the router power cable for 30 seconds, then plug it back in. Allow several minutes for your router to reboot completely.

Two Easy Steps If You're Stuck: Having trouble connecting to your robot? Call **1-888-228-5531** for robot support.

For additional help, visit: **sharkclean.com/support**

- How-to Videos
- FAQs
- Troubleshooting
- Tips & Tricks

Smart Home Setup
 To set up voice control using Google Home or Amazon Alexa, visit **sharkclean.com/app** for instructions.