

SETUP

STEP 1 PREP THE ROBOT

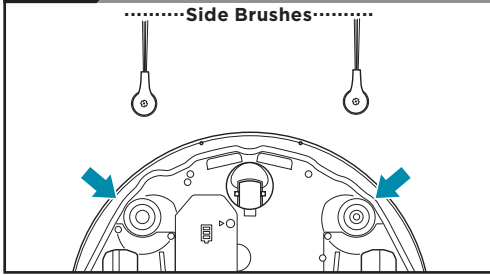

- Remove protective film from robot and base.
- **Attach the side brushes to the posts on the bottom of the robot.**

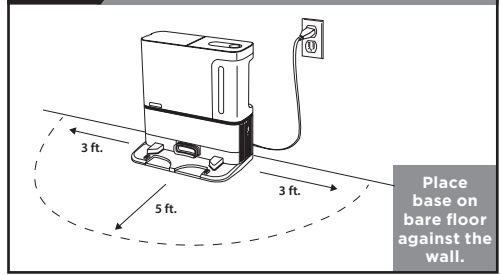

STEP 2 SET UP THE SELF-EMPTY BASE

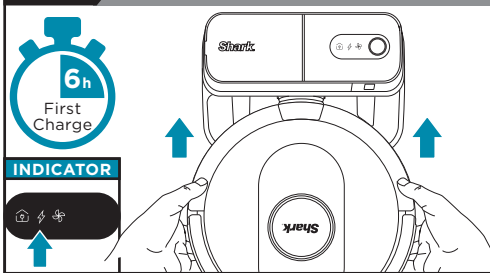

- Find a **permanent** location for the base in a central area with a **strong Wi-Fi signal**.
- Remove any objects that are closer than 3 ft. from either side of the base, or closer than 5 ft. from the front.
- Plug in the base. **The Base Power Indicator Icon**  on the top right side of the base will illuminate when the base has power. Make sure the power switch on the back of the base is in the (I) ON position.

STEP 3 CHARGING YOUR ROBOT



- Place robot on base to charge for **6 hours**.
- When the robot is properly aligned with its **BACK** against the base, the **Charging Icon**  on the top right side of the base will illuminate and the Battery icon  on the robot will illuminate.
- Make sure the robot is properly aligned on the **base**.
- **TO TURN ON ROBOT:** Place robot on base or press and hold the **CLEAN** button for 5 to 7 seconds until the indicator lights turn on.

STEP 4 PREP YOUR HOME

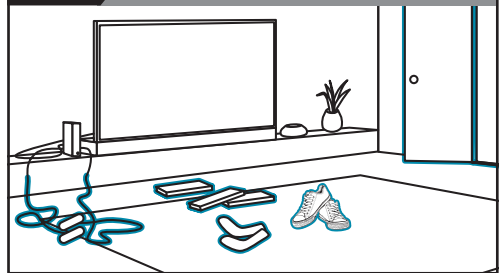

- Before cleaning, clear cords and remove small obstacles like clothing or toys that are less than 3.5" tall.
- **Open interior doors** in rooms you want your robot to clean.

STEP 5 DOWNLOAD THE SHARKCLEAN APP TO UNLOCK YOUR BEST CLEAN

App Features

- ✓ UltraClean Mode™
- ✓ Spot Cleaning
- ✓ Scheduling
- ✓ No-Go Zones
- ✓ Room Select



NOTE: For more information on connecting your robot, see back page.

LIVING WITH YOUR ROBOT

Questions? For how-to videos, FAQs, troubleshooting, and tips & tricks, call **1-888-228-5531** for robot support or visit: sharkclean.com/AIRobotSE

CHECK BASE FILL LEVEL

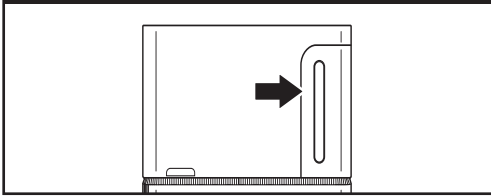

The dust bin is designed to hold up to 60 days of debris. During initial use, you may have to empty it more frequently while the robot finds more debris than usual. Check the fill level regularly to know when to empty.

AVOID MOVING THE ROBOT OR BASE

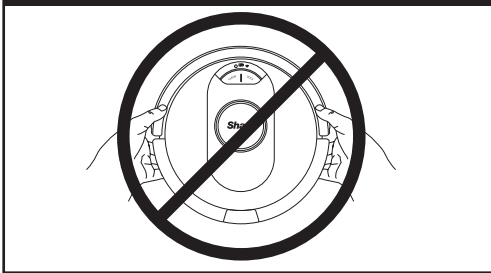

While your robot is cleaning, **DO NOT** pick it up and move it, or move the charging base—this will impact the robot's ability to map your home.

TROUBLESHOOTING

ERROR CODE	ERROR #	SOLUTION
CLEAN (RED) + ! (RED) alternating or CLEAN (WHITE) + ! (RED) flashing	2	Blockage in brushroll. Remove any debris from around and inside the brushroll so that it can spin freely.
DOCK (RED) + ! (RED) flashing	2	Side brush is stuck. Remove any debris from around the side brushes so they move freely.
CLEAN (RED) + DOCK (RED) + ! (RED) flashing	2	A drive wheel is stuck. Clean the wheels and remove any debris wrapped around the axles so they can move freely.
DOCK (RED) flashing	6	Front bumper may be jammed. Clean the bumper and make sure it moves in and out freely.
CLEAN (RED) + DOCK (WHITE) flashing	7	Cliff sensor error. Move your robot to a new location and clean its cliff sensors.
CLEAN (RED) flashing	10	Robot may be stuck on an obstacle. Move robot to a new location on a level surface.

DOORWAYS AND THRESHOLDS

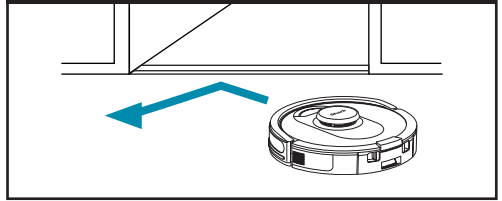

Your robot can easily climb over most thresholds, but if one is higher than 0.75", set up a no-go zone in the app to block it off.

CAN'T CONNECT TO WI-FI?



Restart your phone

- Turn off phone, wait a few minutes, then turn it back on and connect to Wi-Fi.

Reboot your robot

- Make sure the power switch on the back of the base is in the ON position.
- Take robot off base and press and hold down the CLEAN button on the robot for 12 seconds. Turn your robot back on by placing it on the base.

Reboot your router

- Unplug the router power cable for 30 seconds, then plug it back in. Allow several minutes for your router to reboot completely.

TROUBLESHOOTING

ERROR CODE	ERROR #	SOLUTION
BATTERY ICON (RED) flashing	24	Battery is critically low and needs recharging. Please pick up your robot and place it on the base. Make sure the charging indicator on the top right side of the base is illuminated to confirm your robot is placed on the base correctly.
DOCK (RED) FLASHING + ! (RED) solid	26	Blockage in dust bin. Check base and robot dust bin for clogs. Clear any debris and reinstall the dust bin, ensuring that it clicks into place.

WARNINGS

To minimize the risk of the robot traveling beyond an unsafe boundary (stair/cliffs edges, fireplaces, water hazards), establish these areas as "no-go zones" using the mapping feature in the SharkClean™ mobile app. Upon setting the boundary, run the vacuum and visually confirm that the settings effectively prevent the robot from passing beyond the set boundary. Adjust settings as necessary. **DO NOT** put hands into any opening in the dock or robot.