

connect AIR

Bluetooth Wireless Audio Transmitter
for AirPods® and Other Headphones

SETUP GUIDE



Scan QR code or enter the URL
below into your web browser:
MEEaudio.com/CA1vid

POWERED BY



Qualcomm® aptX™
Low Latency

Product Overview

3.5 MM AUDIO CONNECTOR

Plug into an in-flight entertainment system or other 3.5 mm audio source

BATTERY INDICATOR LIGHTS

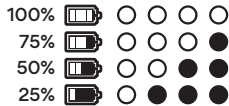

USB-C CHARGING PORT

Plug the charging cable into the Connect Air and a USB charging port

Charging time: 2 hours

HEADPHONE INDICATOR LIGHTS

Blue & Red Alternating



Bluetooth Pairing Mode

Blinking Blue



Standby, Ready to Connect

Solid Blue



Connected

MULTIFUNCTION BUTTON

Power On: HOLD 2 seconds

Bluetooth Pairing Mode: PRESS 2X

Check Battery Status: PRESS 1X

Power Off: HOLD 2 seconds

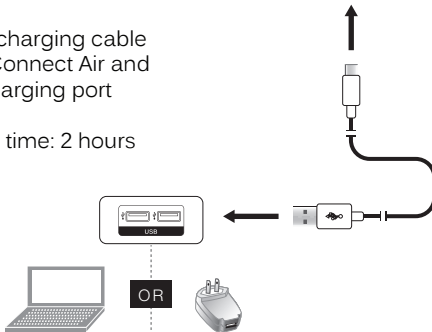

Getting Started

To pair the Connect Air with your device, put them in pairing mode simultaneously. Once they are both in pairing mode, they will pair and connect. Once connected, the Connect Air indicator light will turn blue.

STEP 1 - Put Your Headphones / Speakers in Pairing Mode



AirPods

Place AirPods in charging case

Open charging case lid

Press and hold the button on the back of the charging case until the light on the case flashes white

Note: Once paired, AirPods charging case light turns solid green

Other Headphones / Speakers

Consult the user manual of your Bluetooth headphones or speakers for instructions on putting them into pairing mode

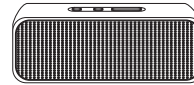

STEP 2 - Put the Connect Air in Pairing Mode

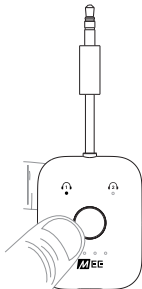

Press and hold the multifunction button for 2 seconds to power on

Double press the multifunction button to put the Connect Air in pairing mode

Once the Connect Air is in pairing mode, alternating red and blue lights will flash

The pairing process is complete once the indicator light on the Connect Air turns solid blue



PAIRING A 2ND HEADPHONE (OPTIONAL)

The Connect Air allows up to two Bluetooth devices to be connected at the same time. After connecting the first device, repeat the pairing steps to connect a second.

Note: Once the second device is connected, both headphone lights on the Connect Air will be solid blue.

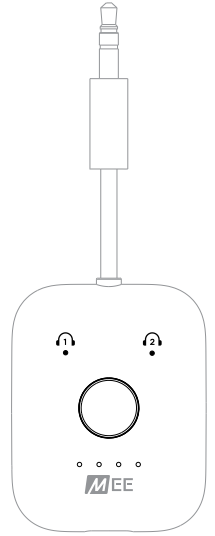

SUBSEQUENT USE

The Connect Air will automatically reconnect to previously paired headphones or speakers.

To reconnect, power on your headphones or speakers first, then power on the Connect Air. A solid blue headphone light on the Connect Air indicates that a connection has been established.

Connecting to Audio Source

3.5 MM AUDIO CONNECTOR

Plug the Connect Air into an in-flight entertainment system or any other 3.5 mm audio source

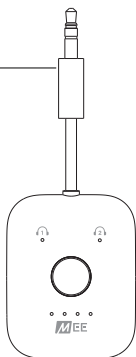

Increase volume on the entertainment system if necessary, then use volume controls on your headphones (if available) to adjust volume.

Troubleshooting

Most issues can be solved by powering the Connect Air off and then back on. When reconnecting a set of previously-paired headphones, power on the headphones first, then power on the Connect Air.

FACTORY RESET

A factory reset can be used to delete all previous Bluetooth pairings from memory.

To perform a factory reset, make sure the Connect Air is powered on, then press the multifunction button 6 times until both blue lights flash momentarily.

The Connect Air will then go into pairing mode, as indicated by the red and blue flashing lights.

All previously paired devices will be cleared from memory and a new pairing will need to be created.

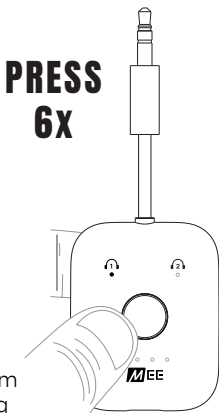

FOR ADDITIONAL SUPPORT

VIEW OUR VIDEO SETUP GUIDE

Scan QR code or enter the URL
below into your web browser:

MEEaudio.com/CA1Vid



QUESTIONS? WE'RE HERE TO HELP!

Phone Support: 626-965-1008
Monday ~ Friday 9:00 am to 5:00 pm PST

Email Support: support@MEEaudio.com
All emails are responded to within 2 business days



POWERED BY

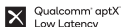

MEE audio and its logo are registered trademarks of S2E, Inc. All rights reserved.

The Bluetooth® word mark and logos are registered trademarks owned by Bluetooth SIG, Inc. and any use of such marks by MEE audio is under license. Other trademarks and trade names are those of their respective owners.

Qualcomm aptX is a product of Qualcomm Technologies, Inc. and/or its subsidiaries. Qualcomm is a trademark of Qualcomm Incorporated, registered in the United States and other countries. aptX is a trademark of Qualcomm Technologies International, Ltd., registered in the United States and other countries.

Apple and AirPods are trademarks of Apple Inc., registered in the U.S. and other countries

WARRANTY

MEE audio products purchased from authorized resellers are covered by a 1-year manufacturer warranty. For more information, contact your local MEE audio dealer or visit MEEaudio.com/Support

COMPLIANCE INFORMATION

This device complies with part 15 of the FCC Rules. Operation is subject to the following two conditions: (1) This device may not cause harmful interference, and (2) this device must accept any interference received, including interference that may cause undesired operation.

FCC RULES

This equipment has been tested and found to comply with the limits for a Class B digital device, pursuant to part 15 of the FCC Rules. These limits are designed to provide reasonable protection against harmful interference in a residential installation. This equipment generates, uses and can radiate radio frequency energy and, if not installed and used in accordance with the instruction manual, may cause harmful interference to radio communications.

However, there is no guarantee that interference will not occur in a particular installation. If this equipment does cause harmful interference to radio or television reception, which can be determined by turning the equipment off and on, the user is encouraged to try to correct the interference by one or more of the following measures:

- Relocate the receiving antenna.
- Increase the separation between equipment and receiver.
- Connect the equipment into an outlet on a circuit different from that to which the receiver is connected.
- Consult the dealer or an experienced radio/TV technician for help.

DISPOSAL AND RECYCLING

Dispose of this product in accordance with all local laws and regulations. Because this product contains electronic components and a battery, it must be disposed of separately from household waste. Contact local authorities to learn about disposal and recycling options.

WARNINGS

Using headphones at high volumes for extended periods of time will result in permanent hearing damage. It is advised you keep volume levels moderate to low at all times for your safety. Turn the volume all the way down after connecting your earphones, then gradually increase the volume until you reach a comfortable listening level. Do not use headphones while driving a car, cycling, operating machinery, or performing other activities that require hearing surrounding sounds.

Keep the device and packaging out of reach of children.

This device is designed and manufactured to operate within its defined design limits. Misuse may result in electric shock or fire. Read and follow these instructions carefully.

- If submersed in water, do not turn the device on until completely dried. Note: liquid submersion voids the warranty.
- Danger of explosion or fire if batteries are damaged. Keep away from direct sunlight, naked flames, flammable gasses, or heat sources such as radiators or stoves
- Battery performance will be severely decreased when stored in extreme temperatures: below -10°C/14°F or above 45°C/113°F including direct sunlight
- Do not use around flammable gasses as fire or explosion may occur.
- There are no user replaceable/repairable parts in the device. Disassembling it will void your warranty.
- Only use attachments/accessories specified by the manufacturer

Changes or modifications to this unit not expressly approved by MEE audio could void the user's authority to operate the equipment.

NEED HELP? VIEW OUR VIDEO SETUP GUIDE

Scan QR code or enter the URL
below into your web browser:

MEEaudio.com/CA1Vid



connect AIR

Bluetooth Wireless Audio Transmitter
for AirPods® and Other Headphones