

# USER MANUAL

HD WIRELESS SOUND FOR YOUR HDTV

# DUALSTREAM

UNIVERSAL DUAL BLUETOOTH

WIRELESS AUDIO TRANSMITTER

For Headphones and Speakers

Model: AF-S1



**DUALSTREAM**

---

**QUESTIONS?  
WE'RE HERE TO HELP!**

**Phone Support:** 626-965-1008 x31  
Monday ~ Friday 9am to 5:30pm PST

**Email Support:** [support@MEEaudio.com](mailto:support@MEEaudio.com)  
All emails are responded to within 2 business days

---



## PACKAGE CONTENTS

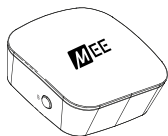

**DUALSTREAM**  
Bluetooth  
Transmitter

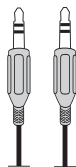

3.5mm  
audio  
cable



Micro-USB  
power  
cable

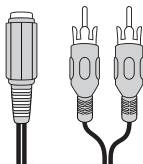

3.5mm to  
RCA  
adapter

## LED INDICATOR LIGHTS

The status of the **DUALSTREAM** is shown by a green power / charging indicator light on the rear of the unit and two blue indicator lights on the top as follows:

INDICATOR LIGHT (S)	DEVICE STATUS
Green power indicator light on	Powered on
Green power indicator light off	Powered off or power not connected
Blue light blinking	Pairing mode active
One solid blue light	One Bluetooth device is connected
Two solid blue lights	Two Bluetooth devices are connected

## FACTORY RESET / CLEAR MEMORY

To perform a factory reset of the **DUALSTREAM**, hold pairing button “A” for approximately 5 seconds until the blue indicator light stops blinking.

All previously paired devices will be cleared from memory and a new pairing will need to be created by following the procedure in STEP **2**.

## SAFETY AND CARE

- Clean with a soft, slightly damp cloth. Do not use chemical cleaners.
- There are no user replaceable/repairable parts in this device. Disassembling it will void your warranty.
- Do not expose the device to liquids. If the device comes in contact with liquids, quickly wipe away. If submersed in water, do not turn the device on until completely dried. Note: liquid submersion voids the warranty.
- Do not use around flammable gases as fire or explosion may occur

# WARNING

Using headphones at high to moderate volumes for extended periods of time will result in permanent hearing damage. It is advised you keep volume levels moderate to low at all times for your safety. Do not use while driving a car, cycling, operating machinery, or performing other activities that require hearing surrounding sounds.

Keep the device and packaging out of reach of children.

# WARRANTY

MEE audio products purchased from authorized resellers are covered by a 1-year manufacturer warranty. Please retain a copy of your receipt as proof of purchase.

For more information, visit [www.MEEaudio.com/Support](http://www.MEEaudio.com/Support)



---

MEE audio and its logo are registered trademarks of S2E, Inc. All rights reserved.

The Bluetooth® word mark and logos are registered trademarks owned by Bluetooth SIG, Inc. and any use of such marks by MEE audio is under license. Other trademarks and trade names are those of their respective owners.

Qualcomm® aptX™ is a product of Qualcomm Technologies International, Ltd. Qualcomm is a trademark of Qualcomm Incorporated, registered in the United States and other countries, used with permission. aptX is a trademark of Qualcomm Technologies International, Ltd., registered in the United States and other countries, used with permission.

# 1

## PLUG IN USB POWER CABLE

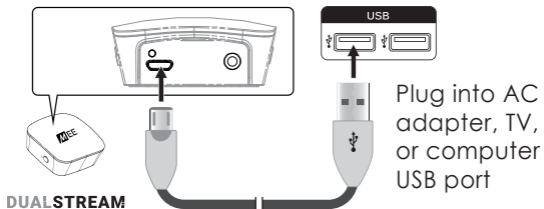

---

## POWER ON TRANSMITTER

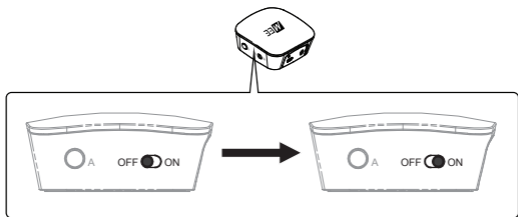

# 5

## ADJUSTING HEADPHONE VOLUME

Volume can be individually adjusted on each headphone or speaker paired with the **DUALSTREAM**.

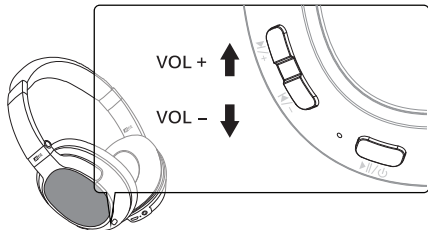

**WHEN FINISHED, POWER OFF HEADPHONES UNTIL NEXT USE**

---

### SUBSEQUENT USE

To reconnect a previously paired headphone or speaker, power on the **DUALSTREAM** first (if powered off) and then power on the headphone or speaker. A solid blue light on the **DUALSTREAM** will indicate that a connection has been established. It may take up to 60 seconds for audio transmission to begin.



## PAIR A 2ND HEADPHONE OR SPEAKER (OPTIONAL)

A second Bluetooth audio device can be paired after one is already connected.

To pair the second device, put it in pairing mode\*, then tap pairing button "B" on the **DUALSTREAM**.



Once the **DUALSTREAM** and your device are both in pairing mode simultaneously and within 3 ft (1m) of each other, they will be paired.

PAIRING: LIGHT BLINKS

CONNECTED: SOLID LIGHT

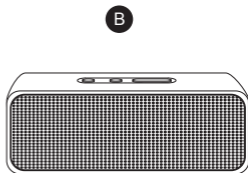
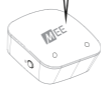
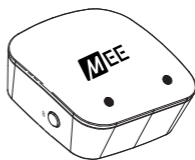
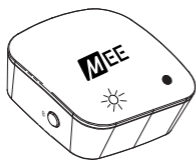

\*CONSULT THE USER MANUAL OF YOUR DEVICE IF YOU ARE NOT SURE HOW TO PUT IT IN PAIRING MODE

NOTE: SOUND MAY BE QUIET OR INTERMITTENT WHILE PAIRING IS IN PROGRESS.

## 4. CHOOSE AN AUDIO CABLE SUPPORTED BY YOUR TV

### RCA

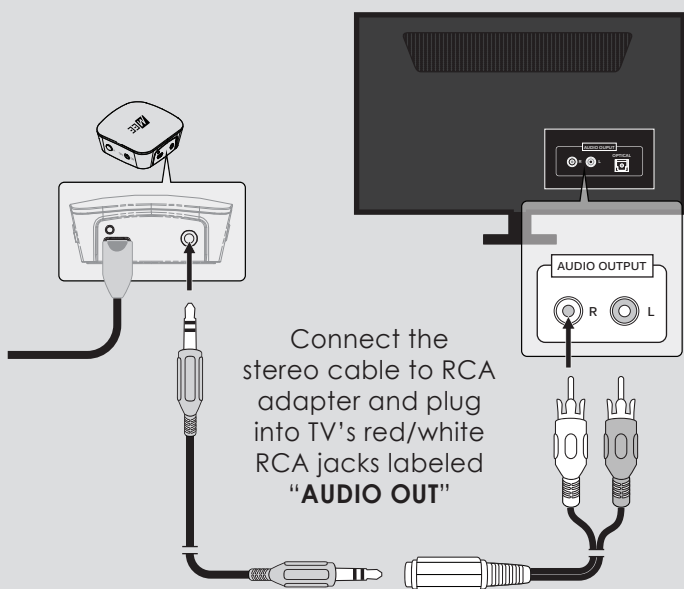

**IF TV AUDIO PLAYS FROM HEADPHONE, SETUP IS COMPLETE. PROCEED TO STEP 5.**

**NO SOUND? CHECK TV SETTINGS MENU.†**

Select "Variable" in the audio output settings menu of your TV

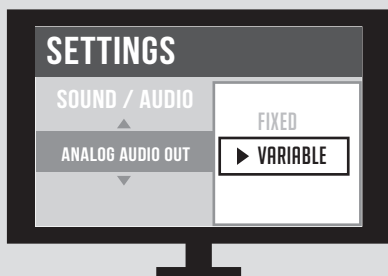

Set TV's internal speakers to "OFF"

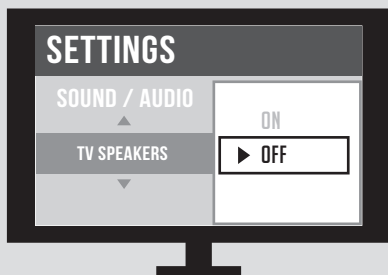

**PROCEED TO STEP 5**

†EXACT MENU AND ITEM NAMES MAY VARY BETWEEN TVS

# 4. CHOOSE AN AUDIO CABLE SUPPORTED BY YOUR TV

## 3.5MM [HEADPHONE JACK]

Maximize the volume on your TV

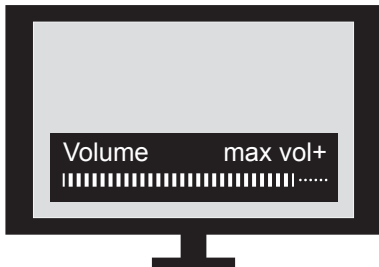

Plug the stereo cable into TV's headphone jack

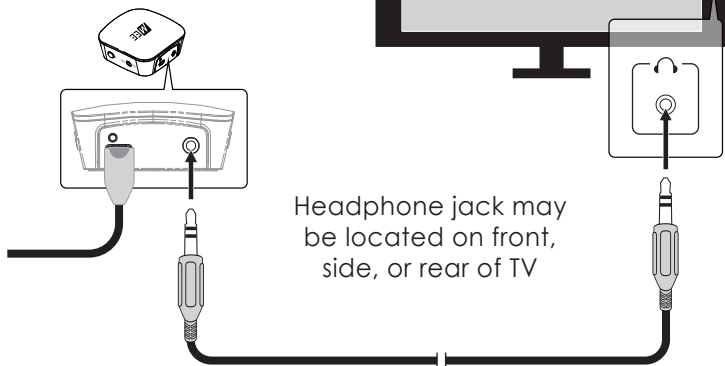

Headphone jack may be located on front, side, or rear of TV

## 2

### PAIR A BLUETOOTH HEADPHONE OR SPEAKER

Put your headphone or speaker in pairing mode\*

Tap pairing button "A" on the **DUALSTREAM**.

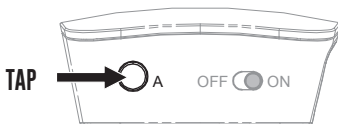

Once the **DUALSTREAM** and your device are both in pairing mode simultaneously and within 3 ft (1m) of each other, they will be paired.

**PAIRING: LIGHT BLINKS**

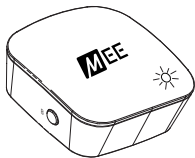

**CONNECTED: SOLID LIGHT**

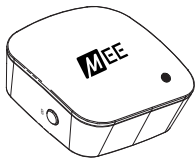

\*CONSULT THE USER MANUAL OF YOUR DEVICE IF YOU ARE NOT SURE HOW TO PUT IT IN PAIRING MODE

NOTE: SOUND MAY BE QUIET OR INTERMITTENT WHILE PAIRING IS IN PROGRESS.