

QUICK START GUIDE

Dog Training Collar

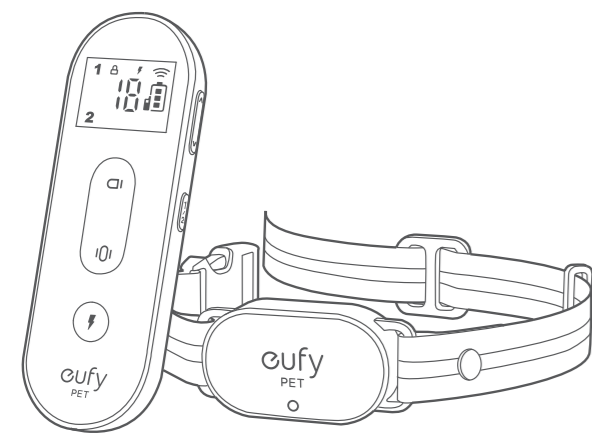

1 / IMPORTANT SAFETY INFORMATION

- Your dog must be at least 6 months old to use this product.
- Never use this product to reduce or stop aggressive behavior. Consult a professional trainer instead.
- Wearing a collar that is too tight or for a long time (more than 12 hours a day) might damage your dog's skin.

2 / PRODUCT OVERVIEW

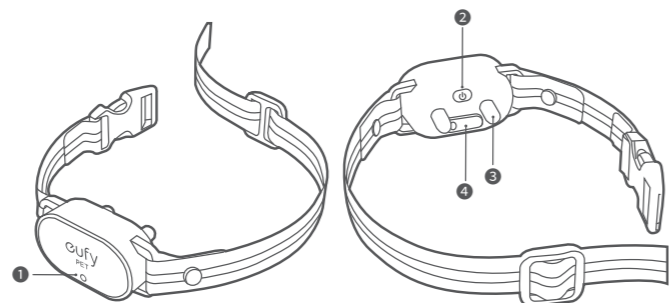

- 1 LED Indicator
2 Power Button:
• Press and hold for 1 second to power on.
• Press and hold for 3 seconds to power off.
- 3 Connectors
4 Charging Port (with cover)

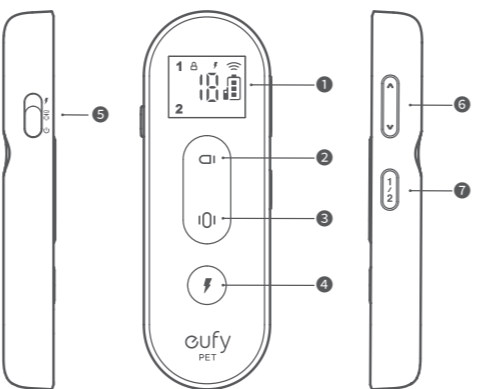

- 1 Display: Shows dog channel, shock level, and battery level.
2 Beep Button
3 Vibration Button
4 Shock Button
5 Mode Switch
• Beep, vibrate, and shock
• Beep and vibrate
• Power off
6 Shock Level + / -
7 Dog Channel Switch

3 / CHARGING

Charge the collar for 4 hours before first use:

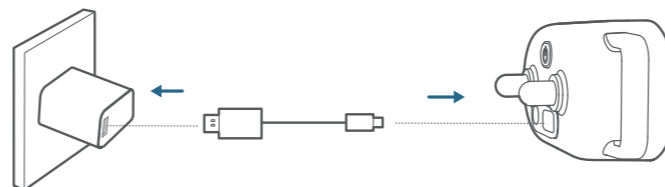

LED Indicator	Description
Blue	Fully charged / Tone or vibration button pressed.
Red	Charging / Shock button pressed / Powering off.
Flashing blue	Working properly.
Flashing red	Low battery.
Off	Sleep mode / Powered off.

Charge the remote controller:

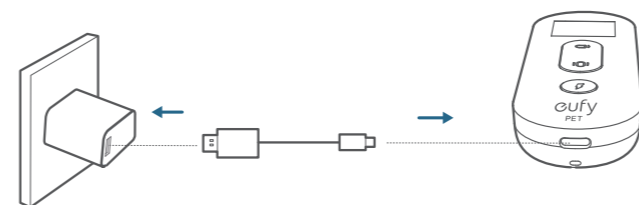

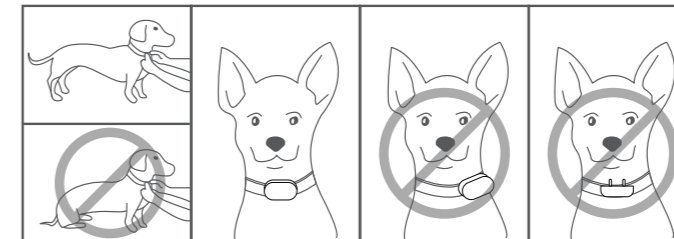

4 / WEARING COLLAR FOR YOUR DOG



Collar Colors	Dog Channel
Blue and purple	1
Orange (for E7250)	2

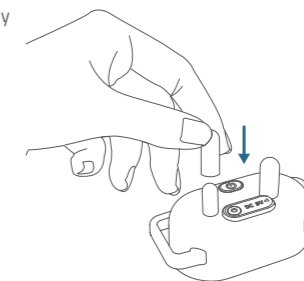



Make sure both connectors properly contact the neck. Add the provided connector extensions if necessary.

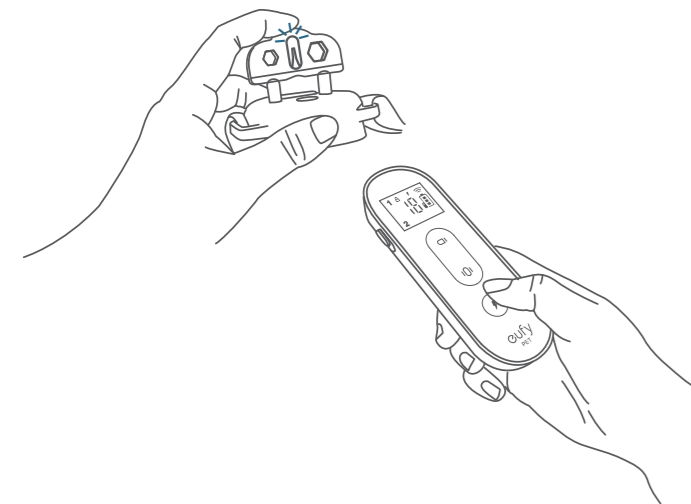

 To verify the shock works properly, use the provided shock testing tool. Press the **Shock** button and check the light. It will get brighter as you increase the shock level and darker as you decrease the shock level.

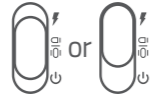

5 / TRAINING YOUR DOG

Button	Mode Switch	When Pressed
		The collar plays a beep sound.
		The collar vibrates. *The vibration will stop automatically if you hold the button for more than 10 seconds.
		The collar delivers an electric shock to the dog, ranging from level 1 to 16. *The electric shock will stop automatically if you hold the button for more than 10 seconds.

 **Find an appropriate shock level.**

- Always start with the lowest level.
- The appropriate shock level can be found when your dog responds to the shock with a mild reaction, such as tensing the muscles in the neck.
- The shock level also varies depending on the trainings you deliver. For a training that requires high concentrations, your dog might need a shock of higher level.

6 / NOTICE

FCC Statement

This device complies with Part 15 of the FCC Rules. Operation is subject to the following two conditions: (1) this device may not cause harmful interference, and (2) this device must accept any interference received, including interference that may cause undesired operation.

Warning: Changes or modifications not expressly approved by the party responsible for compliance could void the user's authority to operate the equipment.

Note: This equipment has been tested and found to comply with the limits for a Class B digital device, pursuant to Part 15 of the FCC Rules. These limits are designed to provide reasonable protection against harmful interference in a residential installation.

This equipment generates, uses and can radiate radio frequency energy and, if not installed and used in accordance with the instructions, may cause harmful interference to radio communications. However, there is no guarantee that interference will not occur in a particular installation. If this equipment does cause harmful interference to radio or television reception, which can be determined by turning the equipment off and on, the user is encouraged to try to correct the interference by one or more of the following measures: (1) Reorient or relocate the receiving antenna. (2) Increase the separation between the equipment and receiver. (3) Connect the equipment into an outlet on a circuit different from that to which the receiver is connected. (4) Consult the dealer or an experienced radio / TV technician for help.

RF warning statement:

The device has been evaluated to meet general RF exposure requirement. The device can be used in portable exposure condition without restriction.

Notice: Shielded cables

All connections to other computing devices must be made using shielded cables to maintain compliance with FCC regulations. The following importer is the responsible party.
Company Name: POWER MOBILE LIFE, LLC
Address: 10900 NE 8TH ST, STE 501, BELLEVUE, WA 98004
Telephone: 1-800-988-7973

IC Statement

This device complies with Industry Canada licence-exempt RSS standard(s). Operation is subject to the following two conditions:
(1) this device may not cause interference, and
(2) this device must accept any interference, including interference that may cause undesired operation of the device.

Le présent appareil est conforme aux CNR d'Industrie Canada applicables aux appareils radio exempts de licence. L'exploitation est autorisée aux deux conditions suivantes:
(1) l'appareil ne doit pas produire de brouillage, et
(2) l'utilisateur de l'appareil doit accepter tout brouillage radioélectrique subi, même si le brouillage est susceptible d'en compromettre le fonctionnement.

This Class B digital apparatus complies with Canadian ICES-003.
Cet appareil numérique de la classe B est conforme à la norme NMB-003 du Canada.

Radiation Exposure Statement:

This equipment complies with IC radiation exposure limits set forth for an uncontrolled environment. The device can be used in portable exposure condition without restriction. This equipment can be used in portable exposure condition without restriction.

Déclaration d'exposition aux rayonnements :

Cet équipement est conforme aux limites d'exposition aux rayonnements IC définies pour un environnement non contrôlé. L'appareil peut être utilisé dans des conditions d'exposition portable sans restriction. Cet équipement peut être utilisé dans des conditions d'exposition portable sans restriction.

CUSTOMER SERVICE

Warranty

12-month limited warranty

Call Us

United States

+1 (800) 988 7973

Mon-Fri 9AM-5PM (PT)

United Kingdom

+44 (0) 1604 936 200

Mon-Fri 6AM-11AM (GMT)

Germany

+49 (0) 69 9579 7960

Mon-Fri 6:00-11:00

Email Us

Customer Support: support@eufylife.com

Anker Innovations Limited

Room 1318-19, Hollywood Plaza, 610 Nathan Road, Mongkok, Kowloon, Hong Kong

 @EufyOfficial

 @EufyOfficial

 @EufyOfficial