

PHILIPS

NORELCO



6955XL
6947XL
6945XL

**Rechargeable Cordless/Cord
Tripleheader Razor**

BC

Always here to help you

Register your product and get support at
www.norelco.com/register

Question?
Contact
Philips
Norelco

6955XL/6947XL/6945XL

ENGLISH 4

Congratulations on your purchase and welcome to Philips Norelco!

To fully benefit from the support that Philips Norelco offers, register your product at www.norelco.com/register

IMPORTANT SAFETY INSTRUCTIONS

When using an electric appliance, basic precautions should always be followed, including the following:

Read all instructions before using this appliance.

DANGER

To reduce the risk of electric shock:

1. Do not reach for a corded razor that has fallen into water. Unplug immediately.
2. Do not use razor while bathing or in a shower.
3. Do not place or store a razor where it can fall or be pulled into a tub or sink. Do not place or drop a razor into water or other liquid.
4. Always unplug this razor from the electrical outlet immediately after use, except when razor is (re)charging.
5. Unplug and remove power supply cord from razor before cleaning.

WARNING

To reduce the risk of burns, fire, electric shock, or injury to persons:

1. Close supervision is necessary when this razor is used by, on, or near children or invalids.
2. Use this razor for its intended household use as described in this manual. Do not use attachments not recommended by Philips Electronics North America Corporation.
3. Never operate this razor if it has a damaged cord or charging plug, if it is not working properly, if it has been dropped or damaged, or dropped into water while plugged in. For assistance call 1-800-243-3050.
4. Keep the razor, cord and charging plug away from heated surfaces.

5. Never drop or insert any object into any opening.
6. Do not charge or plug in razor outdoors or operate where aerosol (spray) products are being used or where oxygen is being administered.
7. Do not use this razor with a damaged or broken comb, as facial injury may occur.
8. For corded use, always attach plug to razor first, then to outlet. Be certain plug is inserted firmly into razor up to mark indicated on plug. To disconnect, turn razor off then remove charging plug from outlet.
9. Never put the razor in direct sunlight or store at a temperature above 140°F (60°C).
10. To prevent possible damage to the cord, do not wrap cord around the razor.
11. Only use the power plug supplied with the razor.

SAVE THESE INSTRUCTIONS

IMPORTANT: The power plug contains a transformer. Do not cut off the power plug to replace it with another plug, as this will cause a hazardous condition.

PHILIPS

 NORELCO**45 - DAY MONEY-BACK GUARANTEE**

To enjoy the closest and most comfortable shave from your new Philips Norelco Men's Razor, the razor should be used **exclusively** for 3 weeks. This allows your hair and skin enough time to adapt to the Philips Norelco Shaving System. If, after that period of time, you are not fully satisfied with your Philips Norelco Men's Razor, send the product back along with dated sales receipt and we'll refund you the full purchase price. **The razor must be shipped prepaid by insured mail, insurance prepaid, have the original sales receipt, indicating purchase price, the date of purchase, and the money-back guarantee return authorization form enclosed. We cannot be responsible for lost mail.** The razor must be postmarked no later than 45 days from the date of purchase. Philips Norelco reserves the right to verify the purchase price of the razor and limit refunds not to exceed suggested retail price.

To obtain money-back guarantee return authorization form, call 1-800-243-3050 for assistance. Delivery of refund check will occur 6-8 weeks **AFTER** receipt of refund product.

Table of Contents

Features	8-9
Before First Use	10
Charging	10-11
Recharging.....	11
Put It To The Test & Shaving Tips.....	12
How to Shave With An Electric Razor	12-13
Trimming	13
Cleaning.....	14-17
Replacing Razor Heads.....	18
Storage.....	18
Assistance	18
Battery Removal	19-20
Accessories	20
Warranty.....	21

Features

Razor Head
Assembly

Protective Cap

Individually
Floating Heads

Razor Head Release
Button

- Hair Chamber captures shaven hair

ON/OFF Switch

Charging Light

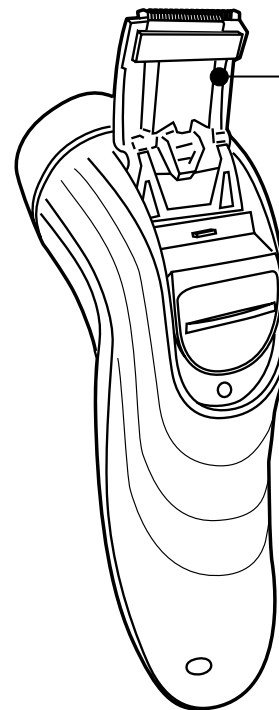
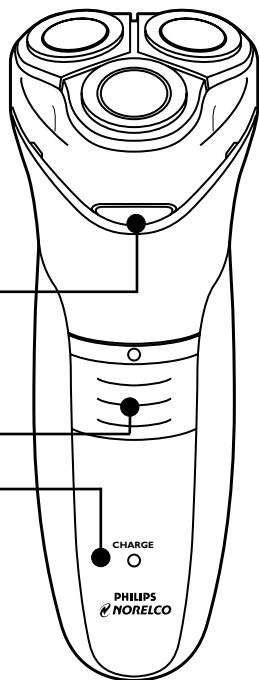

Full Width Pop-Up
Trimmer (6955XL)

Automatic
Worldwide Voltage
100V to 240V AC

Cleaning Brush

Rechargeable-
8-hour full charge
for up to
30 minutes
cordless use

Corded or cord
free use

Full 2-Year
Warranty

45-Day Money-
Back Guarantee

Before First Use

- ▶ Charge the razor before you start using it (see 'Charging'). Make sure the razor is switched off before you start charging it.

Important

- ▶ Only use the power cord provided to charge the razor.

Charging

- ▶ Battery performance is best if you recharge only when the batteries are (almost) completely empty.
- ▶ Charging or recharging at temperatures below 40°F and higher than 95°F adversely affects lifetime of batteries.
- ▶ Continuously recharging or continuously using as a corded razor will reduce life of batteries.
- ▶ You may also shave using the power cord provided. This razor will not recharge while being used corded.
- ▶ Charging and recharging requires a full 8 hours.
- ▶ If razor has not been used for at least 1 month, razor must be recharged for 8 full hours.

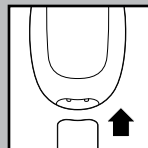

- 1 Connect cord directly to razor. Connect the charging plug into any 100V to 240V AC outlet. Use only the power cord provided.

- ▶ An adaptor plug may be necessary for charging plug usage in some foreign countries. Use an attachment plug adaptor of the proper configuration for the power outlet.

The razor will automatically convert to work on 100V to 240V AC systems.

- ▶ As you charge razor, the Charging Light will light up to indicate razor is charging.

- 2 Charging and recharging requires 8 full hours. A fully charged razor has a cordless shaving time of up to 30 minutes.

Recharging

- 1 Recharging requires 8 hours.
- 2 When razor is fully charged, disconnect the charging plug from outlet. Do not keep razor permanently plugged into outlet.

Put It To The Test & Shaving Tips

- ▶ 21 Day Trial and Conversion Process. It is a fact that your skin and beard need time to adjust to any new shaving system.
- ▶ Use your new razor exclusively for 3 weeks to fully enjoy the closeness of a Philips Norelco shave.
- ▶ At first you may not get as close a shave as you expect, or your face may even become slightly irritated. This is normal since your beard and skin will need time to adjust. Invest 3 weeks and you'll soon experience the full joy of your new razor.
- ▶ Stick with it! If you alternate shaving methods during the adjustment period, it may make it more difficult to adapt to the Philips Norelco shaving system.
- ▶ If you are not convinced after 21 days, Philips Norelco will refund you the full purchase price as long as the request is received within 45 days of purchase.

How To Shave With An Electric Razor

- ▶ Use this razor for its intended household use as described in this manual.
 - ▶ Shaving with a clean, dry face gives the best results.
- 1** Turn razor to ON (1) position. Shave against the direction of beard growth using both straight and circular movements.

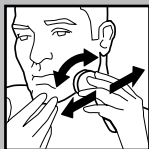

- 2** Stretch your skin with your free hand so blades can cut whiskers. Gently press razor to skin, so the floating heads can follow the contours of your face. **DO NOT** press too hard. Too much pressure can pinch the skin into the heads.

- 3** Turn razor to OFF (O) position.

- 4** Put the protective cap on the razor to protect razor heads.

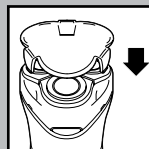

Replace your Philips Norelco razor heads (model # HQ56) once a year for optimal shaving results.

Trimming (6955XL)

To groom sideburns and moustache:

- 1** Turn razor to ON (1) position.

- 2** Push up trimmer slide switch.

The trimmer can be activated while the razor is running.

- 3** Hold trimmer as shown and move in downward strokes with gentle pressure.

- 4** Close trimmer by sliding trimmer switch down.

- 5** Turn razor to OFF (O) position.

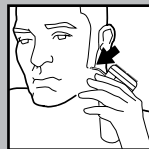
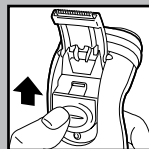

Cleaning

Once a week: Razor

- ▶ Always clean your razor after each use.
- ▶ Regular cleaning guarantees better shaving results.
- ▶ Always switch razor OFF, unplug and remove power cord before cleaning.
- ▶ Never clean, remove or replace head assembly while motor is on.
- ▶ Do not apply pressure to shaving head combs. Do not touch razor heads with hard objects as this may dent or damage precision-made slotted combs.
- ▶ Do not use razor if combs are damaged or broken. Facial injury may occur.
- ▶ Do not use abrasives, scourers or aggressive liquids such as gasoline or acetone to clean the razor.

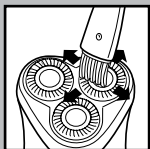

- 1** Clean the top of the razor with the supplied brush.

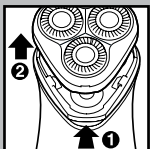

- 2** Press the Razor Head Release Button (1) and remove Razor Head Assembly from the razor unit (2).



- 3** Brush out hairs from the inside of Razor Head Assembly and hair chamber.

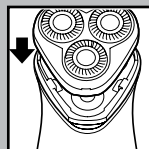

- 4** Replace the Razor Head Assembly back on razor.

Every Two Months: Razor Head

Do not mix up the cutters and combs as the shaving performance may be adversely affected for several weeks before optimal shaving performance is restored.

- 1** Turn razor to OFF (O) position and disconnect from outlet.

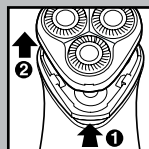

- 2** Press the Razor Head Release Button (1) and remove Razor Head Assembly from the razor unit (2).



- 3** Brush the inside of the razor housing.

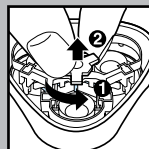

- 4** Turn Razor Head Assembly over so that underside is exposed.

- 5** Turn wheel of frame counterclockwise.

- 6** Remove the frame and brush clean.

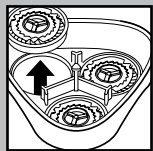

- 7** Remove and clean one cutter and comb at a time.

Do not clean more than one cutter and comb at a time, since they are all matching sets. If you accidentally interchange the cutters and combs, it could take several weeks before optimal shaving performance is restored.

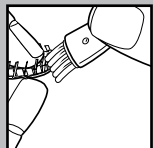

- 8** Separate the cutter from the comb.
- 9** Only brush the cutter in an upward motion. Use the short bristled side of the brush.

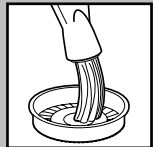

- 10** Brush the slots of the comb.
For optimum performance, razor cutters and combs should be cleaned in a degreasing liquid (e.g. Philips Norelco Shaving Head Cleaning Spray, model HQ110 or alcohol). This helps prevent wear of the shaving heads.

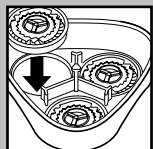

- 11** Replace the cutter and comb into the Razor Head Assembly.
- 12** Repeat the process for the other two sets of cutters and combs.

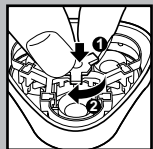

- 13** Replace the frame.
- 14** Turn the wheel clockwise until it locks into place.

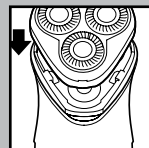

- 15** Replace the Razor Head Assembly back on razor.
- 16** Put the protective razor head cap on the razor to protect heads.

After Each Use: Trimmer (6955XL)

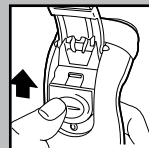

- 1** Turn razor to OFF (O) position.
- 2** Push trimmer slide switch up to pop up trimmer.

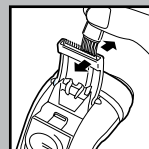

- 3** Clean trimmer with the brush every time you use it.

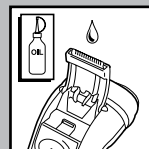

- 4** Lubricate the trimmer teeth with one drop of mineral oil every 6 months.
- 5** Close trimmer by sliding trimmer switch down.

This razor has no other user-serviceable parts. For assistance call 1-800-243-3050.

Replacing the Razor Heads

- ▶ Replace the razor heads once a year for optimal shaving results.
- ▶ Replace damaged or worn razor heads with model HQ56 Philips Norelco razor heads only.

Storage

- ▶ Be sure razor is turned off. Remove cord from outlet and razor before storing in a safe, dry location where it will not be crushed, banged, or subject to damage.
- ▶ Do not wrap power cord around razor when storing.
- ▶ Store cord in a safe location where it will not be cut or damaged.
- ▶ Do not place or store razor where it can fall or be pulled into a tub or sink, water or other liquid while plugged in.
- ▶ Put the Protective Cap on razor to protect heads.

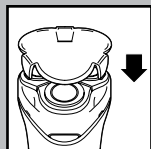

Assistance

- ▶ For assistance, visit our website:

**www.philips.com/support
or call toll free 1-800-243-3050**

- ▶ Online information is available 24 hours a day, 7 days a week.

Battery Removal

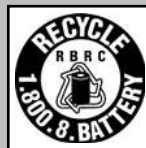

- ▶ This Philips Norelco razor contains a rechargeable Nickel Metal Hydride battery which must be disposed of properly.
- ▶ Battery should only be removed when razor is to be discarded.
- ▶ For assistance, visit our website, www.philips.com/support or call toll free: 1-800-243-3050.

- 1** Turn razor ON.
- 2** Allow razor to run until the battery is empty/depleted.
- 3** Turn razor OFF.
- 4** Use a screwdriver to remove the screws in the back of the razor and open it.
- 5** Cut the battery strips with a cutter and pull the battery loose from the glued strip. Be careful, the battery strips are very sharp.
- 6** Remove the rechargeable battery.
- 7** Do not attempt to replace battery. Insulate battery ends by covering with tape and/or place battery in a small plastic bag.
- 8** Discard your razor. Do not attempt to plug power cord into the outlet or recharge the razor after the battery has been removed.

- 9** Contact your local town or city officials for battery disposal information or call 1-800-8-BATTERY or www.rbrc.com for battery drop-off locations.

Accessories

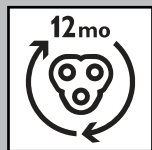

- ▶ **NOTE:** Model HQ5 Reflex Action Replacement Heads **DO NOT** fit this razor.
- ▶ **Replacement Heads**
Model HQ56 - For maximum razor performance, replace your Philips Norelco razor heads once a year.
- ▶ **Shaving Head Cleaning Spray**
Model HQ110 - Philips Norelco Shaving Head Cleaning Spray
- ▶ **Philips Norelco Razor Accessories** may be purchased at a store near you or on our website www.philips.com/store

FULL TWO YEAR WARRANTY

Philips Electronics North America Corporation warrants each new Philips Norelco Product, Model 6955XL/6947XL/6945XL (except cutters and combs) against defects in materials or workmanship for a period of two years from the date of purchase, and agrees to repair or replace any defective product without charge.

IMPORTANT: This warranty does not cover damage resulting from accident, misuse or abuse, lack of reasonable care, the affixing of any attachment not provided with the product or loss of parts or subjecting the product to any but the specified voltage.* Use of unauthorized replacement parts will void this warranty.

PHILIPS ELECTRONICS NORTH AMERICA CORPORATION WILL NOT PAY FOR WARRANTY SERVICE PERFORMED BY A NON-AUTHORIZED REPAIR SERVICE AND WILL NOT REIMBURSE THE CONSUMER FOR DAMAGE RESULTING FROM WARRANTY SERVICE PERFORMED BY A NON-AUTHORIZED REPAIR SERVICE. NO RESPONSIBILITY IS ASSUMED FOR ANY SPECIAL, INCIDENTAL OR CONSEQUENTIAL DAMAGES.

In order to obtain warranty service, simply go to www.philips.com/norelco or call 1-800-243-3050 for assistance. It is suggested that for your protection you return shipments of product by insured mail, insurance prepaid. Damage occurring during shipment is not covered by this warranty.

NOTE: No other warranty, written or oral, is authorized by Philips Electronics North America Corporation.

This warranty gives you specific legal rights, and you may also have other rights which vary from state to state. Some states do not allow the exclusion or limitation of incidental or consequential damages, so the above exclusion and limitations may not apply to you.

* Read enclosed instructions carefully.

Manufactured for:

Philips Consumer Lifestyle
A Division of Philips Electronics North America Corporation
P.O. Box 10313, Stamford, CT 06904



This symbol on the product's nameplate means it is listed by Underwriters' Laboratories, Inc.

Norelco and Tripleheader are Registered Trademarks of Philips Electronics North America Corporation.



is a Trademark of Philips Electronics North America Corporation.

PHILIPS is a Registered Trademark of Koninklijke Philips Electronics N.V.

© 2012 Philips Electronics North America Corporation. All Rights Reserved.