

Pairing

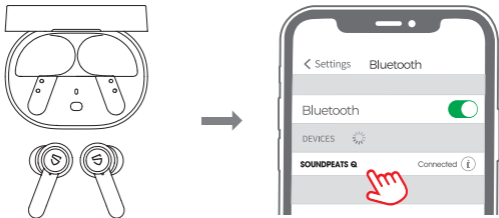

1. Open up the case lid while the case is with enough power left and make sure the earbuds are in the charging case, the left and right earbuds will pair to each other automatically with a prompt suggests successfully connected. Then pls press and hold the button of the charging case for 3S until the indicator of the charging case starts to flash and the earbuds prompt "Pairing", then the earbuds enter pairing mode.
2. Activate the Bluetooth on your device and hit "SOUNDPEATS Q" on the bluetooth list to connect. The earbuds will prompt "Connected" after connecting successfully.

Factory Reset

1. Clear the pairing record between the earbuds and all your devices.
2. Place back both earbuds into the charging case and open up the case lid. Press and hold the charging case button for 10s.



Wearing

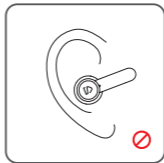

Product Diagram

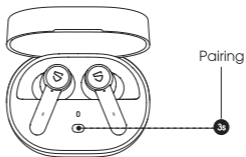
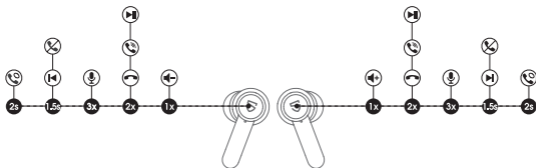

Button Control

| | |
|-----------------------------|--|
| Power On | Auto: Open up the case lid Manually: Press and hold the MFB for 1.5s |
| Power Off | Auto: Place back the earbuds into charging case and close the lid Manually: Press and hold the MFB for 10s |
| Play / Pause | Double tap the MFB |
| Volume - | Single tap the left MFB |
| Volume + | Single tap the right MFB |
| Previous Track | Press and hold left MFB for 1.5s |
| Next Track | Press and hold right MFB for 1.5s |
| Answer / Hang Up Phone Call | Double tap the MFB |
| Reject Phone Call | Press and hold the MFB for 1.5s |
| Switch Between Two Calls | Press and hold the MFB for 2s |
| Manually Enter Pairing Mode | Place back the earbuds into the charging case and open the lid, Press and hold the charging case button for 3s |
| Activate Voice Assistant | Triple tap MFB on right earbud |

Q1: What do the charging LEDs tell while charging the case?

The charging indicators will turn to red when the battery of the case is low, please charge the case then.

Method 1:

1. Use a Type-C adapter to charge the case (current not over 1A).
2. Please charge the earbuds and case at least once per 3 months when not in use for a long time.

Method 2:

1. Place the charging case directly above the wireless charger.
2. Please charge the earbuds and case at least once per 3 months when not in use for a long time.

When opening up the casing lid, the indicator of the charging case will light up for 10s to show the current battery status of the charging case:

- 100%—50% Shows Green
- 49%-10% Shows Yellow
- Below 10% Shows Red

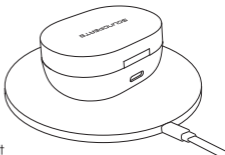

When charging the charging case, the indicator will flash slowly:

- Below 20% The indicator flashes in red slowly
- 20%-69% The indicator flashes in yellow slowly
- 70%-99% The indicator flashes in green slowly
- 100% The indicator stays on green



Q2: Why are the earbuds still connected to my phone after placing back?

1. The charging case is out of battery. The case will not turn off the earbuds if the case battery is dead.
2. Please make sure the earbuds sit well in the charging case, and the charging contactors on both the earbuds and the pin needle are clean. If not, please try something like microfiber cloth to clean the contactors.

Q3: The battery life is not as advertised?

A single charge will not give you 21 hours playtime constantly. The earbuds work around 7 hours per charge with average use. The charging case provides another 2 recharges.

FCC Statement

This equipment has been tested and found to comply with the limits for a Class B digital device, pursuant to Part 15 of the FCC rules. These limits are designed to provide reasonable protection against harmful interference in a residential installation. This equipment generates uses and can radiate radio frequency energy and, if not installed and used in accordance with the instructions, may cause harmful interference to radio communications. However, there is no guarantee that interference will not occur in a particular installation. If this equipment does cause harmful interference to radio or television reception, which can be determined by turning the equipment off and on, the user is encouraged to try to correct the interference by one or more of the following measures:

- Reorient or relocate the receiving antenna.
- Increase the separation between the equipment and receiver.
- Connect the equipment into an outlet on a circuit different from that to which the receiver is connected.
- Consult the dealer or an experienced radio/TV technician for help.

This device complies with part 15 of the FCC rules. Operation is subject to the following two conditions:

- (1) This device may not cause harmful interference.
- (2) this device must accept any interference received, including interference that may cause undesired operation.

Changes or modifications not expressly approved by the party responsible for compliance could void the user's authority to operate the equipment.