

TANK M1

Start your journey with Kospet.

Please charge the watch for more than 30 minutes to ensure that the watch has sufficient power for the first use.



Power Button:

- 1.Long Press: Power on/Power off.
- 2.Short Press :Toggle display on/off.

Back Button:

- 1.Long Press : Power on/Enter Sports mode.
- 2.Short Press : Enter Menu/ Return to primary screen.

※Note: Short Press = 1 second. Long Press 3 seconds or more.

Content

Please read this User Guide carefully before you start to use the devices.

1. Shortcut Gestures	3
2. Pair the Watch with Phone	5
3. Settings in DaFit APP	10
4. Charging Tips	11
5. Configuration	12
6. Safe Usage Tips	13
7. Troubleshooting	14
8. Contact Us	16

1. Shortcut Gestures

1) Swipe Down: Enter the Quick Settings Center.



2) Swipe Up: Enter the Message Box.



User Manual

3) Swipe Left: Enter the following functions.



Sleep



Measure HR

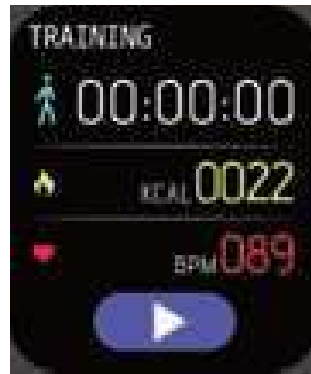

Training



Measure BP



Spo2



Weather

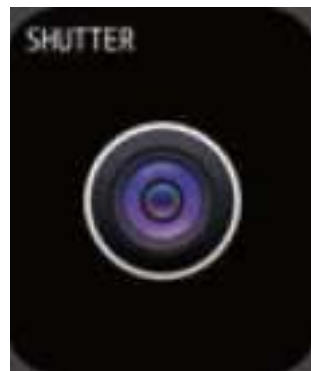

Shutter

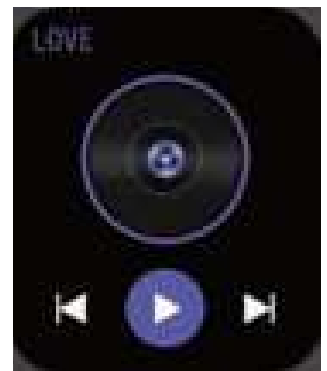

PLAYER

User Manual

4) Swipe Right: Enter the Sub Menu to access Weather, Sleep, Shutter, Message, Heart Rate and Blood Oxygen.



2. Pair the Watch with Phone

1) Download Da Fit APP

a. Scan the QR code with your phone to download the Da Fit App.



App QR code



Da Fit

User Manual

b. You can also find the QR code in Settings
Swipe down on the watch display > select “” setting.



Scroll down and Choose APP QR code.



c. Or search Da Fit in the Apple App Store or Google Play Store.



Apple App Store



Google Play Store



2) Pairing as followed instructions

Turn on the phone's Bluetooth and start Da Fit on the phone.



User Manual

Give permissions and complete profile settings.

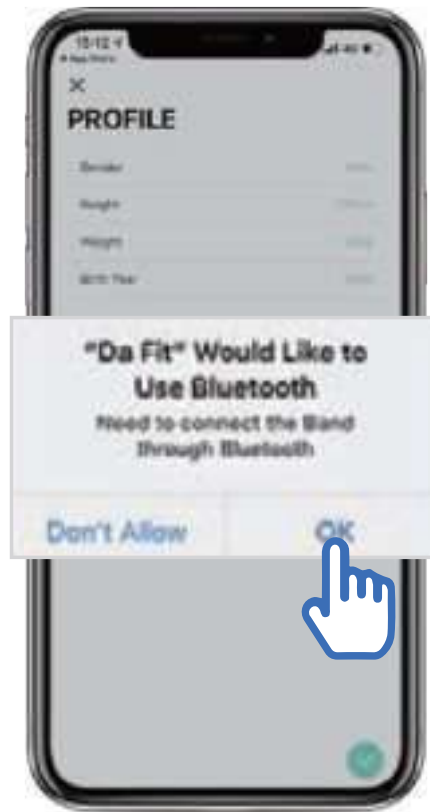

Add a Device > select TANK M1.

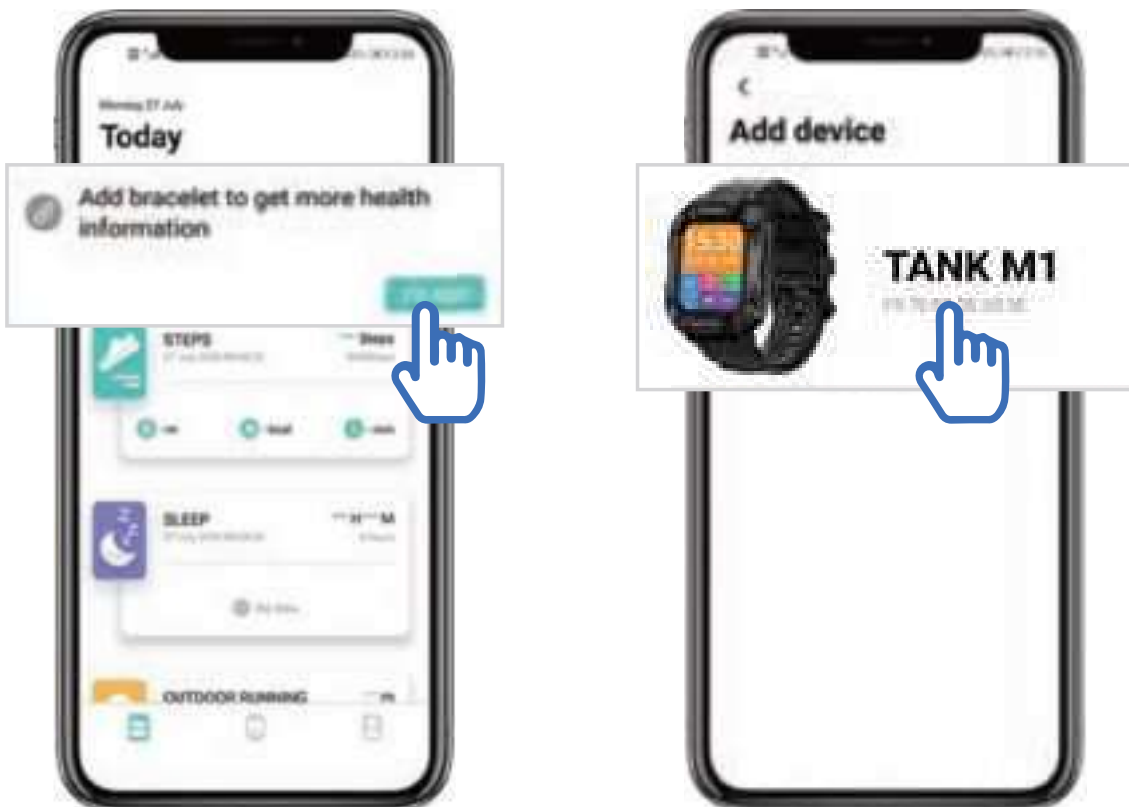

User Manual

Pair and give Da Fit access.

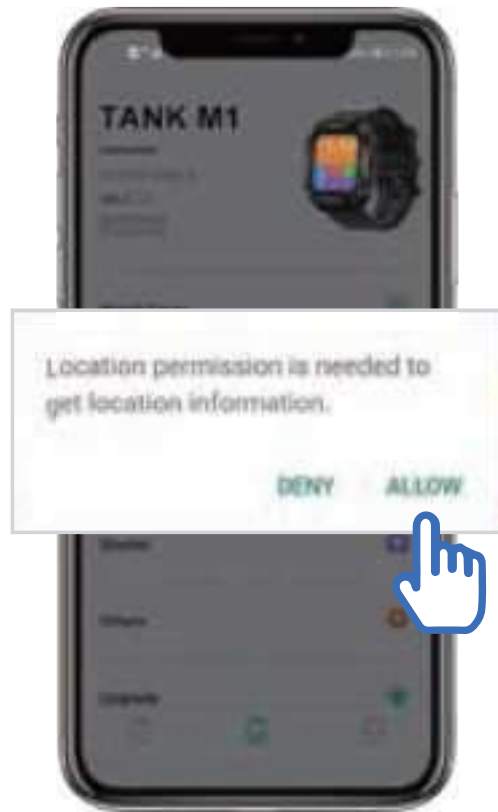
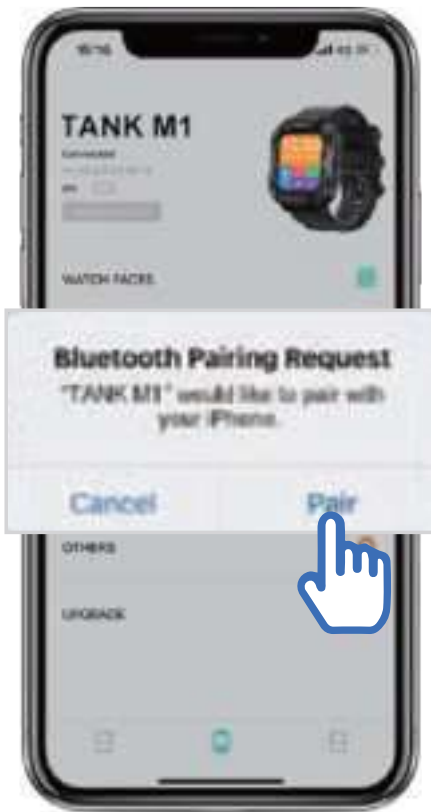

Successful connected.

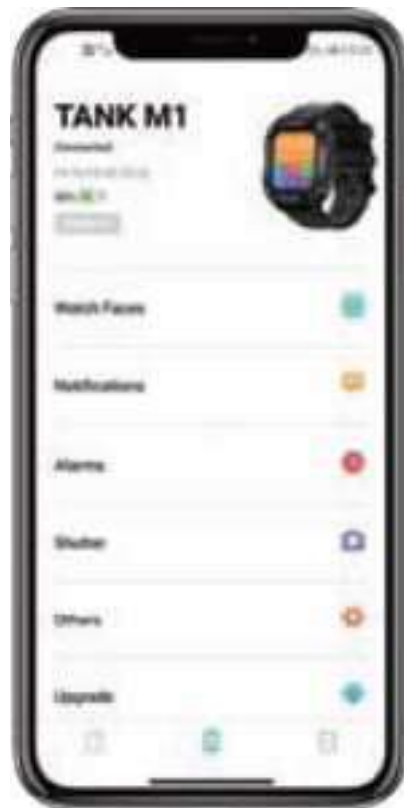

3. Settings in DaFit APP

Start DaFit > click icon.

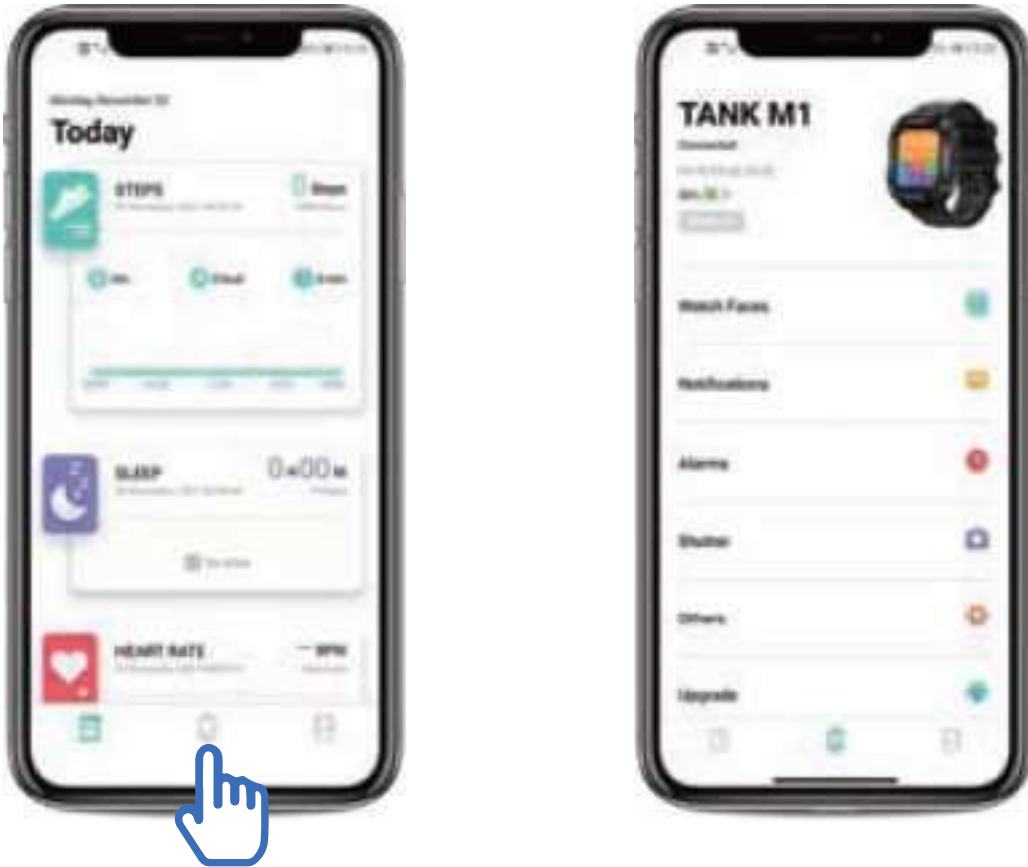

WATCH FACES

Discover more dials or Edit Dial 5 to add pictures from your album and re-positioning the text blocks on the display.

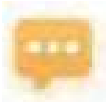

NOTIFICATIONS

Turn on or off notifications for calls, messages, and other third-party applications.



ALARMS

Set alarm reminders.



SHUTTER

Use the watch to control the phone to take pictures.



OTHERS

Find Device, Time Format, Reminders to Move, Full-day Heart Rate, Do Not Disturb, Language, Unit Form, Auto Lock, Quick View, Drink Water Reminder, Weather, Cycle Reminder.



UPGRADE

Firmware Upgrade of the watch through Da Fit (when new firmware is pushed).

REMOVE

Remove Device

Disconnect the Bluetooth on the phone.

4. Charging Tips

- It is recommended that you choose a charger with an output voltage / current of 5V / 500mA.
- The data cable uses a magnetic connector. Keep the watch away from metal conductors during charging, otherwise there will be a risk of fire.



5. Configuration

Model	KOSPET TANK M1
CPU	RealTek8762DK
Body Material	Metal + Plastic
Strap	Silicon
Display	1.72" TFT 280*320 pixels
System Support	Above Android 6.0 or ios 9.0
Assistant App	Da Fit
Touch Screen	Capacitive touch screen
Battery	380mAh Lithium polymer battery
Sports Mode	Built-in 20+ sports modes
Water Proof	5ATM & IP69K
Language Supported	English(default), German, Korean, Spanish, Japanese, French, Russian, Arabic, Ukrainian, Portuguese, Italian, Turkish, Romanian
Bluetooth	Bluetooth 5.0
Vibrate	Support
G-sensor	Support
Heart Rare Monitor	Support
Pedometer	Support
Sleep Monitor	Support
Blood Oxygen	Support
Blood Pressure	Support (The test data has no reference value)
Sedentary Remind	Support (Setting via Da Fit APP)
Message Reminder	Support (Setting via Da Fit APP)

6. Safe Usage Tips

To ensure the best performance of the device, please read and follow all the safety information carefully before using it.

1) Keep a certain distance away from where the electronic products are regulated. Such as gas stations, chemical plants, and other public places. Please observe the relevant regulations and follow the directions.

2) Consult for professionals if you're using medical devices. The radio waves generated by this device may affect implantable or personal medical devices. Please consult the medical device manufacturer for the conditions of using these devices and follow their directions.

3) Keep the device off while you are flying. Radio waves generated by electronic devices may interfere with the safe flight of the aircraft. Please follow the airline's requirements.

4) Extreme temperature may damage the device and cause malfunctions. Temperature condition for normal work: 0 ~ 45°C; temperature condition for storage: -20°C ~ +55°C.

5) Do not expose the device to extremely high-temperature environments, like scorching sun rays, or around high-temperature devices like heaters, ovens, microwave ovens, or water heaters. It may cause battery explosions or other safety accidents.

6) Non-professionals are not allowed to disassemble the device and battery. This device uses a non-removable lithium-polymer battery. Improper disassemble may cause battery explosions or other safety accidents.

7) Please use original accessories and safety certified charger to charge 1-2 hours before using this product.

8) Please keep the charging device away from other metal objects. The magnet attraction between the charging device and other metal objects might result in a short circuit fire or other accidents.

9) Values are for reference only (the heart rate, blood pressure, or other health-related). This product is not a medical device and cannot be used as a clinical basis.

7. Troubleshooting

1) The watch won't turn on?

- a. Charge the watch for more than 30 minutes with original accessories.
- b. Charge the watch for more than 30 minutes with a new set of cables or charger.

2) The watch cannot be connected to your phone?

- a. Make sure to download and install the right Da Fit App on your phone, and give all permissions to it.
- b. Make sure that the mobile phone's Bluetooth is turned on.
- c. Restart the phone and watch separately.
- d. Try to uninstall and re-install the Da Fit application, clear all connected Bluetooth devices, and then connect the watch again as steps in the manual.
- e. Reset the watch to factory settings.

Swipe down > select “  ” > confirm factory reset.

3) Inaccurate step counting and movement distance?

- a. Complete your profile in Da Fit App including your height, age, weight, and other information.
 - b. Reset the watch to factory settings before testing.
- Note: 5%-10% inaccuracy is acceptable due to the environment / motion / algorithm changes.

4) The watch won't get synchronized messages from the mobile phone?

- a. Make sure that all permissions are allowed to Da Fit while installing.
 - b. Open "APP Notification Reminder" in Da Fit.
 - c. Turn on notification permissions for the Da Fit on your phone.
 - d. Try to connect with another phone to see if the same problem occurs.
- If yes, please report your phone model to us, we will give you a solution as soon as possible.

5) Fast battery drains?

Recommend Settings to save battery:

- a. Reduce the screen brightness and change the watch Auto-Lock to 5S.
- b. Turn off the automatic heart rate detection and the 24-hour heart rate detection.
- c. Turn off unnecessary notifications and reminders on Da Fit.

6) Watch operation system upgrade?

- a. For Android watch: Upgrade in Watch Settings > About watch > Wireless update, check the latest firmware and update.
- b. For Bluetooth watch: Upgrade in Da Fit APP
Enter Da Fit > UPGRADE > scroll down to the bottom > select Firmware upgrade.

7) Bluetooth won't turn on on the watch?

Bluetooth turned on once the pairing was completed. There is no need to turn on Bluetooth on the devices manually.

8) No vibration when new messages come in?

- a. Make sure that you didn't turn on Theater Mode.
- b. Make sure that you turned on Vibrate Mode in the watch.

8. Contact Us

If this guide is not helpful, please feel free to contact us at the following contact information:

Email: after-sales@kospet.com

Forum: <https://www.kospet.com/a/community>

FB groups: fb.com/groups/kospetfriends



Official Store



Facebook Group

Provide us with the following information to resolve your issue as soon as possible:

Order Platform:

Order Number:

Email:

Issue Description: (It's better if you can provide us with a video.)

Federal Communications Commission (FCC) Statement. This device complies with part 15 of the FCC Rules. Operation is subject to the following two conditions:

- (1) This device may not cause harmful interference, and
- (2) this device must accept any interference received,

including interference that may cause undesired operation. Note: This equipment has been tested and found to comply with the limits for a Class B digital device, pursuant to part 15 of the FCC Rules. These limits are designed to provide Reasonable protection against harmful interference in a residential installation. This equipment generates, uses and can radiate radio frequency energy and, if not installed and used in accordance with the instructions, may cause harmful interference to radio communications. However, there is no guarantee that interference will not occur in a particular installation. If this equipment does cause harmful interference to radio or television reception, which can be determined by turning the equipment off and on, the user is encouraged to try to correct the interference by one or more of the following measures:

- Reorient or relocate the receiving antenna.
- Increase the separation between the equipment and receiver.
- Connect the equipment into an outlet on a circuit different from that to which the receiver is connected.
- Consult the dealer or an experienced radio/TV technician for help.

Warning: Changes or modifications made to this device not expressly approved by Shenzhen Kospet Technology Company Limited may void the FCC authorization to operate this device. Note: The manufacturer is not responsible for any radio or TV interference caused by unauthorized modifications to this equipment. Such modifications could void the user's authority to operate the equipment.

RF exposure statement:

The transmitter must not be colocated or operated in conjunction with any other antenna or transmitter. This equipment complies with the FCC RF radiation exposure limits set forth for an uncontrolled environment. The installation and use of this product are not restricted.