

How do I pair my Jabra Elite 45e with my mobile device?

Jabra Elite 45e - Titanium Black

To pair your Jabra Elite 45e with your smartphone, tablet, or other mobile device, follow these steps.

1. Turn on the Bluetooth setting on your mobile device.
2. Turn the headphones off by pressing and holding (3 seconds) the **Multi-function** button.
3. To enter pairing mode, press and hold (3 seconds) the **Multi-function** button until the LED flashes blue.

If you are wearing the headphones, pairing mode will be announced. The headphones are now ready to pair with your mobile device.

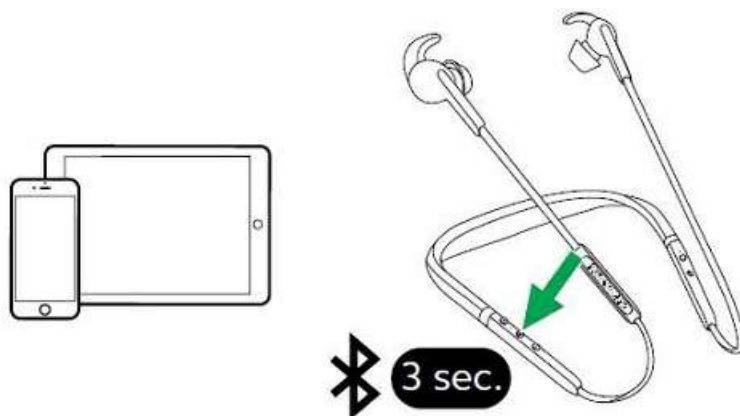

4. To pair, go to the Bluetooth menu on your mobile device and select the Jabra Elite 45e from the list of available devices. Alternatively, wear the headphones to hear the pairing instructions. Enter “0000” (four zeros) if you are asked for a PIN.

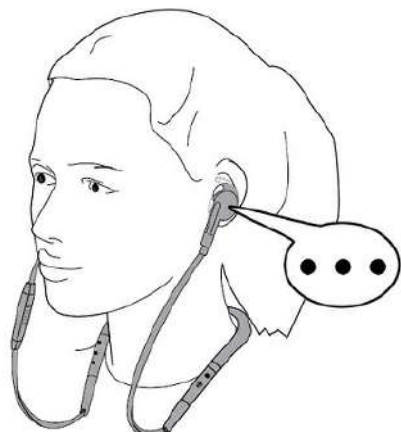
**Note**

If pairing is not successful, try the pairing steps again, or try pairing with a different Bluetooth device. For troubleshooting tips, [see here](#).

Optionally, try using the [Bluetooth Pairing Guide](#) which provides detailed steps for pairing with a mobile device.