

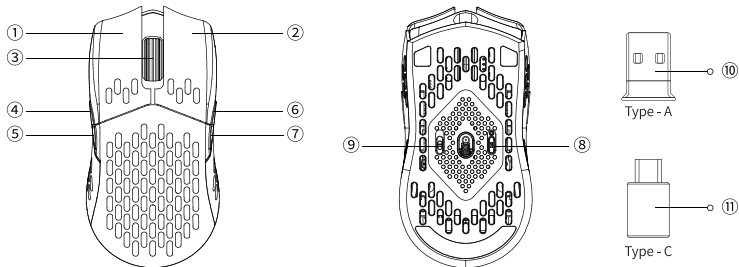

M1 WIRELESS MOUSE USER MANUAL



- ① Left button ② Right button ③ Middle wheel button ④ Left forward button ⑤ Left backward button
⑥ Right forward button ⑦ Right backward button ⑧ DPI button ⑨ Modes toggle ⑩ 2.4GHz Type - A receiver
⑪ 2.4GHz Type - C receiver

3 Modes of connection

Wired Mode:

1. When the mode switch is in "OFF" position, the mouse won't respond if the cable is not connected.
 2. Connect the cable to the TYPE-C port of the mouse and the USB port on the device. The mouse is ready to use while the backlit lights up.
- * When connected by cable, the mode will default to wired mode even if the toggle is in Bluetooth mode or 2.4GHz mode.

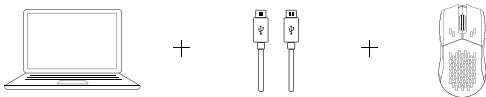

2.4GHz Mode:

1. Switch to "G" mode (2.4GHz mode), and the mouse will automatically turn on 2.4GHz pairing. The RGB light on the side of the mouse wheel will slowly flash green.
2. Find the 2.4GHz receiver and connect it to the device's USB/Type-C port. Once successfully connected, the RGB light on the side of the mouse wheel will turn green and stay on for 3 seconds, then dims off. The RGB backlit will be resumed to its previous light effects when successfully connected.

3. In 2.4GHz pairing mode, the RGB light on the side of the mouse wheel will slowly blink green for 3 minutes. If it's not connected within 3 minutes, the RGB light on the side of the mouse wheel will turn off. If you need to reconnect, hold both the "Left button + Left forward button" for 4 seconds to re-enter pairing mode.
- * If you need to repair the connection in 2.4GHz mode, please unplug the 2.4GHz receiver first. Then, hold both the "Left button + Left forward button" for 4 seconds, wait for the green light indicator to start flashing, and plug the 2.4GHz receiver back in to complete the pairing process.

Note: It is recommended that when pairing the M1 in 2.4GHz mode, the mouse should be within 20cm of the receiver.

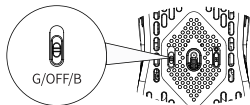

G = 2.4GHz mode

+

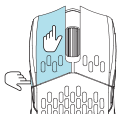

simultaneously hold for 4 seconds
(to enter the forced pairing mode)

Note: For the best wireless experience, we recommend using the cable and putting the 2.4GHz receiver somewhere on your desk close to your mouse for a lower rate of latency and fewer signal interferences.

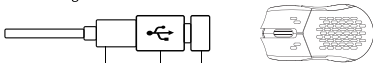

Type-C Cable Adapter 2.4GHz
Receiver

Bluetooth mode

1. Switch to "B" Mode (Bluetooth), and the mouse will automatically turn on Bluetooth pairing mode. The RGB light on the side of the mouse wheel will slowly flash blue.
2. Open the Bluetooth settings, search for a device named "Keychron M1", then click "connect" to complete pairing.
3. When in Bluetooth pairing mode, the RGB light on the side of the wheel will slowly blink in blue for 3 minutes. If it's not connected within 3 minutes, the RGB light on the side of the mouse wheel will turn off. If you need to reconnect, you need to hold the "Left button + Left forward button" for 4 seconds to re-enter pairing mode. The mode indicator will slowly blink blue.
4. If the M1 is in Bluetooth mode and needs to pair with a new device, hold both the "Left button + Left forward button" for 4 seconds and wait for the blue light to flash on. At this point, Bluetooth has re-entered pairing mode, and you can connect the new device to the M1.

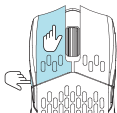
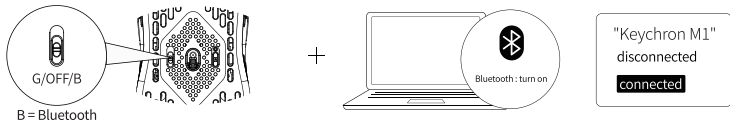

simultaneously hold for 4 seconds
(to re-enter pairing mode)

Status indicator

2.4GHz Mode	When the indicator on the side of the mouse wheel: *Slowly blinks green - Ready to be paired. *Quickly blinks green - Pairing with the previous device.
Bluetooth Mode	When the indicator on the side of the mouse wheel: *Slowly blinks blue - Ready to be paired. *Quickly blinks blue - Pairing with the previous device.
Low power	The indicator on the side of the mouse wheel will slowly flash red.

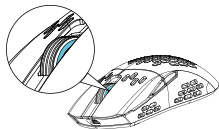

DPI indicator

White light	400 DPI	Yellow light	3200 DPI
Green light	800 DPI	Red light	5000 DPI
Blue light	1600 DPI (default)		

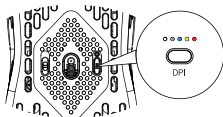

Report Rate indicator

*Report Rate = Polling Rate

Holding both the "Middle wheel button + Right forward / backward button" changes the report rate to the previous / next level, it doesn't support one-way cyclic changing.

White light	125hz (Default in Bluetooth mode)
Green light	500hz
Red light	1000hz (Default in wired & 2.4GHz mode)

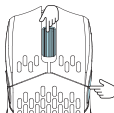

How to change the light effect

Holding both the "Middle wheel button + Left forward / backward button" changes the light effect to the previous / next mode.

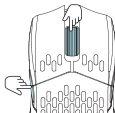

How to factory reset

Hold down the "DPI button" for 5 seconds, and all the LED lights on the mouse will blink red. It will blink three times to indicate that the factory reset is successful.

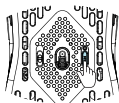

hold for 5 seconds
(starts factory reset)

Auto-Sleep mode

Auto-Sleep mode will not be activated when in wired mode. When in 2.4GHz mode or Bluetooth mode, all LED lights on the mouse will be turned off after 1 minute of sitting idle (the M1 mouse will still be connected to the device), the mouse will go to auto-sleep mode after 15 minutes of sitting idle to save the battery (the M1 mouse will be disconnected from the device). Move or click the mouse to wake it up.

Driver Software

The Keychron M1 mouse driver can be downloaded from www.keychron.com. If the driver software can't connect to the mouse, please contact us for technical support.

Charging indicator explanation

Fully charged	The RGB backlit on the side of the mouse wheel will light up GREEN for 30s and then resume its previous light effects.
Low Power	The RGB backlit on the side of the mouse wheel will slowly blink RED.

- * The mouse is compatible with all USB ports. For the best signal and charging speed, connecting to the USB3.0 port is recommended when charging or in use.
- * The mouse can be charged in 2.4GHz mode, Bluetooth mode and wired mode.
- * If the mouse is connected by the USB Type - C cable when charging but not paired with any devices:
 - The RGB backlit on the side of the mouse wheel will light up RED for 10s, then dim off when charging.
 - The RGB backlit on the side of the mouse wheel will light up GREEN for 30s, then dim off when fully charged.

Note: The product supports up to 5V charging voltage and 300 mA charging current. We are not responsible for any problems caused by improper recharging.

What's in the box

Mouse x 1	USB Type - C receiver x 1	Extension Adapter x 1	User manual x 1
USB Type - C to Type - C cable x 1	USB Type - A receiver x 1	USB Type - A to USB - C adapter x 1	

Mouse specification

Size: 130*66*38mm

Weight: 79 ± 3g

Report Rate(polling rate): 125(White) - 500(Green) - 1000(Red)

Sensor: PixArt 3395

Resolution: 100 - 26000DPI

Mouse micro switches: Kailh GM8.0 (80 million clicks life time)

2.4GHz / Bluetooth connection range: Approx 10m of open space

Battery capacity: 600mAh

Usage duration: 70 Hours (wireless without RGB lights),
15 Hours (wireless with RGB lights)

Recharge time: About 2.5 Hours

Charging port: USB Type - C

Connection mode: 2.4GHz - Bluetooth - Wired

Device name: Keychron M1

Keychron, Inc.

Dover, DE 19901, United States

Find us at:

<https://www.keychron.com>

Support@keychron.com

 @keychron

 @keychron

 @keychronMK

Designed by Keychron

Made in China



M1无线鼠标使用说明

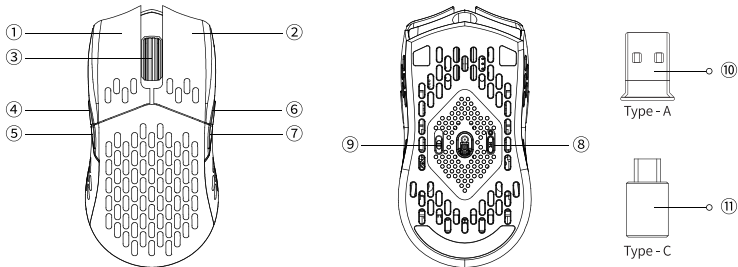

① 左键

② 右键

③ 中键滚轮

④ 左前进键

⑤ 左后退键

⑥ 右前进键

⑦ 右后退键

⑧ DPI按钮

⑨ 模式拨片

⑩ 2.4G Type - A接收器

⑪ 2.4G Type - C接收器

三模连接方式

有线模式：

- 1、在OFF档位下，如果没有连接数据线，鼠标无任何反应。
 - 2、将数据线连接至鼠标Type-C接口以及设备USB接口，鼠标灯光亮起即可使用。
- * 即使模式开关是在蓝牙或者2.4G的档位下，当数据线连接上设备后，鼠标将默认为有线模式使用。

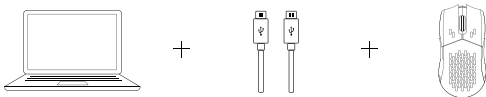

2.4G模式：

- 1、将鼠标底部开关拨动到“G”模式档位（2.4G模式）。鼠标自动进入2.4G配对模式，滚轮侧边的RGB灯光绿灯慢闪。
- 2、将鼠标2.4G接收器连接至设备端的USB/Type-C接口，连接成功后，滚轮侧边的RGB灯光绿灯常亮3秒后熄灭，鼠标RGB恢复之前的灯效模式。

3、在2.4G模式下，滚轮侧边的RGB灯光绿灯将会慢闪并持续三分钟，如果没有在三分钟内进行连接使用，滚轮侧边的RGB灯光熄灭。

如需重新配对，可以同时长按鼠标左键+左前进键4秒，重新进入匹配状态。

* 如果需要重新进行2.4G模式的连接，首先请拔出2.4G接收器。然后同时长按鼠标左键+左前进键4秒，等待指示灯绿灯开始闪烁，之后重新插入2.4G接收器完成配对操作。

注意：进行2.4G模式强制配对时，建议鼠标与接收器的距离不超过20cm。

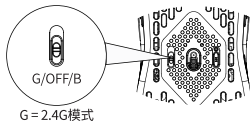

+



同时保持4秒
(进入强制配对模式)

注意：为了获得最佳的无线体验，我们建议将2.4G接收器插入线材+赠送的转接头，放置在书桌上靠近你的鼠标，以降低延迟率和更少的干扰信号。

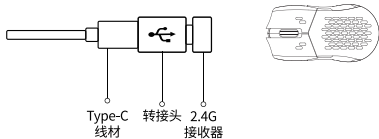

蓝牙模式

- 1、将鼠标底部开关拨动到“B”模式档位(蓝牙模式)。鼠标自动进入蓝牙配对模式,滚轮侧边的RGB灯光蓝灯慢闪。
- 2、此时打开设备蓝牙设置,搜索设备:Keychron M1,点击连接即可使用。
- 3、拨动到蓝牙模式下,滚轮侧边的RGB灯光蓝灯将会慢闪并持续三分钟,如果没有在三分钟内进行连接使用,滚轮侧边的RGB灯光熄灭。
如需重新配对,可以同时长按鼠标左键+左前进键4秒,即可重新进入配对模式,模式指示灯蓝灯持续慢闪。
- 4、如果M1鼠标在蓝牙模式下需要与其他新设备进行连接,可以同时长按鼠标左键+左前进键4秒,滚轮侧边的RGB灯光将会蓝灯慢闪,即可重新进入鼠标蓝牙配对状态。此时您可以让新设备与M1进行连接。

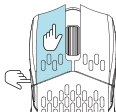
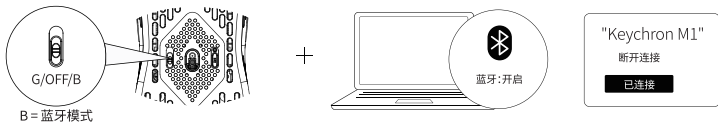

同时保持4秒
(重新进入配对模式)

功能指示灯说明

2.4G模式	滚轮侧边指示灯(绿灯)慢闪-配对 滚轮侧边指示灯(绿灯)快闪-回连
蓝牙模式	滚轮侧边指示灯(蓝灯)慢闪-配对 滚轮侧边指示灯(蓝灯)快闪-回连
低电状态	滚轮侧边指示灯(红灯)慢闪

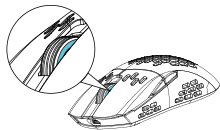

DPI 指示灯

白灯	400 DPI	黄灯	3200 DPI
绿灯	800 DPI	红灯	5000 DPI
蓝灯	1600 DPI(默认)		

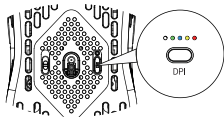

回报率指示灯

按住“滚轮+右前进/后退按钮”可以将回报率切换到上一档/下一档，它不支持单向循环切换。

白灯	125hz(蓝牙模式默认)
绿灯	500hz
红灯	1000hz(有线、2.4G默认)

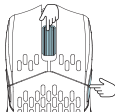

改变背光灯效

长按“滚轮+左前进/后退按钮”切换到上一个/下一个灯效模式。

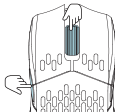

恢复出厂模式

长按DPI按钮5秒，鼠标整体LED灯红光闪烁，闪烁三次代表恢复出厂设置成功。

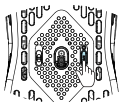

长按5秒
(开始恢复出厂设置)

休眠模式

有线模式下无休眠状态，2.4G模式(游戏模式/办公模式)下，鼠标无操作一分钟后RGB灯效关闭，此时鼠标仍与设备连接。

鼠标无操作15分钟后自动进入休眠状态，移动或者点击操作即可唤醒鼠标。

驱动程序

可以在www.keychron.com下载Keychron M1鼠标驱动，如驱动程序无法连接鼠标，请联系我们提供技术支持。

充电指示灯说明

电量充满时	滚轮侧边RGB灯光绿灯常亮30秒, 30秒后恢复原本的灯效模式
低电量时	滚轮侧边RGB灯光红灯慢闪

*鼠标与所有USB端口兼容, 如需获得最佳信号以及充电速度, 建议连接USB3.0端口进行充电和使用。

*鼠标可以在2.4G模式、蓝牙模式下使用时, 进行充电操作。

*鼠标若无连接状态下连接USB Type-C线材充电,
充电中: 鼠标滚轮侧边RGB灯光红灯常亮10秒后熄灭,
充满时: 鼠标滚轮侧边RGB灯光绿灯常亮30秒后熄灭。

注意: 本产品最高支持5V充电电压, 300 ma充电电流。因不当充电而导致的问题, 概不负责。

内容清单

鼠标 x 1	USB Type - C 接收器 x 1	接收器延长器 x 1	说明书 x 1
USB Type - C to Type - C 线材 x 1	USB Type - A 接收器 x 1	USB Type - A to USB - C 转接头 x 1	

鼠标规格

尺寸: 130*66*38mm

重量: 79±3g

回报率: 125hz (白灯)-500hz (绿灯)-1000hz (红灯)

传感器: 原相3395

分辨率: 100-26000DPI

微动开关: 凯华GM8.0 (8000万次)

2.4G / 蓝牙模式工作距离: 开放环境下约10米

电池容量: 600mAh

续航: 70小时 (无线模式下关闭RGB灯效);
15小时 (无线模式下开启RGB灯效)

充电时间: 约2.5小时

充电端口: USB Type-C

使用模式: 2.4G-蓝牙-有线

设备名称: Keychron M1

Keychron, Inc.
Dover, DE 19901, United States

<https://www.keychron.com>

通过以下方式与我们联系

Support@keychron.com

 @keychron

 @keychron

 @keychronMK

Keychron设计

中国制造

中国区总代：渴创技术（深圳）有限公司

执行标准：GB 4349.1-2022

售后热线：400-0766268

地 址：深圳市龙岗区坂田街道大发埔社区
大发路24号文坑工业区2栋201