



1

FR - CHARGER

EN - CHARGE

DE - AUFLADEN

NL - OPLADEN

ES - CARGAR

IT - CARICARE

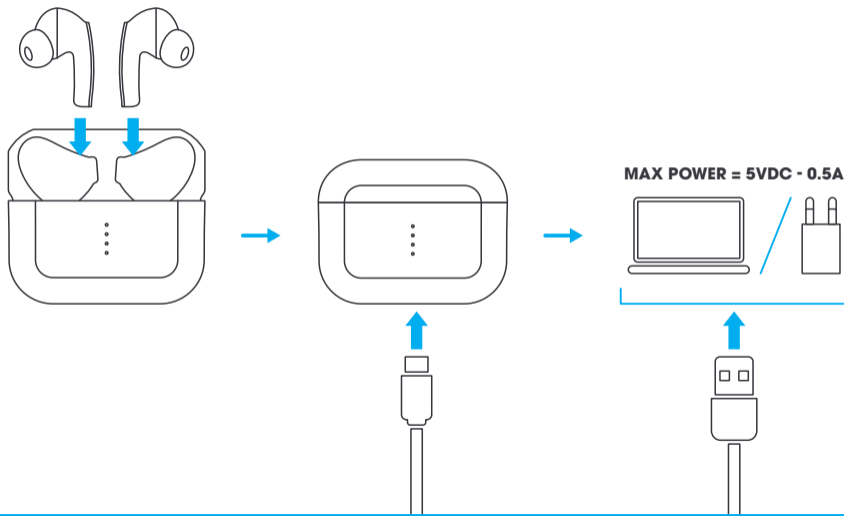

EARPHONES

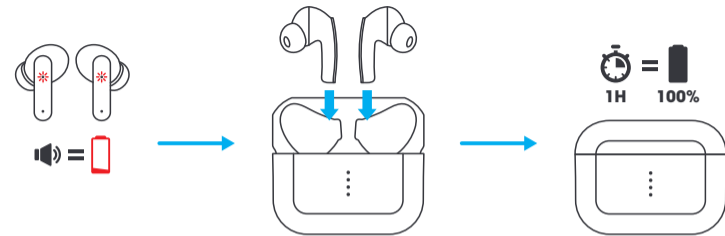

CASE

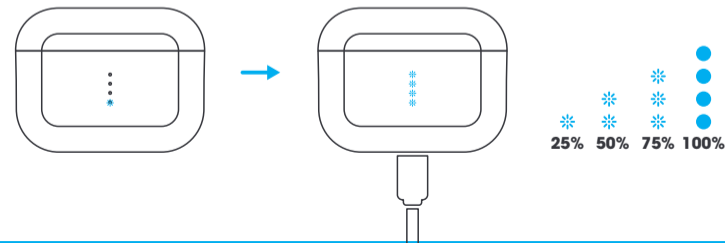

LED STATUS

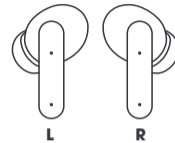

● ● ON

* * OFF

* PAIRING

● ● CONNECTED

* * DISCONNECTED

* * RESET



2

FR - JUMELER

EN - PAIR

DE - PAAREN

NL - KOPPELEN

ES - SINCRONIZAR

IT - ACCOPPIARE

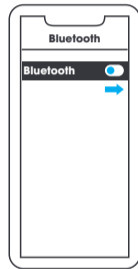
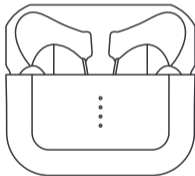
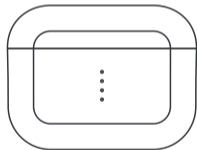



3

FR - POSITIONNER

EN - POSITION

DE - STELLEN

NL - POSITIONEREN

ES - POSICIONAR

IT - POSIZIONARE

1



INSÉRER
INSERT
EINSETZEN
INZETTEN
INSERTAR
INSERIRE

2



TOURNER
TURN
DREHEN
DRAAIEN
GIRAR
GIRARE



4

FR - UTILISER

EN - HOW TO USE

DE - VERWENDEN

NL - GEBRUIKEN

ES - UTILIZAR

IT - USARE

CONTROLS

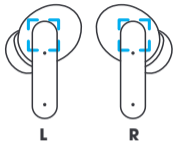

- TOUCH ZONE
- TOUCH 1x
- TOUCH 2x
- TOUCH 3x
- TOUCH 2s
- TOUCH 3s
- TOUCH 5s
- TOUCH 10s

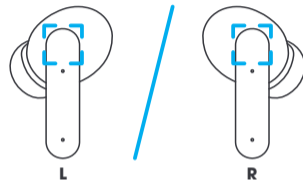
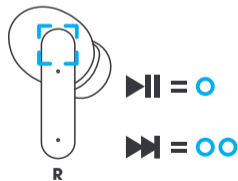
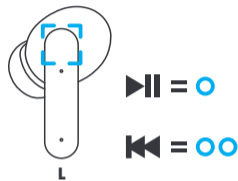

ON METHOD 1

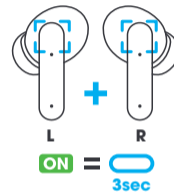

ON METHOD 2

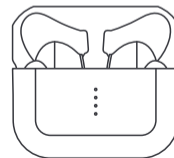

OFF METHOD 1

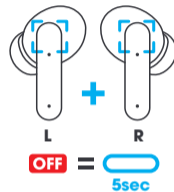

OFF METHOD 2

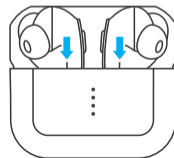



5

FR - ATTENTION

EN - WARNING

DE - WARNUNG

NL - WAARSCHUWING

ES - ADVERTENCIA

IT - AVERTENZA

FR. Écouter de la musique avec un volume élevé peut gravement nuire à l'audition.

EN. Listening at high volume levels for long periods can lead to permanent hearing defects.

DE. Das Hören mit Kopfhörern bei sehr hohen Lautstärken, vor allem über längere Zeit, kann Gehörschäden verursachen.

NL. Het langdurig luisteren naar muziek op hoog volume kan schade aan het gehoor veroorzaken.

ES. Un volumen excesivo durante un periodo prolongado de tiempo puede causar años auditivos permanentes.

IT. L'esposizione prolungata a un volume elevato può provocare danni permanenti all'udito.

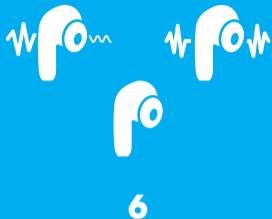

FR - ANC / TRANSPARENCE / NORMAL

EN - ANC / TRANSPARENCY / NORMAL

DE - ANC / TRANSPARENZ / NORMAL

NL - ANC / TRANSPARENCY / NORMAAL

ES - ANC / TRANSPARENCIA / NORMAL

IT - ANC / TRASPARENZA / NORMALE

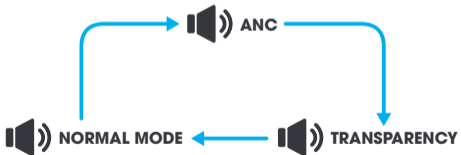
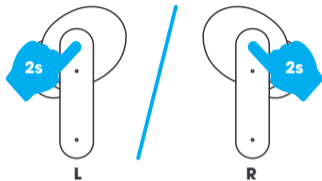



7

FR - EMBOUTS

EN - EAR TIPS

DE - OHRSTÖPSELN

NL - OORDOPJES

ES - PUNTAS

IT - PUNTALI



TAILLE/TURN: L



TAILLE/TURN: M



MÉMOIRE DE FORME
MEMORY FOAM



TAILLE/TURN: S

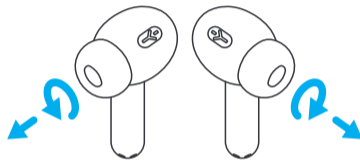

TOURNER & TIRER
TURN & PULL
DREHEN & ZIEHEN
DRAAIEN & TREKKEN
GIRAR & TIRAR
GIRARE & TIRARE

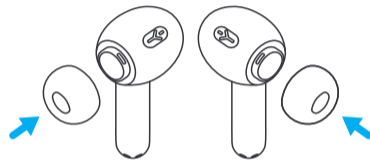

CLIPSER
CLIP
ANSCHNALLEN
KLEMMEN
ENCAJAR
FISSARE



8

FR - RÉINITIALISER

EN - RESET

DE - ZURÜCKSETZEN

NL - RESETTEN

ES - REINICIAR

IT - RESET



SUPPRIMER
DELETE
BESEITIGEN
VERWIJDEREN
SUPRIMIR
RIMUOVERE

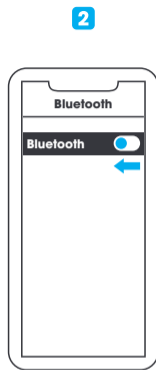

DÉSACTIVER
DISABLE
DEAKTIVIEREN
UITSCHAKELEN
DESACTIVAR
DISATTIVARE

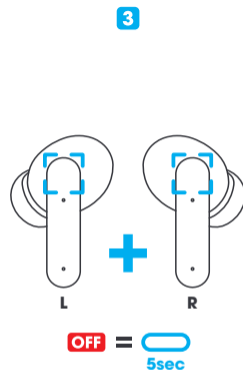

OFF = 5sec

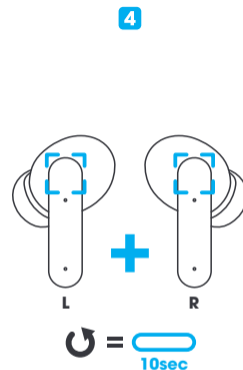

= 10sec

RÉINITIALISATION
FACTORY RESET
RÜCKSTELLUNG
RESET-FUNCTIE
REESTABLECIMIENTO
REIMPOSTAZIONE

